

If the centre of the neighbour's window lies on the extension side of both of the 45° lines (on plan and elevation), then the more detailed BRE tests are required. Otherwise, daylight and sunlight levels are unlikely to be adversely affected because light will continue to be received either over the roof, or beyond the end of the extension.

45 degree test

The 45° test is used to check extensions that are perpendicular to a window - as in the example below.

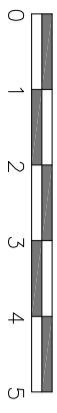
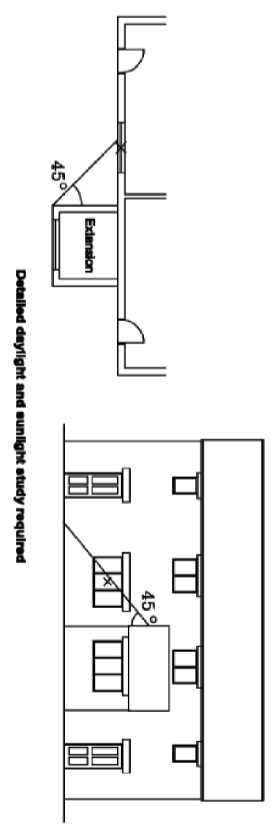

GROUND FLOOR PLAN
NO 11

GROUND FLOOR PLAN
NO 12

GROUND FLOOR PLAN
NO 13

DAYLIGHT AND SUNLIGHT ASSESSMENT

Drawings and calculations are to be approved by Building Control prior to the commencement of any work. No responsibility will be taken by the design team without the written approval by the Local Authority or an approved inspector.

TITLE

SURVEY DRAWINGS

ADDRESS

12 NASBEY CLOSE
LONDON, NW6 4EY

CLIENT

Mr. & Mrs. KENNEDY

SCALE

1:100 @ A3

DATE

OCT 2024

DRAWING NO. 241017/09 FPG

REV.

