

Existing Axonometric

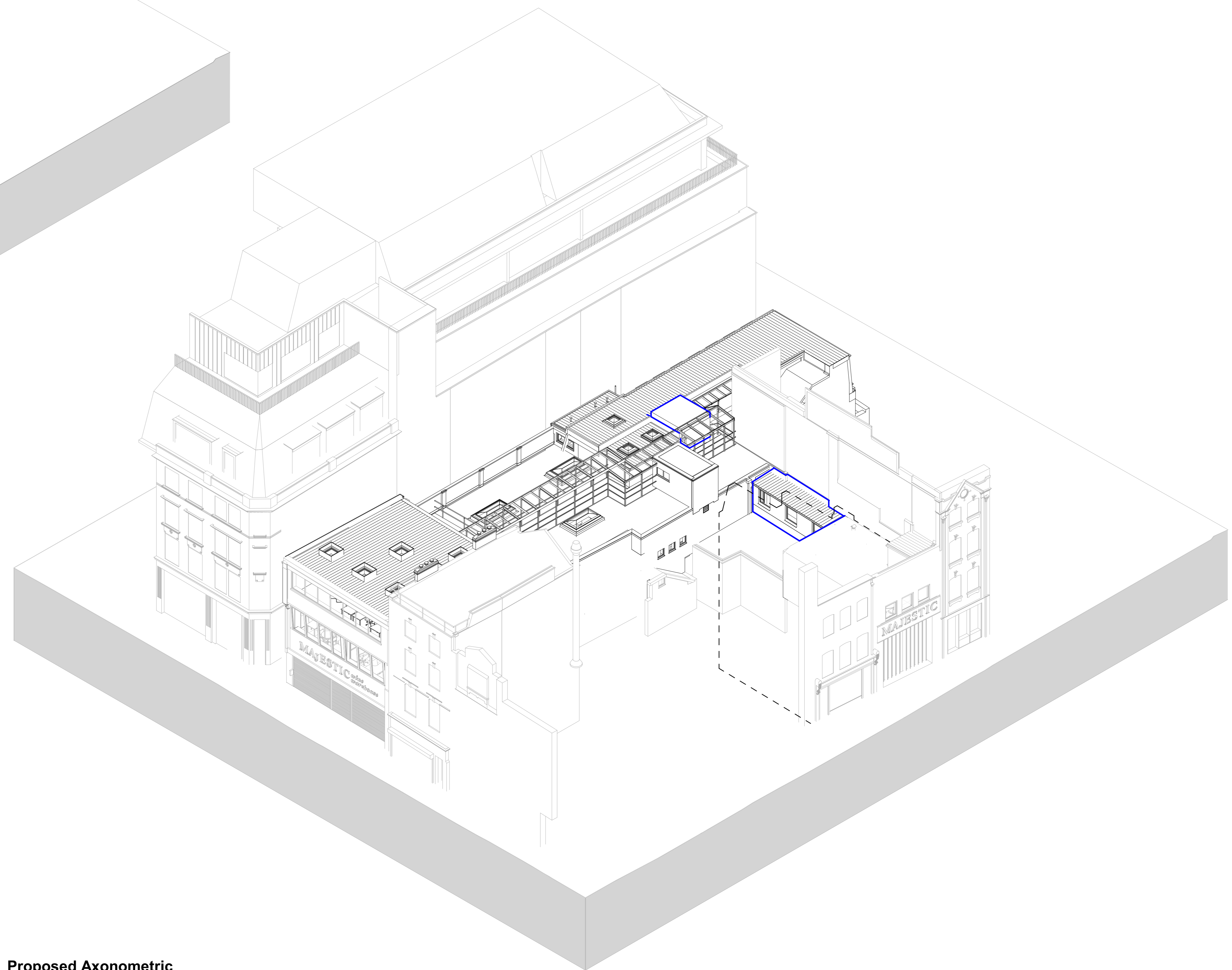

Proposed Axonometric

RIBA STAGE 0-3 : NOT FOR CONSTRUCTION
THIS DRAWING HAS BEEN PREPARED FOR PLANNING PURPOSES ONLY. THE DESIGN INFORMATION AND ANY INFORMATION HEREON ARE SUBJECT TO METASHAPE ARCHITECTS' DESIGN DEVELOPMENT, STATUTORY UNDERTAKINGS, PLANNING APPROVAL, MATERIALS AND CONSTRUCTION. METASHAPE ARCHITECTS LTD. DOES NOT APPLY FOR CONSTRUCTION OF LEGAL BOUNDARIES OR TITLE.
METASHAPE ARCHITECTS LTD. HAS DEVELOPED THE 3D REPRESENTATION OF METASHAPE ARCHITECTS LTD. AND IS NOT TO BE REPRODUCED WITHOUT PERMISSION. DO NOT SCALE THESE TO OTHER DIMENSIONS ONLY.

METASHAPE ARCHITECTS

PROJECT
2024-030-Shelton Street
24-25 Drury Lane, London, WC2B 5RJ

TITLE
Existing and Proposed 3Ds

SCALE @ A0 DATE 04/11/24

METASHAPE REF 2024-030 DRAWN JW REVIEWED IL

DOCUMENT NUMBER
2024-030-MET-Z1-OR-D-A-2510

DOCUMENT PURPOSE SUITABILITY REVISION
PLANNING S01 P01