

Existing Agar Place Elevation

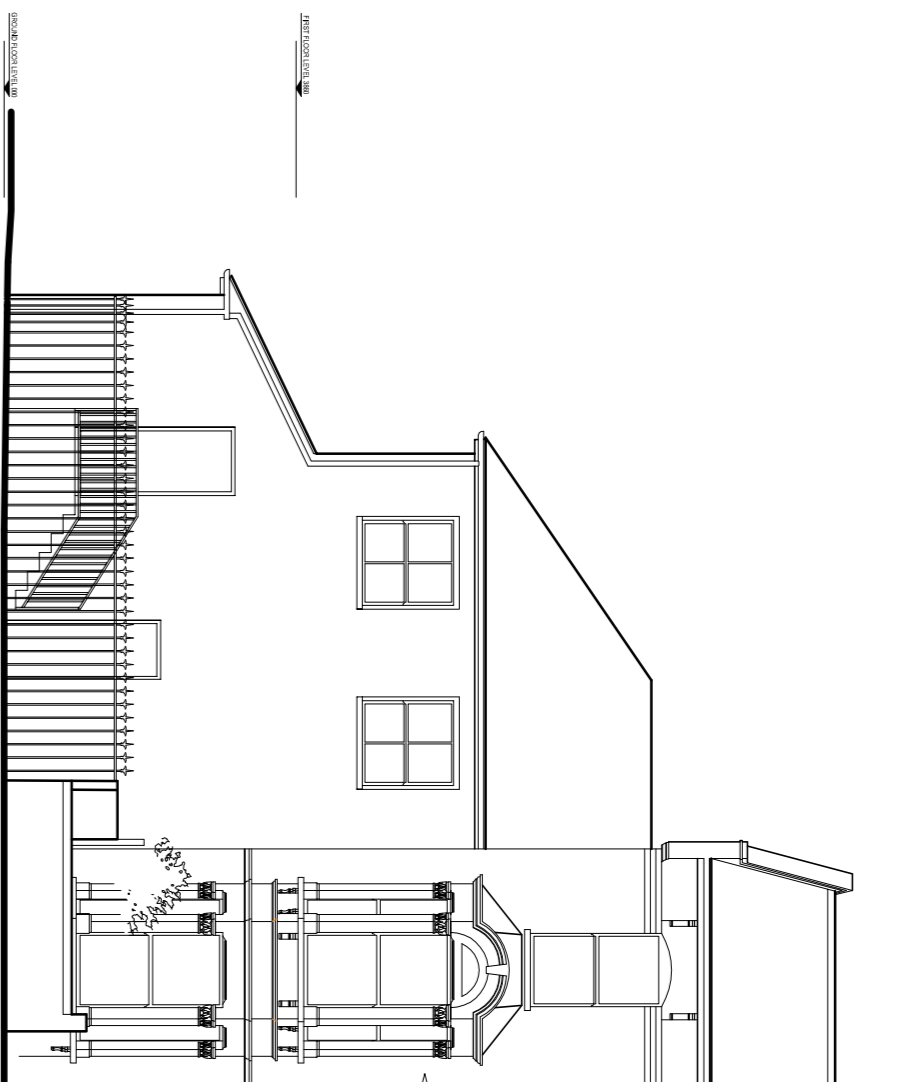

Existing Agar Grove Elevation

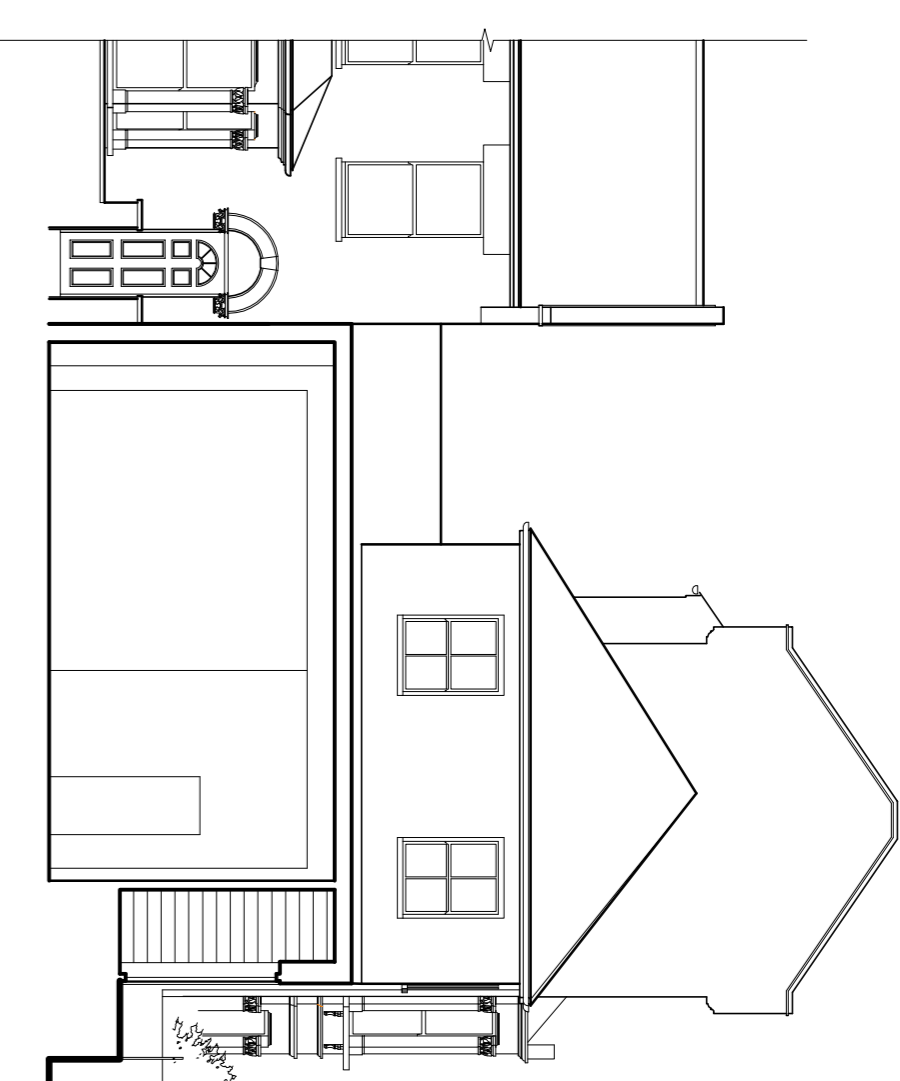

Existing Section A-A

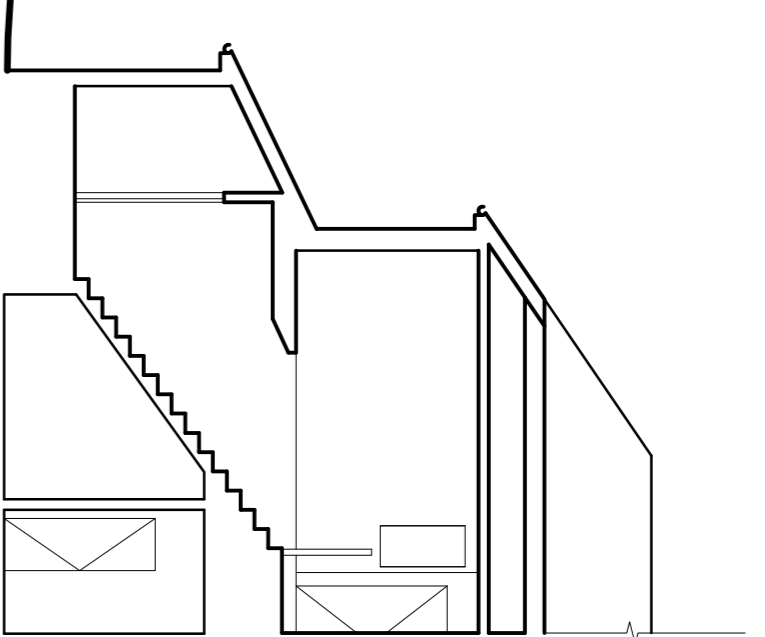

Existing Section B-B

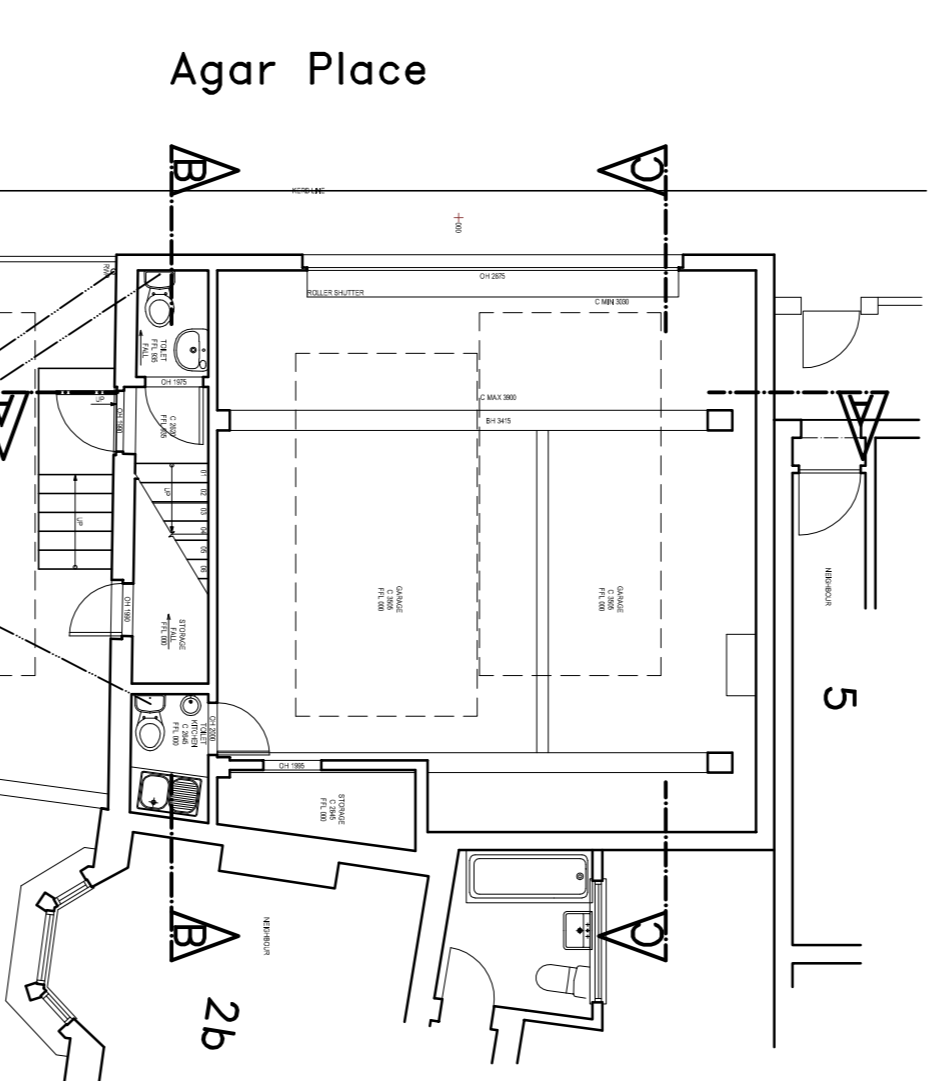

Agar Place

Existing Ground Floor Plan

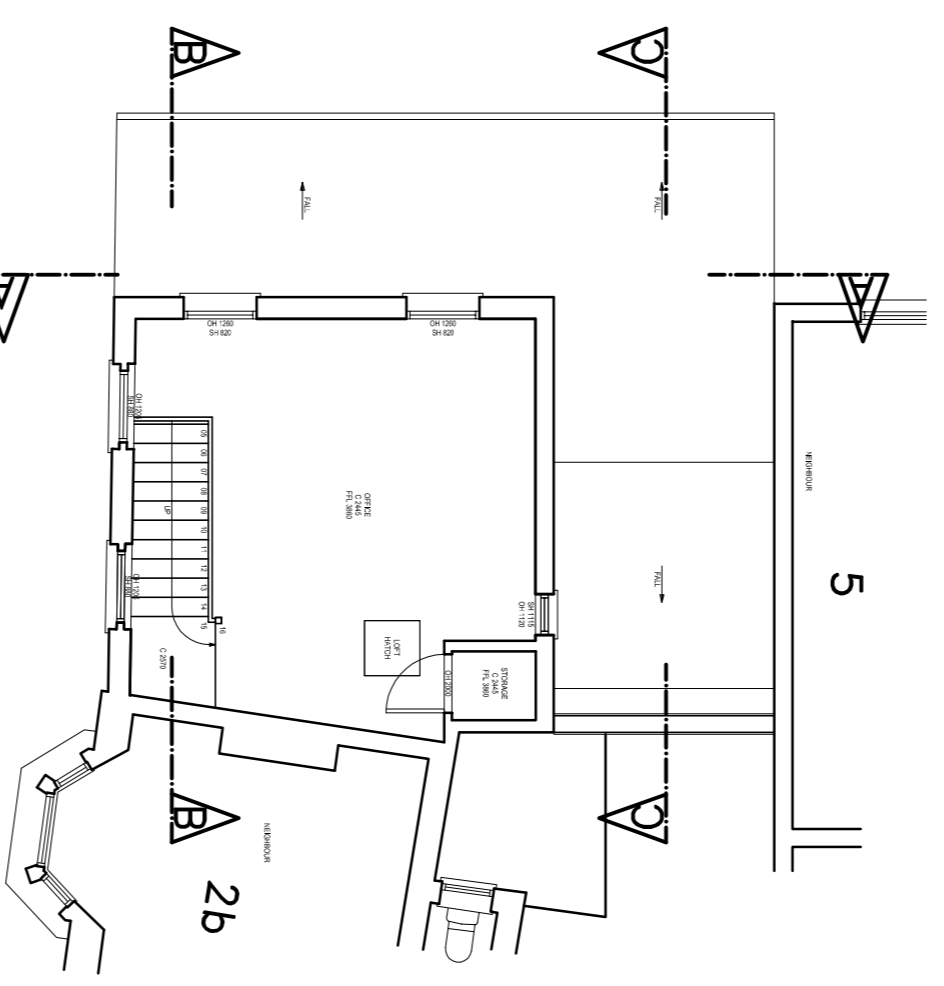

Existing First Floor Plan

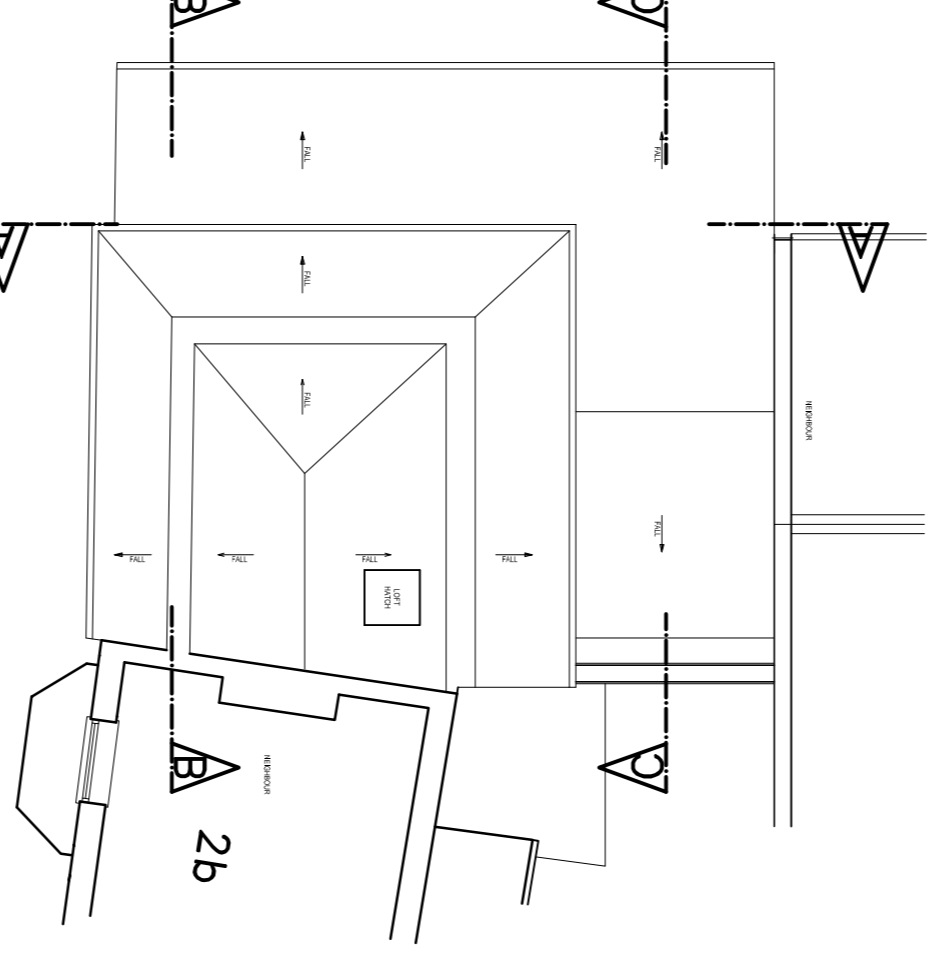

Existing Second Floor Plan

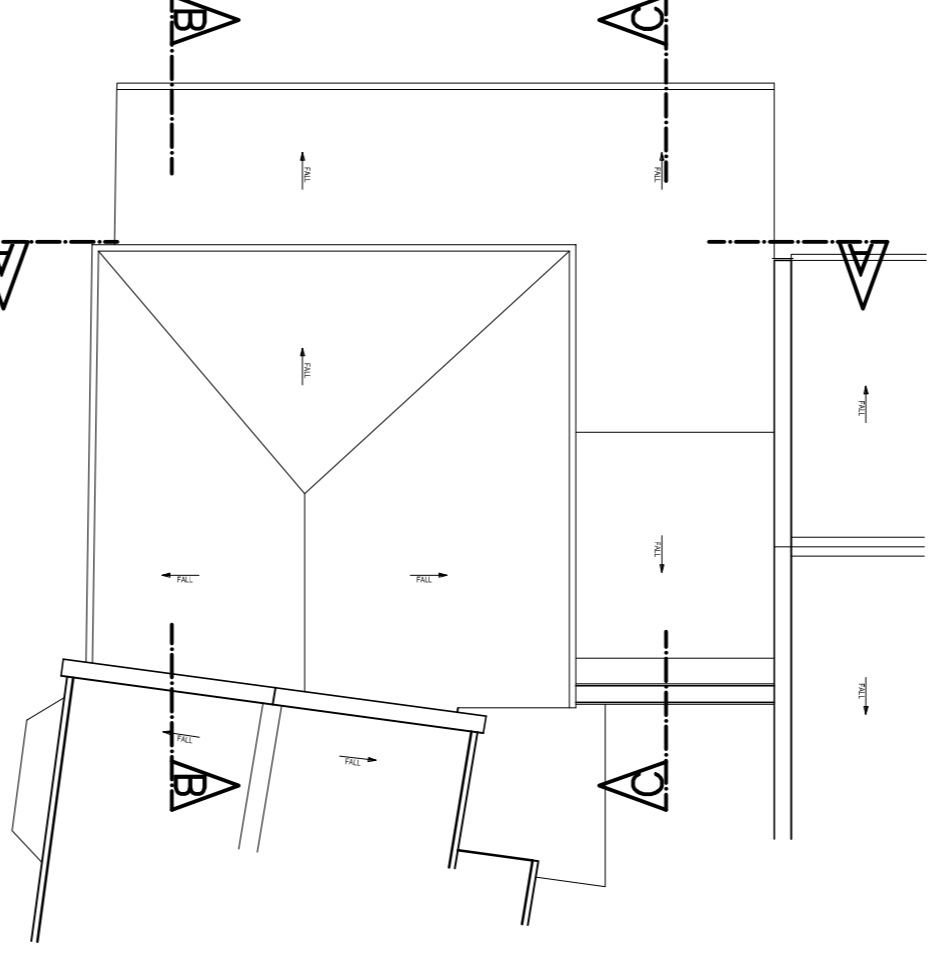

Existing Roof Plan

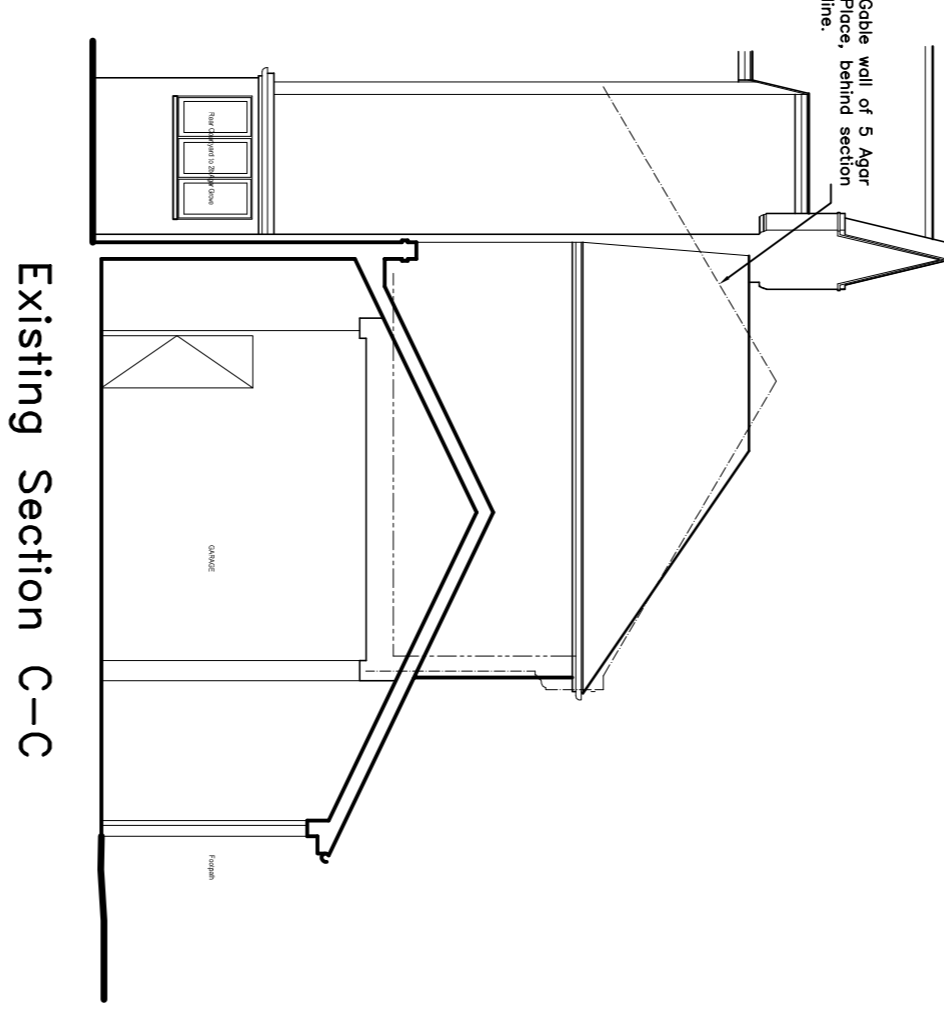

Existing Section C-C

Agar Grove

**Existing Materials.**

- Roof: Slate.
- Eaves and Gables: White fascia and soffits.
- Rainwater Goods: White Ogee upvc gutter and square down pipes.
- Walls: Multi yellow stock brickwork and partly cream painted render at upper level.
- Doors: Grey painted paneled door. Grey metal roller shutter door.
- Windows: Double glazed white upvc windows.
- Fences: 1500mm high black painted steel railings and gates to boundary.
- Drive: Paving slabs.

**KEY**  
 - - - - - Feature above on plan.  
 - - - - - Floor levels on elevations  
 - - - - - Combined water sewer/drain

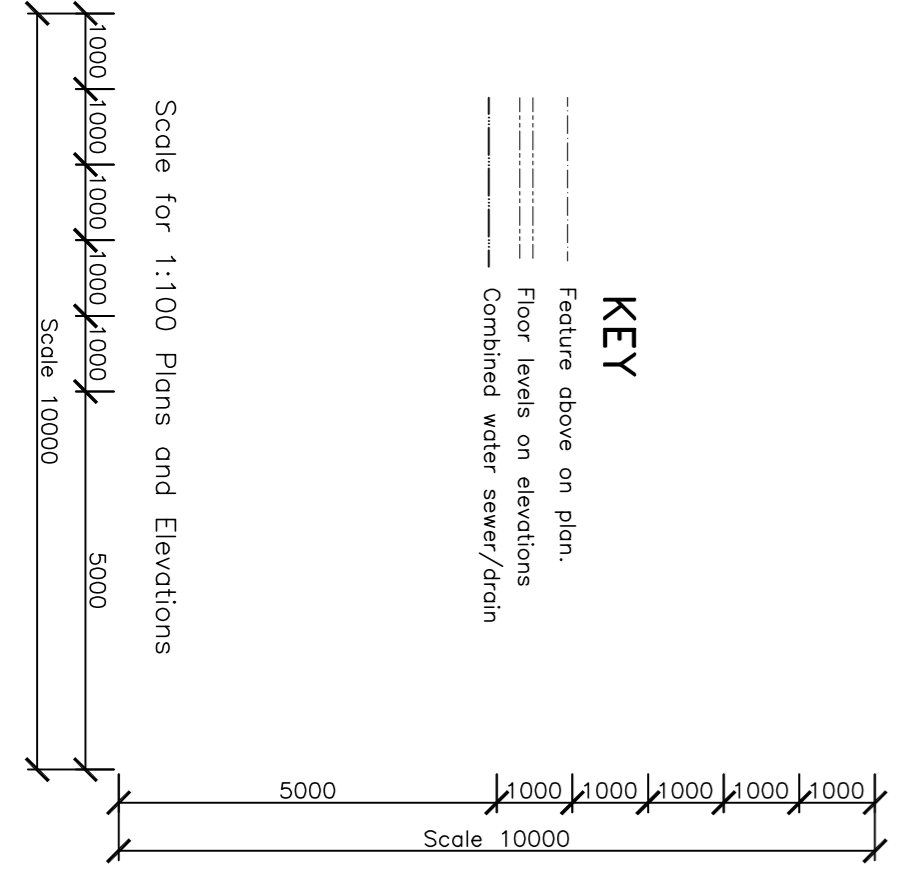

**Location Plan**  
 At a scale of 1:1250

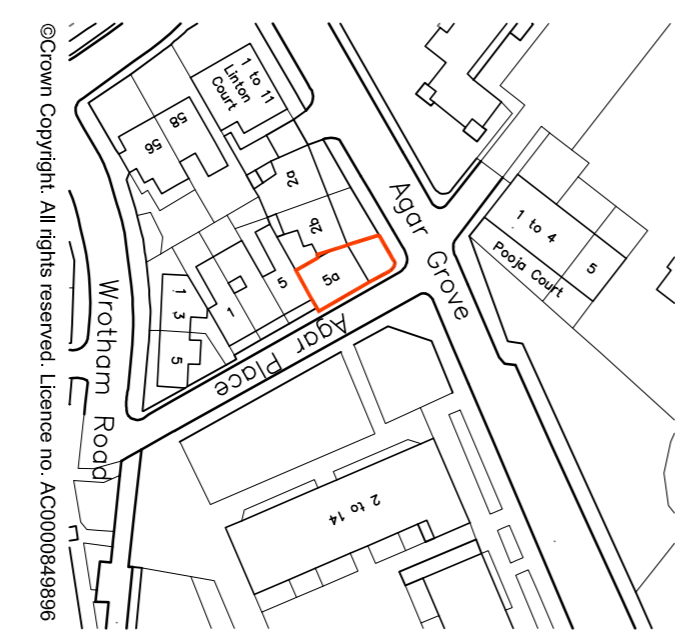

**Revisions**  
 A. 28.05.24 Bathroom of 2b reinstated.



Adrian Mitchell, Tel: 01992 533552, email: a.mitchell@ad.com  
 Stable House, 50 West Street, Herford, Herts, SG13 8EZ

Project		Proposed New Dwelling Over Altered Workshop at 5a Agar Place, Camden, London, NW1 0RG.	
Drawing Title	Number	Revision	
Existing Plans, Elevations and Sections and Site and Block Plans.	2232	E01	A
Date	Scale		
16.02.24	1:100, 1:500 and 1:1250 @ A1		
Drawn		AGM	