

**General Notes**

- All dimensions to be verified on site
- To be read in conjunction with all relevant documents
- In the event of discrepancy notify the Architect immediately
- Note that not all elements of the drawing may be to exact scale. All dimensions not explicitly marked should be verified either on site or with the Architect
- All steel structural elements to be finished with intumescent coating. 30 minutes fire resistance. For all structural elements and connection see SE drawings.
- This document is copyright of Hugh Cullum Architects Ltd

**Issue Status**

- SK Sketch	- T Tender	- P Permissions
- D Design	- E Existing Condition	- C Contract

Revisions				(drawn by/checked by)
rev	note		date	
(_)	: Issued for Planning		30.10.24	( TS/HC )

- Indicates existing structure
- Indicates proposed structure

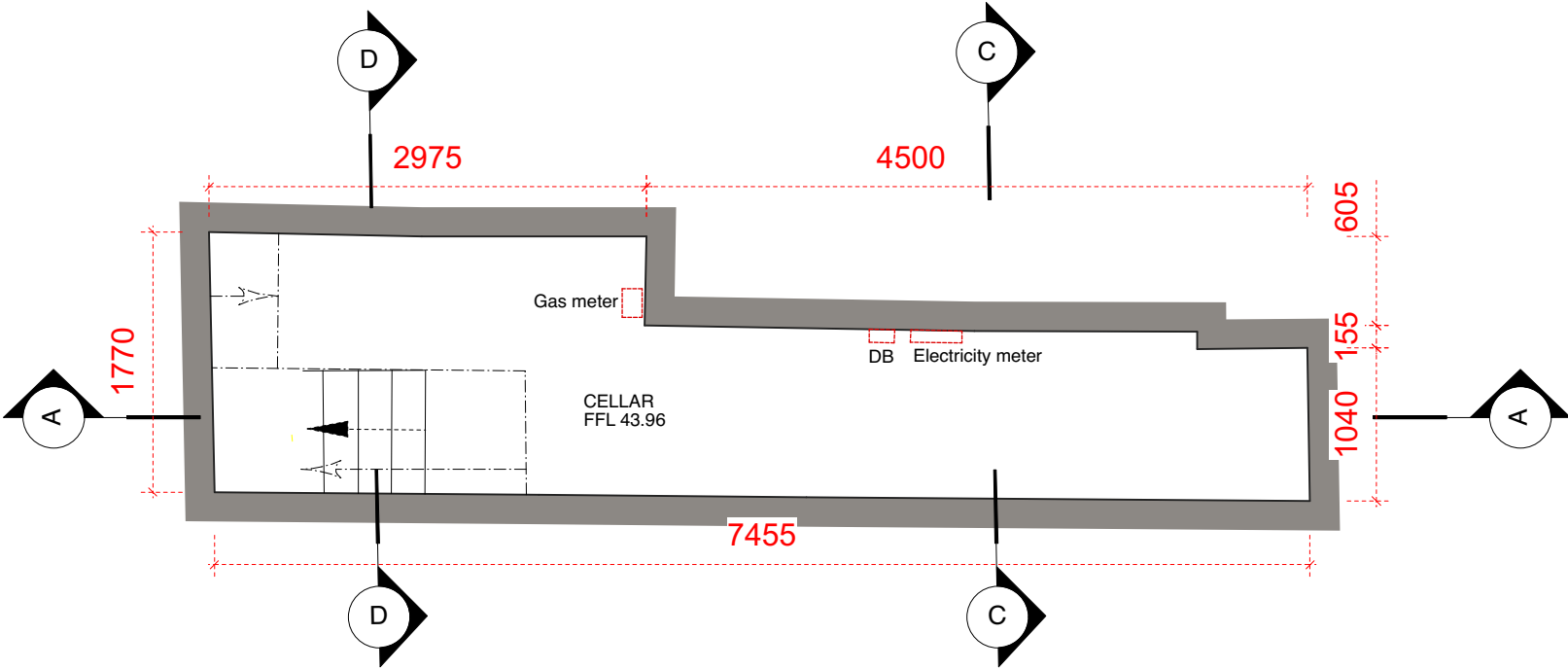

As Proposed - Basement Plan