

**NOTES**  
 Do not scale from this drawing. Only figured dimensions are to be taken from this drawing.  
 The contractor must verify all dimensions on site before commencing any work or shop drawings. The contractor must report any discrepancies to TAKENAKA EUROPE GMBH before commencing work. If this drawing exceeds the quantities taken in any way, TAKENAKA EUROPE GMBH is to be informed before the work is initiated.  
 COPYRIGHT © TAKENAKA EUROPE GMBH  
 This drawing is Copyright and must not be reproduced in any format or media without written/verbal consent of TAKENAKA EUROPE GMBH.

CDM Pre-Construction Information  
 The following information is provided in pursuance of Regulation 9 of the CDM Regulations 2015:

ALL DETAILS SHOWN REPRESENT THE MINIMUM INDICATIVE REQUIREMENT FOR THE DESIGN AND BUILD CONTRACT. THE INSTALLER IS RESPONSIBLE FOR ALL DETAILED DESIGN. THE DESIGNER SHALL BE RESPONSIBLE FOR DEVELOPING THE PRINCIPLES INDICATED IN TO A COMPLETE DESIGN AND FOR CO-ORDINATING WITH THE LATEST BUILDING ARRANGEMENTS. THE INSTALLER SHALL BE DEEMED TO HAVE INCLUDED WITHIN THEIR TENDER OFFER ALL NECESSARY PROVISION OVER AND ABOVE THE MINIMUM REQUIREMENTS INDICATED ON THE DRAWINGS AND WITHIN THE PERFORMANCE SPECIFICATION TO PROVIDE A COMPLETE AND FUNCTIONAL INSTALLATION.

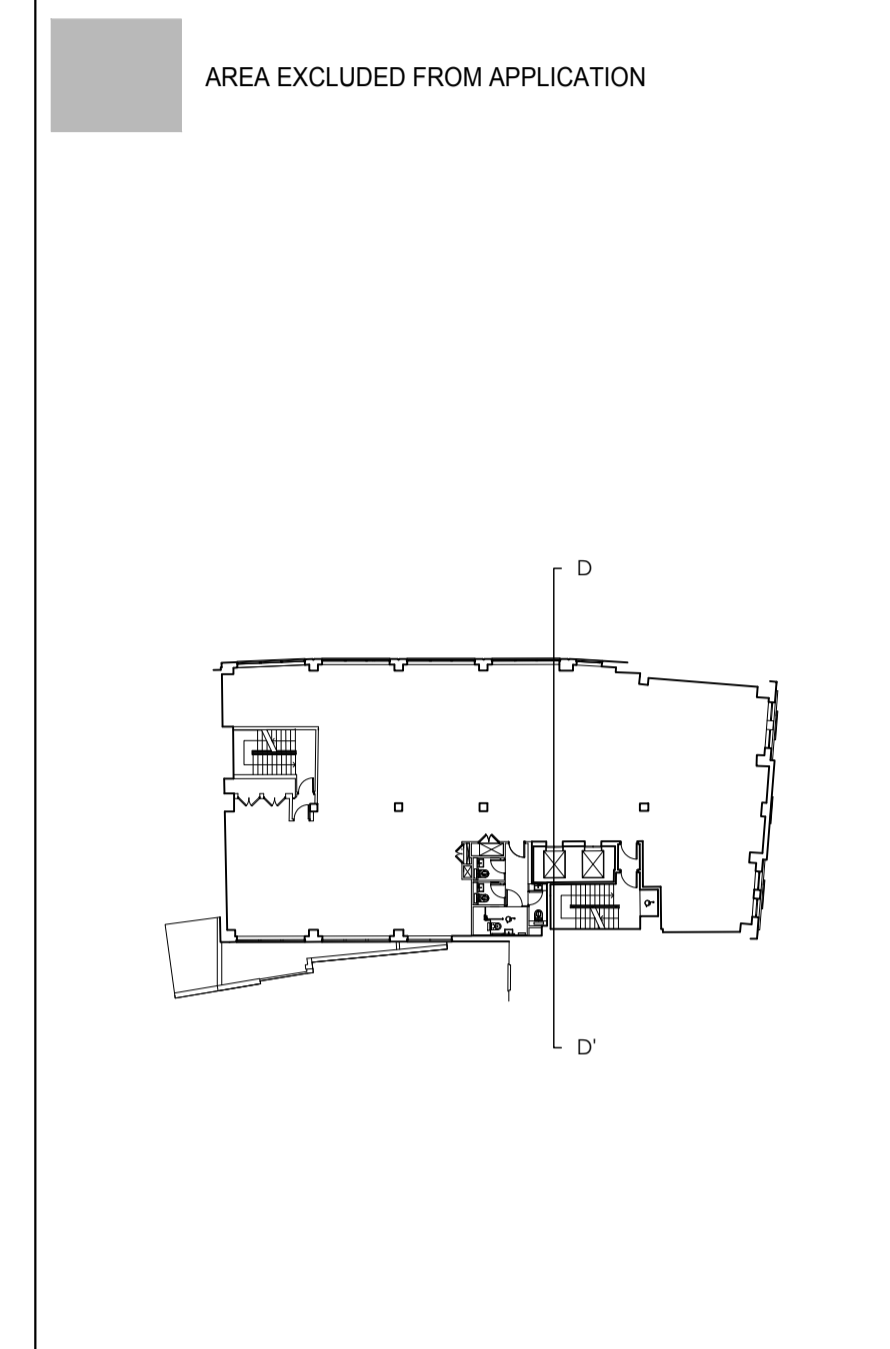

REV	date	description	prepared	checked
P00	15/07/24	ISSUE FOR PLANNING	CT	CT

REV	date	description	prepared	checked
P00	15/07/24	ISSUE FOR PLANNING	CT	CT

CONSULTANT  
**MOCT STUDIO**  
 info@moctstudio.com  
 www.moctstudio.com

**TAKENAKA**  
 TAKENAKA EUROPE GmbH  
 UK BRANCH LONDON OFFICE  
 4TH FLOOR, TAVISTOCK HOUSE NORTH,  
 TAVISTOCK SQUARE, LONDON WC1H 9HR  
 TEL: +44 (0)20 7255 4060 FAX: +44 (0)20 7383 7308

CLIENT  
**IINO KK LTD**  
 PROJECT NAME:  
 35 HIGH HOLBORN  
 ADDRESS:  
 35 HIGH HOLBORN LONDON WC1

TITLE:  
**PROPOSED SECTION DD**  
 STATUS:  
**PLANNING**

DATE: 22 FEB 2024	JOB NUMBER: IIN601	DRAWING SERIES: G200
SCALE: 1 TO 100 @ A1 1 TO 200 @ A3	DRAWN BY: MOCT	CHECK BY: CT
APPROVED BY: TAK		

DRAWING NO:  
**601-TAK-ZZ-XX-D-A-0734-S3-P00**

© All copyrights are reserved by TAKENAKA EUROPE GMBH

