

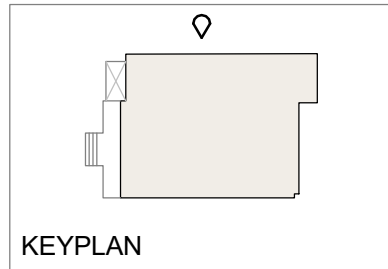

64 Avenue Road

**GENERAL NOTES:**  
 This drawing is copyright of KSR architects.  
 This drawing must be read in conjunction with the Designer's Risk Assessment, specification and all other relevant documentation and drawings. KSR architects accept no liability for any expense, loss or damage of whatsoever nature and however arising from any variation made to this drawing or in the execution of the work to which it relates which has not been referred to them and their approval obtained. Areas are based on unchecked survey and are approximate only. Do not scale from this drawing or the digital data, only figured dimensions are to be used.  
 Refer to linear scale for guidance. Check all dimensions on site prior to carrying out any works and advise any discrepancy



**ANNOTATION KEY**

	ASSUMED SITE BOUNDARY LINE
	EXISTING BUILDING LINE
	LINE OF BUILDING OVER
	LINE OF BASEMENT
	PRE APP OUTLINE- Pre-application meeting on 02/02/2024 with Mr Alan Wito - Camden Planning Design and Conservation Officer

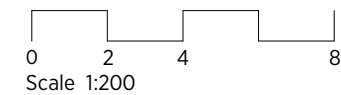

**KSR ARCHITECTS & INTERIOR DESIGNERS**  
 KSR Architects LLP | mail@ksrarchitects.com  
 14 Greenland Street | t: +44 (0)20 7692 5000  
 London NW1 0ND | www.ksrarchitects.com

**21037 - 64 AVENUE ROAD**

Proposed West Long Elevation

Date: 03/31/21      Status: Planning  
 Scale:      © KSR Architects  
 Drawing No:      Revision:  
 21037-P304