

Key Plan

---

Notes

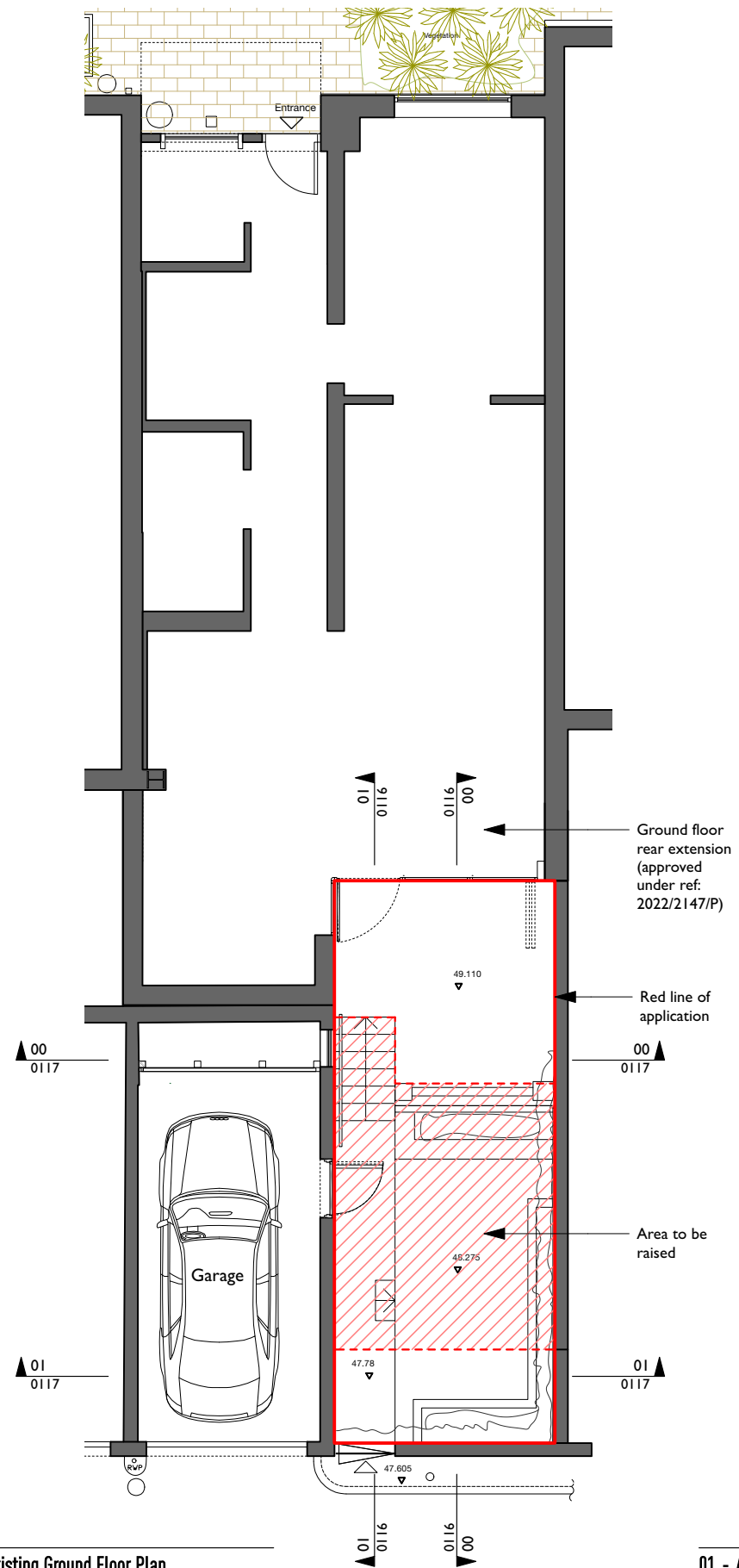

00 - Existing Ground Floor Plan  
1:100@A3

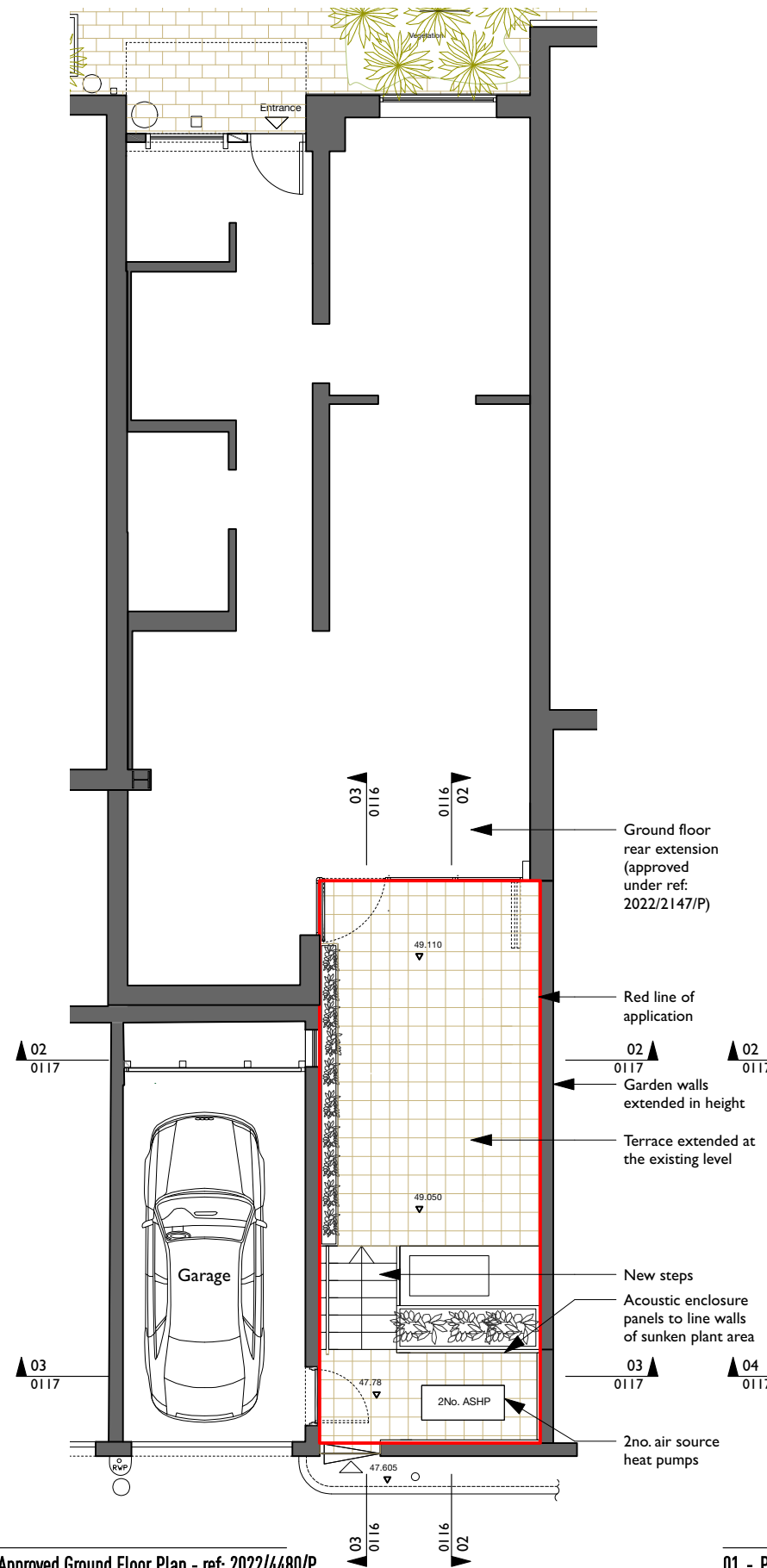

01 - Approved Ground Floor Plan - ref: 2022/4480/P  
1:100@A3

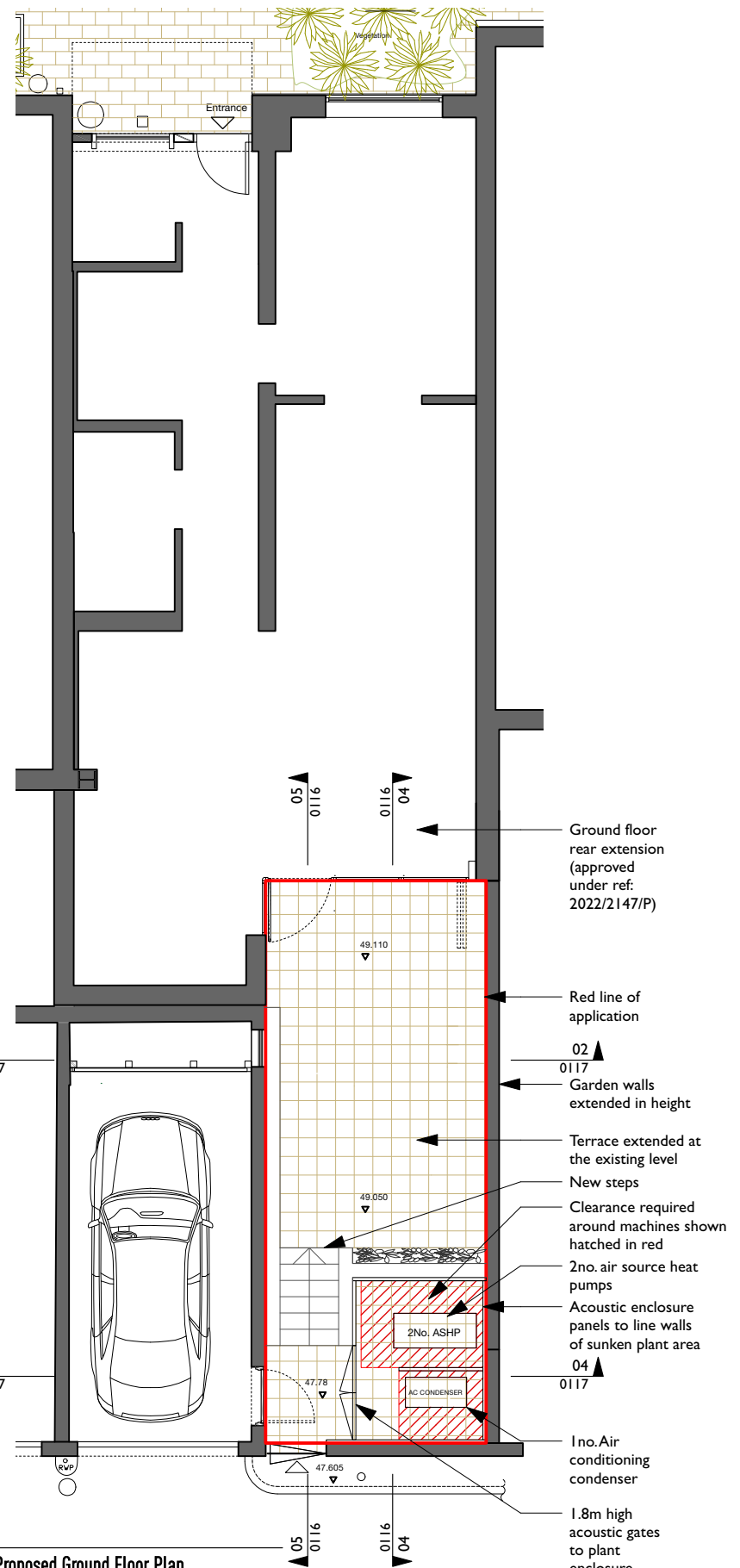

01 - Proposed Ground Floor Plan  
1:100@A3



Revisions



Client: Mr Rami Cohen and Ms Louise Gilbert  
 Project: 12 Queensmead, St Johns Wood Park, NW8 6RE  
 Drawing Title: General Arrangement Existing / Approved / Proposed  
 Project No: 171

|                          |                 |              |
|--------------------------|-----------------|--------------|
| Status: Planning         | Drawn: DL       | Checked: DL  |
| Scale: 1:100@A3          | Date: Sept 2024 | Revision: P2 |
| Drawing Number: 171-0115 |                 |              |