

The contractor is responsible to ensure that no products are to be utilised that do not comply with relevant British and/or European Standards and/or Codes of Practice, COSHH Regulations, Construction Regulations, or which are known or suspected at the time of product selection and/or construction to be deleterious to health and safety or to the durability of the work or not in accordance with good building practices.

The contractor is responsible for checking dimensions, tolerances, levels and references. This drawing/model is to be read in conjunction with all relevant Other Project Team Members' or specialists' drawings/models/any Federated Model. Any discrepancy is to be notified to Baily Garner LLP and is to be rectified before proceeding with the works on site or shop drawings. Where an item is covered by drawings to different scales, the larger scale drawing is to be worked to.

Any rights (including copyright) in this drawing/model and any proprietary work contained therein belong to Baily Garner LLP and may only be used in accordance with the licence granted to the Employer and with attribution to Baily Garner LLP.

The drawing to be read in conjunction with: Document Suitability Codes page or at www.bailygarner.co.uk/disclaimer/

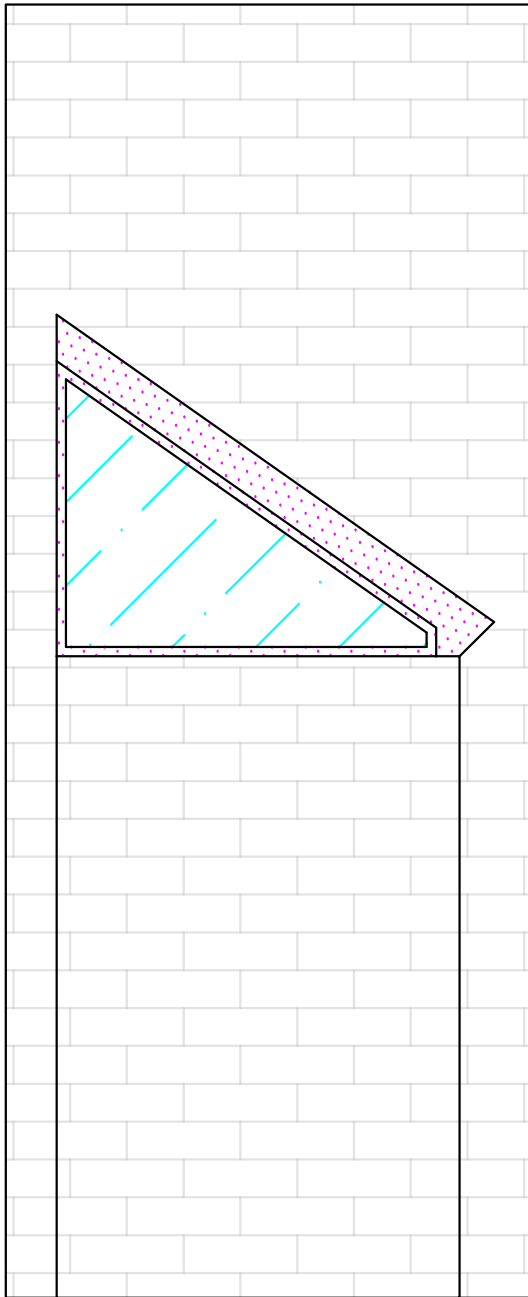

EXISTING BUGGY STORE
ELEVATION:
N.T.S

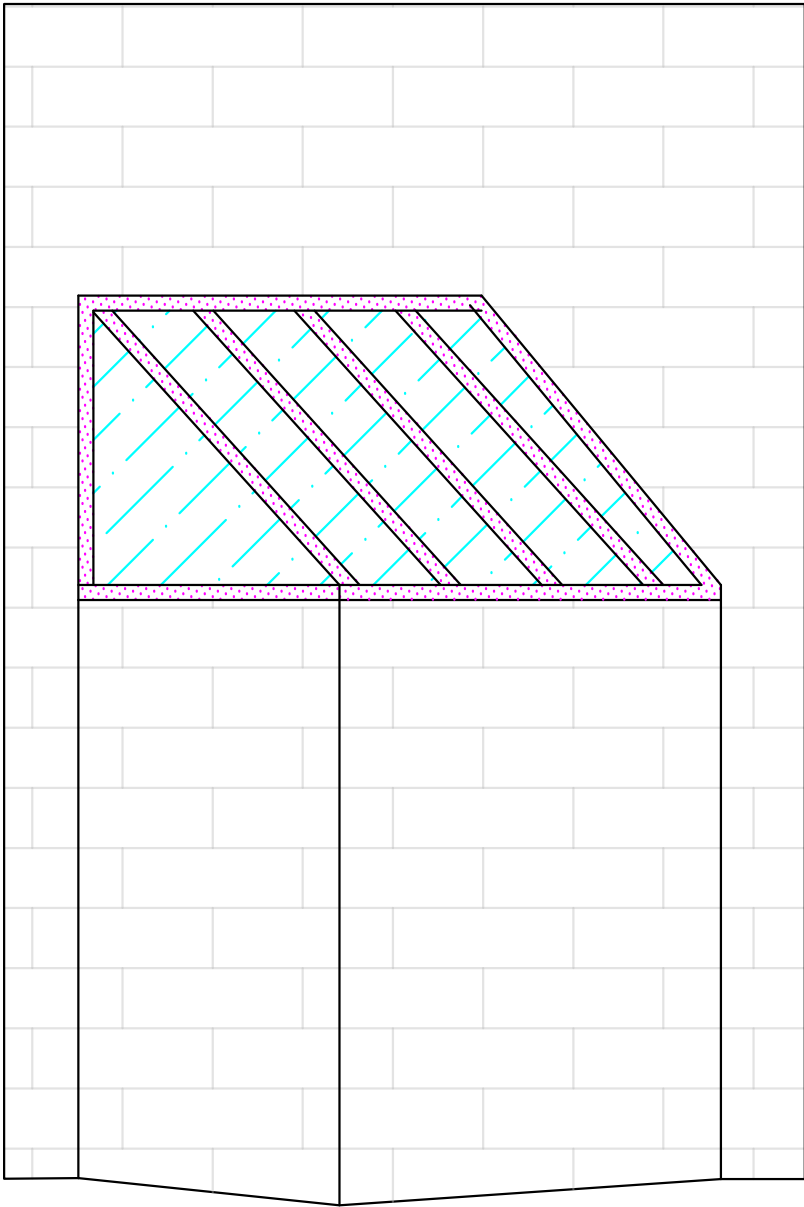

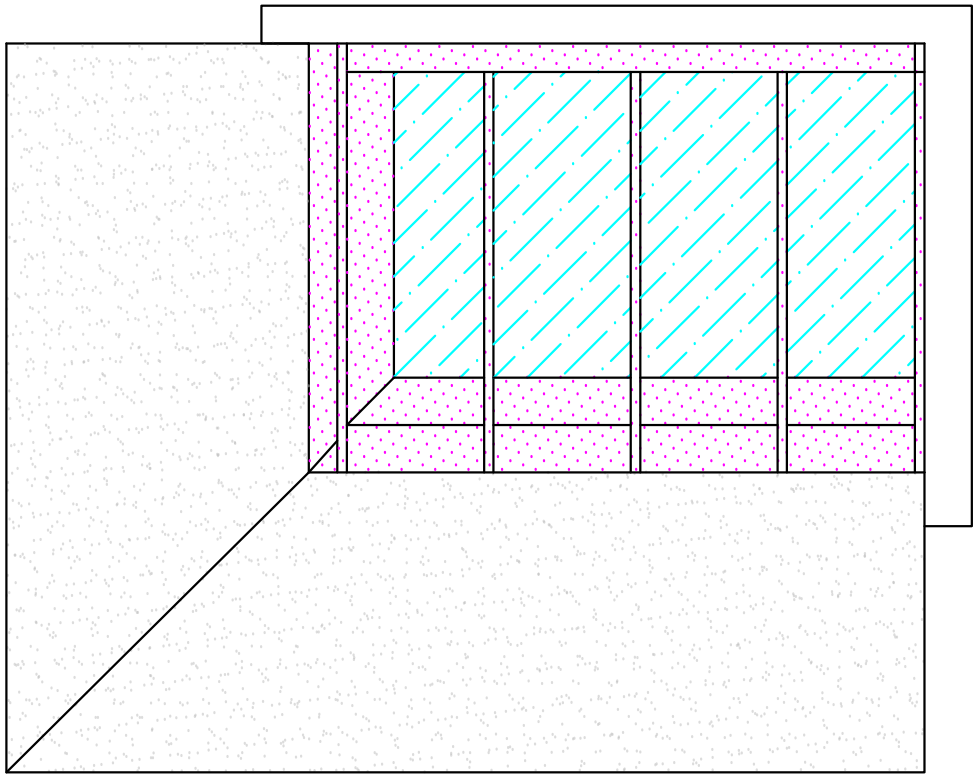

EXISTING BUGGY STORE AXONOMETRIC
VIEW:
N.T.S



EXISTING BUGGY STORE PLAN VIEW:
N.T.S

KEY:

-  Aluminium Framed
-  PVCu Framed
-  Glazing

- Note :
- Elevations To Be Read in Conjunction With Rehau Window Schedule
 - All Aluminium Frames to be Like For Like uPVC Replacements

Hampden Children's Centre

Existing Buggy Store

| | | | | | | | |
|---|---------------|--------------|-------------|---|-----------|-------------------|--------------------|
| CLIENT NAME London Borough Of Camden | | | | PROJECT NAME Hampden Children's Centre | | | |
| PROJECT ADDRESS Hamden Children's Centre 80 Polygon Road London, NW1 1HQ | | | | DRAWING TITLE Proposed Buggy Store | | | |
| SCALE: N.T.S | | | | SUITABILITY CODE Planning | | | |
| PROJ NO 35330 | AUTHOR BGR | VOLUME 01 | LEVEL XX | DRAWN DR | ROLE P | DRAWING NO 005 | REV STAT P |
| | | | | | | REV NO A | DATE 25/09/2024 |



LONDON HEAD OFFICE
146-148 ELTHAM HILL
LONDON SE9 5DY
t. 020 8294 1000
e. general@bailygarner.co.uk