





© This drawing is the property of Miltiadou Cook Mitzman architects. No disclosure or copy of it may be made without the written permission of Miltiadou Cook Mitzman architects.

For construction purposes:

- Do not scale this drawing.
- All dimensions and levels to be checked on site.
- Discrepancies to be reported to Miltiadou Cook Mitzman architects before proceeding.
- If in any doubt about information on this drawing contact Miltiadou Cook Mitzman architects.

REVISION			
NUMBER	DATE	BY	NOTES
P1	24/10/2024	OS	Issued for planning

		REMOVAL
		EXISTING BUILD UP
		PROPOSED BUILD UP

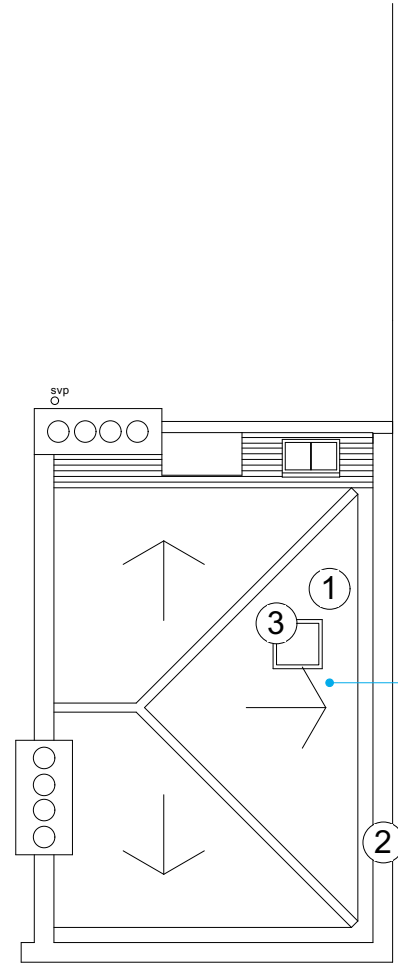

Re-decoration including replacement of lead flash and slates to match existing where needed

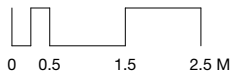

1 Existing - RoofPlan
1:100

MILTADOU COOK MITZMAN architects llp
 020 7722 8525 3rd Floor
 office@mcma.design 10-12 Emerald Street
 www.mcma.design London WC1N 3QA

CLIENT
 Mrs Misha Moore

PROJECT
 10 Prowse Pl,
 NW1 9PN

SHEET TITLE
 Roof Plan - Proposed and Existing

SCALE
 AS NOTED@A3

DATE CREATED **FILE REFERENCE**

DRAWING NUMBER	REVISION
420-DWG-005	P1

- MATERIALS:**
1. SLATE TILES [RETAINED AND MAKE GOOD]
 2. RENDER COPING [RETAINED AND MAKE GOOD]
 3. TIMBER FRAME ROOFLIGHT (RETAINED)