

1 Lower Ground Floor Plan - Proposed
1 : 50

General Notes

No implied license exists. This drawing should not be used to calculate areas for the purpose of valuation. On no scale this drawing, all dimensions to be checked on site by the contractor and such dimensions to be their responsibility. All drawings, fixtures, design, shall only be used as a guide to materials, finishing, etc. and design development. All work must comply with relevant British Standards and Building Regulations requirements. Drawing errors and omissions to be reported to the architect.

| Rev | Description | Date |
|-----|-----------------|----------|
| 3 | Planning Appeal | 27/02/24 |
| 2 | Planning Appeal | 13/07/23 |
| 1 | Planning | 20/04/23 |

Notes

--- Assumed Site Boundary

Material Key

| | |
|------|------------------------------|
| B.01 | Brick, Existing |
| B.02 | Masonry, Brick or Stone |
| F.36 | Buster & Punch - Black Metal |
| F.48 | Black Stained Timber |
| R.01 | Roof, Existing |
| T.02 | Timber, Black Stain Veneered |

unknown works

London Studio
Studio 8A, Stamford X
Gillet Street, N16 8JH
hello@unknown.works
+44 (0) 2051917131
Hong Kong Studio
Unit 205 94 Victoria Road
Kowloon, Gai Factory Building
© unknown works

Client
Samantha & Anael Astic

Project
17 Dartmouth Park Avenue

Orientation

Scale
0 1m 2m
1 : 50

Keyplan

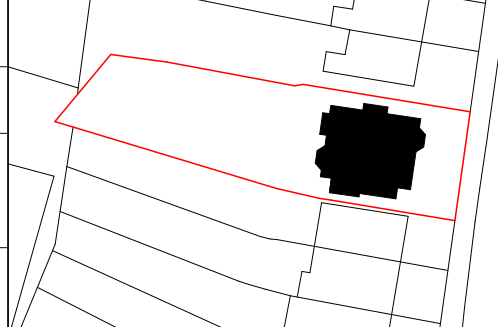

Drawing Title

Lower Ground Floor Plan

| Project Number | Status |
|---------------------------|-----------------|
| 0046 | Planning Appeal |
| Scale at A1/A3 | Date |
| 1:50/1:100 | 27/02/24 |
| Drawn by | Checked by |
| UW | UW |
| Drawing Number | Revision |
| 0046-UW-04-03-DR-A-A1.101 | 3 |