

**Tree Data Schedule**

Reference C = Group H = Hedge	Age & Species	Height (m)	Crown Spread (m)			Scaled Tree Diagram (m)	Notes	Recommendations (Independent of any development proposals)		View		Amenity Value	
			W	N	E			Priority	Inspect (see 10.5)	Physiological Condition	Structural Condition	Life Expectancy (yrs)	Retention Category
T1	Early-Mature <b>Lime</b> Tilia sp.	9.5	6	4.6	2		Position: Street tree. Form: Single stemmed and vertical with a balanced crown. History: Managed by cyclical pollarding and recently pollarded. Defects: <b>Dead bark at the base on the northern side with significant decay beneath and into heart wood.</b>	Monitor or Remove. High 0.5	Moderate Fair Poor	Moderate Fair Poor	High <10	U	
T2	Young <b>Plum</b> Prunus sp.	3.5	1.5	9	1		Position: Situated on third party land. Form: Single stemmed and leaning with a slightly unbalanced crown. History: No evidence of significant pruning. Defects: <b>No significant defects.</b> Other: Limited inspection, dimensions estimated.	No action required. n/a 3	Moderate Good Good	Moderate Good Good	Low 40+	C	
T3	Young <b>Plum</b> Prunus sp.	6	2	11	2		Form: Single stemmed and vertical with a balanced crown. History: Multiple pruning wounds due to crown reduction. Defects: <b>No significant defects observed.</b>	No action required. n/a 3	Moderate Good Good	Moderate Good Good	Low 40+	C	
T4	Young <b>Cherry Laurel</b> Prunus laurocerasus.	3.5	1.5	9	1.5		Form: Multi-stemmed at 1m with a slightly unbalanced crown. History: No evidence of significant pruning. Defects: <b>No significant defects.</b>	No action required. n/a 3	Moderate Good Good	Moderate Good Good	Low 40+	C	
T5	Semi-Mature <b>Bay Laurel</b> Laurus nobilis.	6	1.5	27	3		Form: Multi-stemmed at ground level with a balanced crown. History: No evidence of significant pruning. Defects: <b>No significant defects.</b> Other: Recorded stem diameter is equivalent for five stems (19cm, 10cm, 11cm, 8cm, 8cm).	No action required. n/a 3	Moderate Good Good	Moderate Good Good	Low 40+	C	
T6	Early-Mature <b>Elder</b> Sambucus nigra.	6.5	2	30	3		Position: Situated on third party land. Form: Single stemmed and vertical with a slightly unbalanced crown. History: No evidence of significant pruning. Defects: <b>No significant defects.</b> Other: Ivy prevented detailed inspection. Growing against and displacing the boundary wall.	No action required. n/a 3	Moderate Good Good	Moderate Good Good	Low 10-20	C	

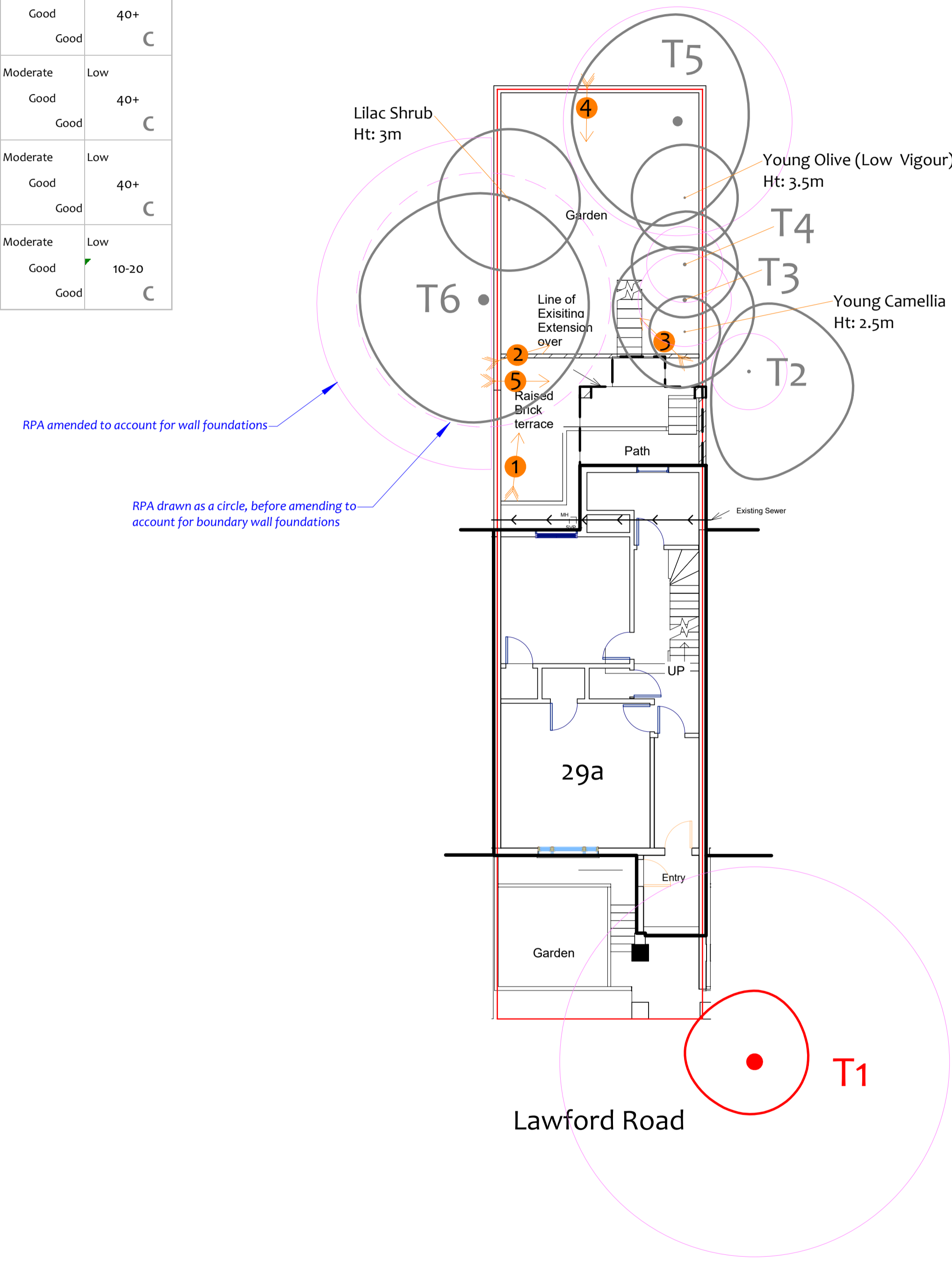

Drawing No: CCL 11850 / TCP Rev: 1  
 Title: Tree Constraints Plan (Existing Layout)  
 Site: 29a Lawford Road NWS 21G  
 Scale: 1:100 Paper Size: A1

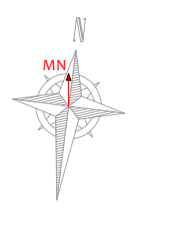

Tree Retention Categories	
	Category A tree
	Category B tree
	Category C tree
	Category U tree

Trees of high quality with an estimated life expectancy of 40+ years. Usually large trees with significant presence or smaller trees with excellent form. Retention of these trees is highly desirable.

Trees of moderate quality with a life expectancy of 20+ years. Usually maturing trees or younger trees with good form. Retention of these trees is desirable though less than Category A trees.

Unremarkable trees of low quality and merit. Individual specimens are not considered to be a material planning consideration.

Trees unsuitable for retention due to their very poor condition.

**Tree Constraints Plan**  
 Status: Final

	B5 S537 Root Protection Area (radius = 1xstem diameter)
	Root Protection Area needing amendment due to site conditions, e.g. presence of existing road or building
	Root Protection Area having been amended to account for site conditions

T1 = Tree No 1 G2 = Group No 2 H3 = Hedge No 3

Photo 1  
 MN = Measured North  
 Canopy spreads are sometimes measured to an approximate N defined by site features. Often more accurate, especially where rows of trees are not aligned N-S or E-W.

Tree Ref.	Species	Height (m)	Root Protection Area		
			Radius (m)	m <sup>2</sup>	Square (m)
T1	Lime	9.5	5.5	96	9.8
T2	Plum	3.5	1.1	4	1.9
T3	Plum	6	1.3	5	2.3
T4	Cherry Laurel	3.5	1.1	4	1.9
T5	Bay Laurel	6	3.2	33	5.7
T6	Elder	6.5	3.6	41	6.4

# Proposed Layout (Pink)

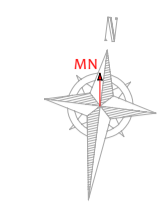

**Tree Pruning**

As ground levels are being lowered beneath the canopy of T6, no pruning is likely to be required. However, to prevent accidental damage from construction activity during the build, it may be necessary to prune some of the lower branches that grow towards the proposed extension. If pruning is necessary, it shall be minimal and will not have a significant impact on tree health or local levels of visual amenity. Hence these works are not considered to be a material planning consideration.



RPA amended to account for wall foundations.

Trial excavations indicate that the wall extends 530mm below the existing ground levels, with the foundations extending further below this point. Trial excavations also revealed there to be almost no rooting activity within the rear garden of No 29a (close to the stem of T6), other than some small roots that have penetrated the mortar. See adjacent photograph.

Consequently, the proposed excavation for the foundations and lower garden levels shall have a negligible impact on T6.

Existing ground levels to be retained

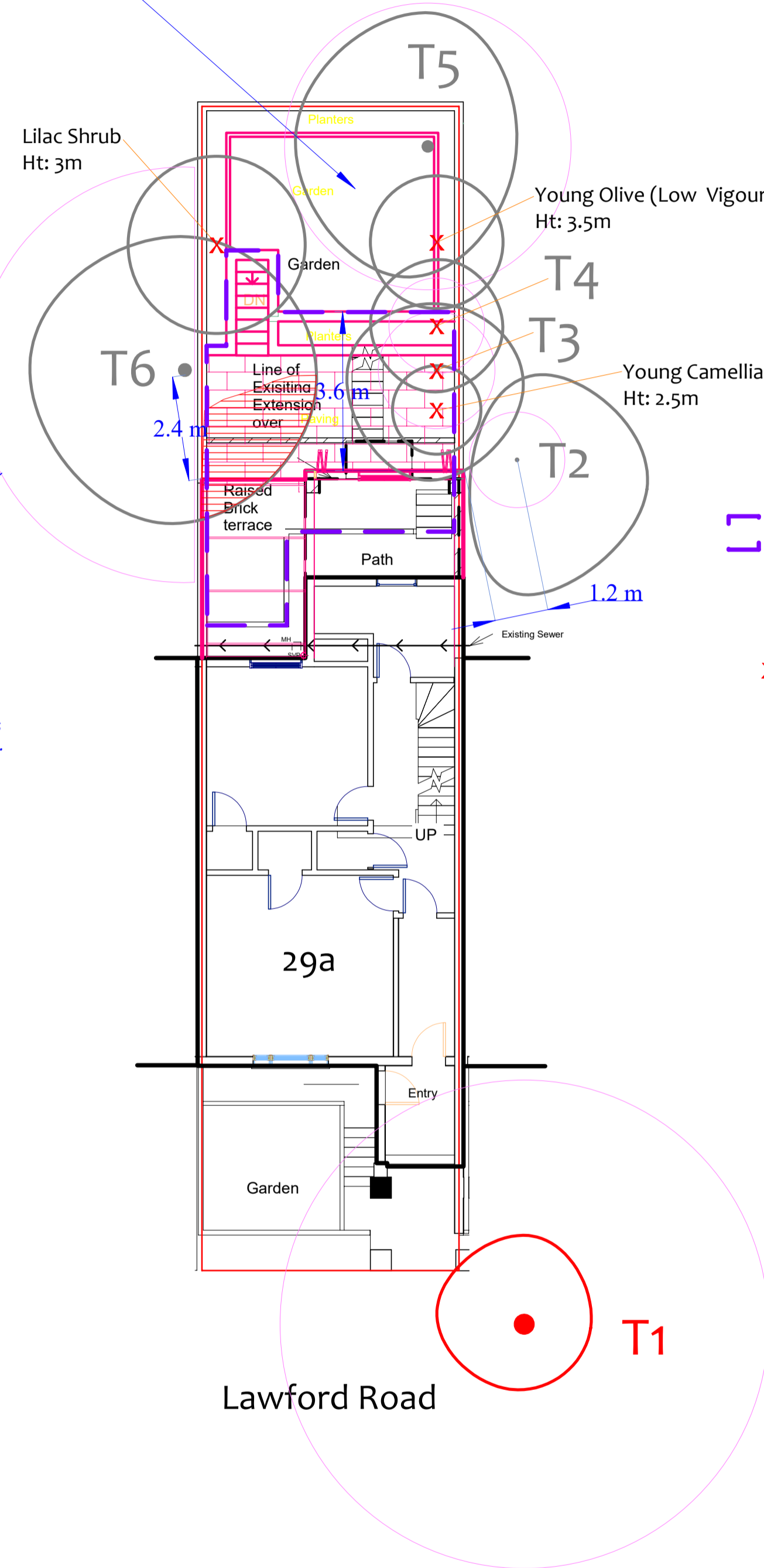

Total area of excavation

**X Tree Removal**

To enable the development, it is proposed to remove two Retention Category C trees, T3 and T4. All other trees shall be retained. T3 is a plum tree and T4 is a cherry laurel. Both trees are located within the rear garden of No 29a Lawford Road and are not visible from public vantage points.

It is also proposed to remove young olive, camellia and lilac shrub.

Drawing No:	CCL 11850 / IAP Rev: 1
Title:	Impact Assessment Plan
Site:	29a Lawford Road NWS 2LG
Scale:	1:100
Paper Size:	A1



Tree Retention Categories	
Stems & canopies shown	
	Category A tree
	Category B tree
	Category C tree
	Category U tree

Trees of high quality with an estimated life expectancy of 40+ years. Usually large trees with significant presence or smaller trees with excellent form. Retention of these trees is highly desirable.

Trees of moderate quality with a life expectancy of 20+ years. Usually maturing trees or younger trees with good form. Retention of these trees is desirable though less than Category A trees.

Unremarkable trees of low quality and merit. Individual specimens are not considered to be a material planning consideration.

Trees unsuitable for retention due to their very poor condition.

## Impact Assessment Plan

Status: Final - for submission

	B5 s837 Root Protection Area (radius = 1x stem diameter)
	Root Protection Area needing amendment due to site conditions, e.g. presence of existing road or building.
	Root Protection Area having been amended to account for site conditions
T1 = Tree No 1	G2 = Group No 2 H3 = Hedge No 3

Tree to be removed to facilitate the proposal

Tree to be removed due to its low quality

Proposed pruning

MN = Measured North

Canopy spreads are sometimes measured to an approximate N defined by site features. Often more accurate, especially where rows of trees are not aligned N/S or E/W.

Tree Ref.	Species	Height (m)	Root Protection Area	
			Radius (m)	Square (m)
T1	Lime	9.5	5.5	96
T2	Plum	3.5	1.1	4
T3	Plum	6	1.3	5
T4	Cherry Laurel	3.5	1.1	4
T5	Bay Laurel	6	3.2	33
T6	Elder	6.5	3.6	41

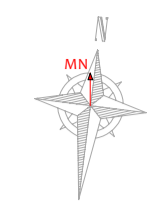

# Tree Protection Plan

## Tree Protection Barriers:

	Fixed protective barrier: The 'In-Ground System' or the 'Backstay System'. To remain in place for all construction activity		Construction Exclusion Zone Stem protected to a height of 2.5m with thick cloth & wire Tree Protection Boarding 1.2 x 1.2 x 2.4m high 25mm plywood
	Moveable protective barrier: The 'Backstay System'. To remain in place except when approved works are being undertaken in the Restricted Zone		Orange Barrier Mesh Fencing, 1.8m, on steel fencing pins and wooden posts To remain in place throughout all construction activity

## The 'Back Stay System'

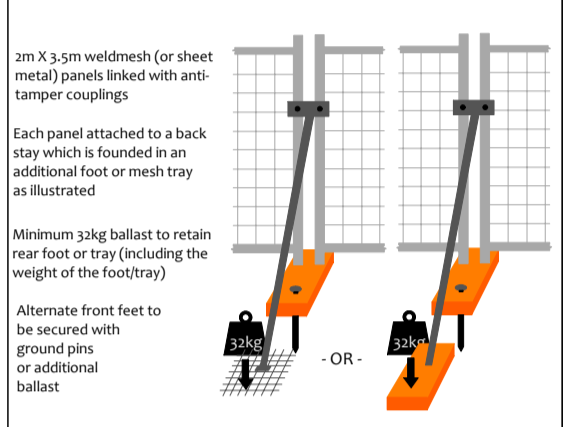

## The 'In-Ground' System

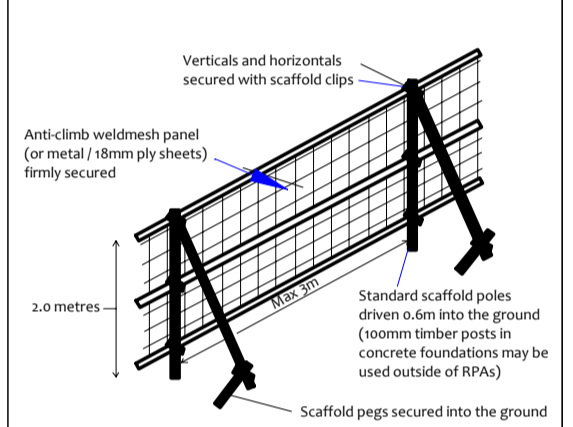

## Construction Exclusion Zone

- Within this area the following restrictions shall apply:
- No excavation or land regrading whatsoever.
  - No storage of materials, rubble, soil or spoil.
  - No fires within the exclusion zone or within 10m of any tree canopy.
  - No site cabins or other temporary structures.
  - No discharge of polluted water, cement or chemicals of any kind.
  - No use of any machinery, or passage or parking of vehicles.
  - No tree works without council consent.

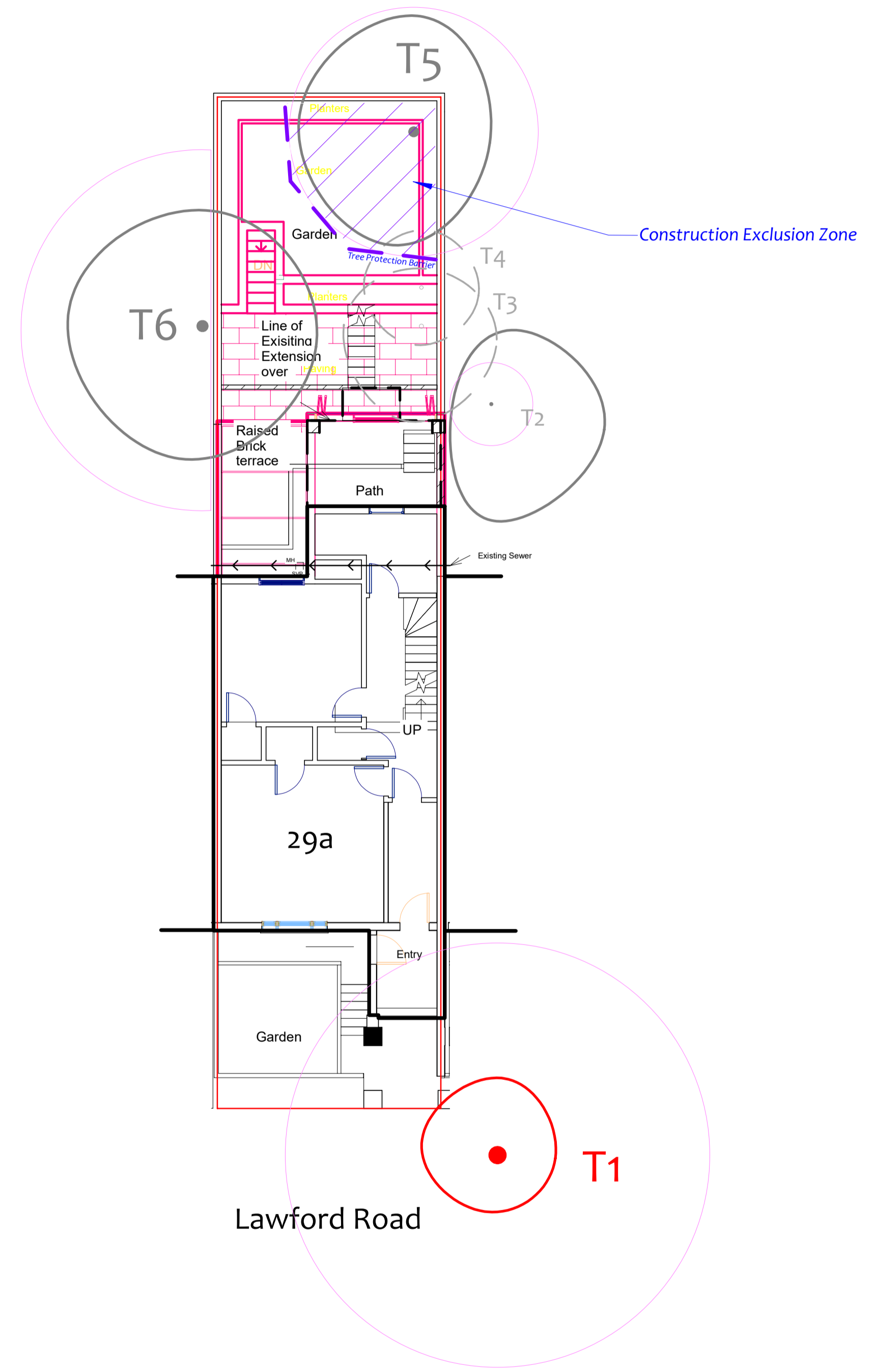

Drawing No:	CCL 11850 / TPP Rev: 1
Title:	Tree Protection Plan (Existing Layout with Proposals Overlaid)
Site:	29a Lawford Road NWS 21G
Scale:	1:100
Paper Size:	A1



Tree Retention Categories		Stems & canopies shown
	Category A tree	Trees of high quality with an estimated life expectancy of 40+ years. Usually large trees with significant presence or smaller trees with excellent form. Retention of these trees is highly desirable.
	Category B tree	Trees of moderate quality with a life expectancy of 20+ years. Usually maturing trees, or younger trees with good form. Retention of these trees is desirable though less than Category A trees.
	Category C tree	Unremarkable trees of low quality and merit. Individual specimens are not considered to be a material planning consideration.
	Category U tree	Trees unsuitable for retention due to their very poor condition.

# Tree Protection Plan

	B5 s837 Root Protection Area (radius = 1xstem diameter)
	Root Protection Area needing amendment due to site conditions, e.g. presence of existing road or building.
	Root Protection Area having been amended to account for site conditions

MN = Measured North

Canopy spreads are sometimes measured to an approximate N defined by site features. Often more accurate, especially where rows of trees are not aligned N-S or E-W.

Tree Ref.	Species	Height (m)	Root Protection Area	
			Radius (m)	Square (m)
T1	Lime	9.5	5.5	96
T2	Plum	3.5	1.1	4
T3	Plum	6	1.3	5
T4	Cherry Laurel	3.5	1.1	4
T5	Bay Laurel	6	3.2	33
T6	Elder	6.5	3.6	41

T1 = Tree No 1 G2 = Group No 2 H3 = Hedge No 3