

6 GAYLON ROAD  
NW3 1TX

DRAWING I: FRONT ELEVATION

SCALE BAR: 1cm: 20cm

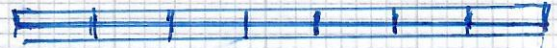

SCALE 1:20cm

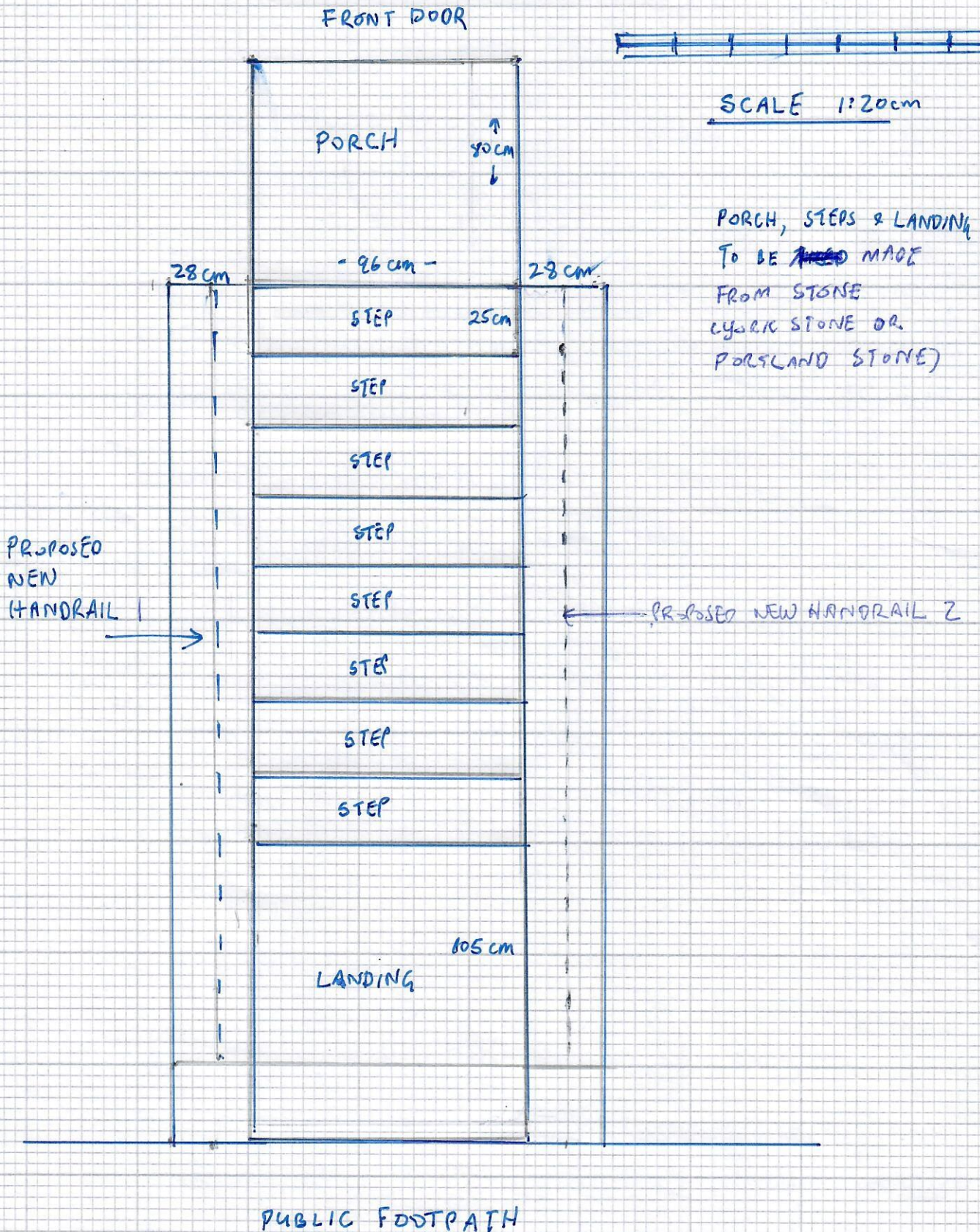

6 GAYTON ROAD  
NW3 1TX

DRAWING 2: SIDE ELEVATION

SCALE: 1:20

SCALE BAR: 1cm: 20cm

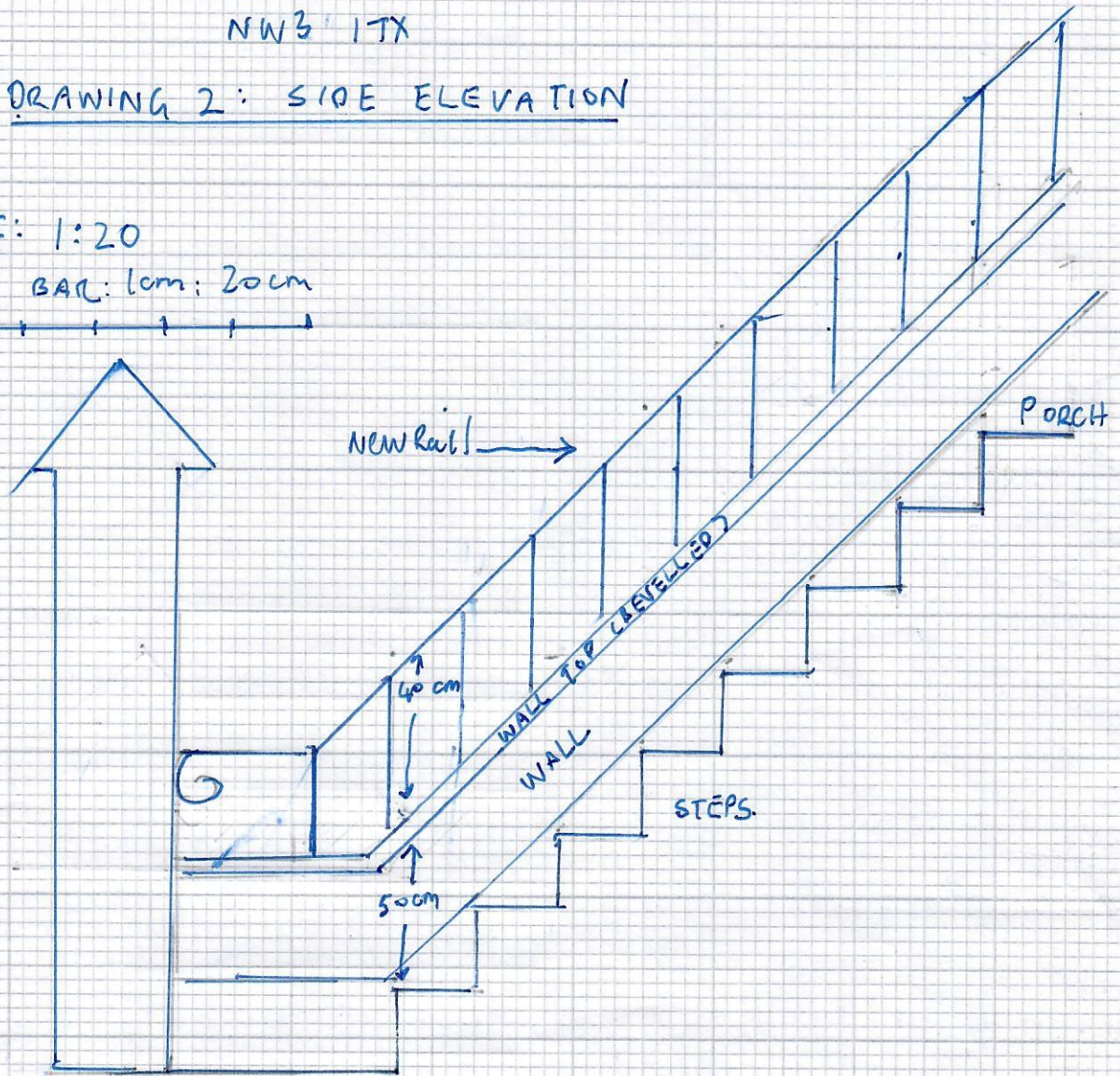

PITCH FROM STEP TO TOP OF WALL = 50 cm

PITCH FROM STEP TO RAIL = 90 cm

HAND RAIL: WROUGHT IRON = BLACK.

HAND RAIL SPEC: HEIGHT = 40 cm.

HAND RAIL TO GO ON EACH SIDE OF STEPS - SEE DRAWING 1