

1. New conservation rooflights study and hall
2. New slate roof butterfly roof with lead valley to replace existing concrete tile roof (in process due to leaks)
3. New solar panels

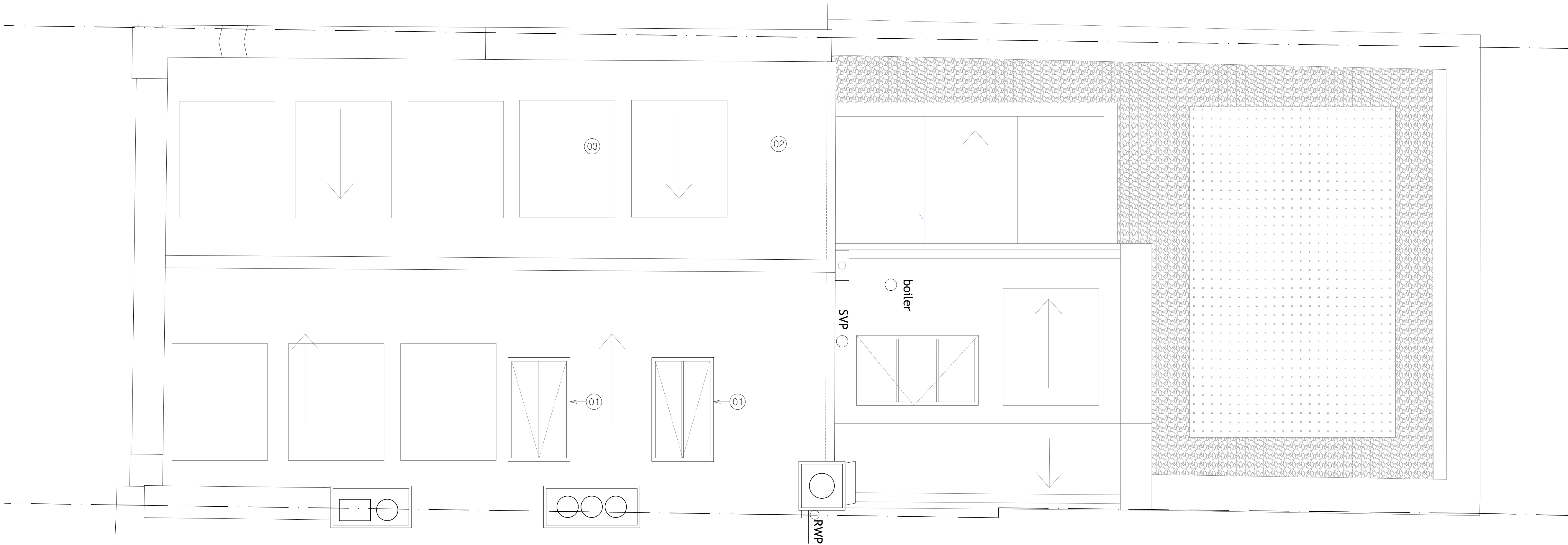

① existing roof plan

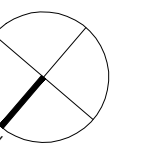

rev. date revisions

notes

project

9 Alma Street  
London  
NW5 3DJ

client  
Blackford

drawing title  
proposed roof plan

architect  
**ROAR**

scale at A1 1:25 scale at A3 1:50 date 10.24

job no. n370 drawing P103 rev. -

All information subject to design development and site verification.

This drawing is the property of ROAR Architects Ltd. No disclosure or copy of it may be made without written permission. This drawing is for planning purposes only, no guarantee is given to its accuracy or correctness and is subject to site verification.