



PLANNING ISSUE

Check all dimensions on site. Do not scale off drawings without prior consultation. Any discrepancies to be reported to architects before execution of relevant works. This drawing has been produced for Parkgate Aspen for the development of Regency Lodge, Swiss Cottage, London, NW3 and for that application alone and is not intended for use by any other person or for any other purpose. Drawings remain copyright of Hayhurst and Co. and may not be reproduced without written consent or licence.

Existing Type Z3 Windows:
Medium Universal range
(no longer manufactured)

Proposed Type Z3 Windows:
Homelight range
(see drawing 112 A020)

Existing Type Z2 and Z3 Doors:
Medium Universal range
(no longer manufactured)

Proposed Type Z2 and Z3 Doors:
Crittall Corporate W20 range
(manufacture recommended)

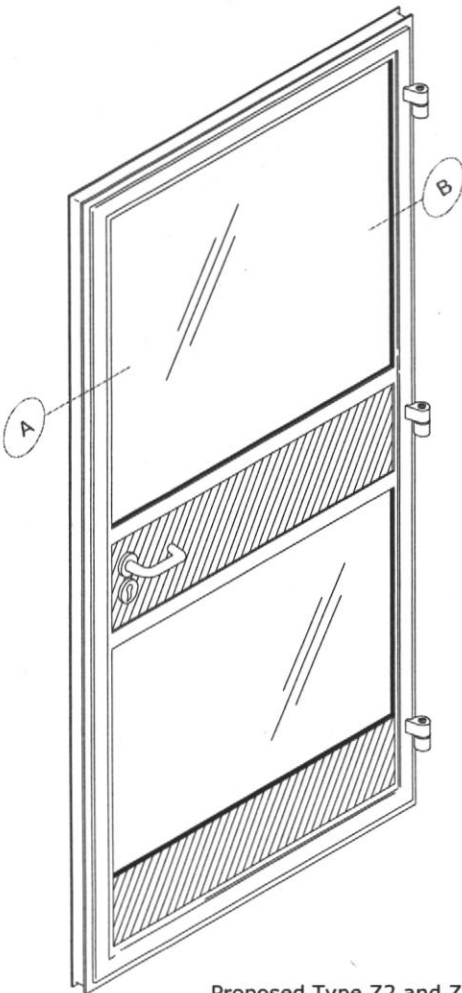

Proposed Type Z2 and Z3 Door



Type Z2 and Z3 Door Locations

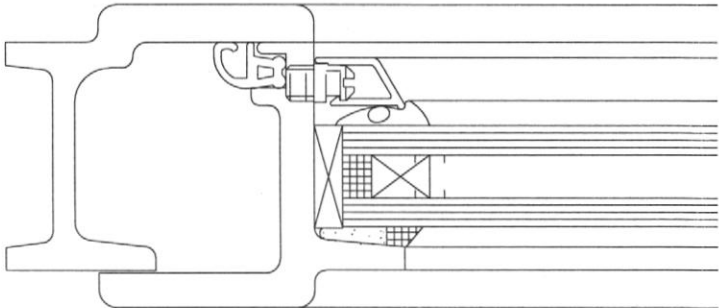

A

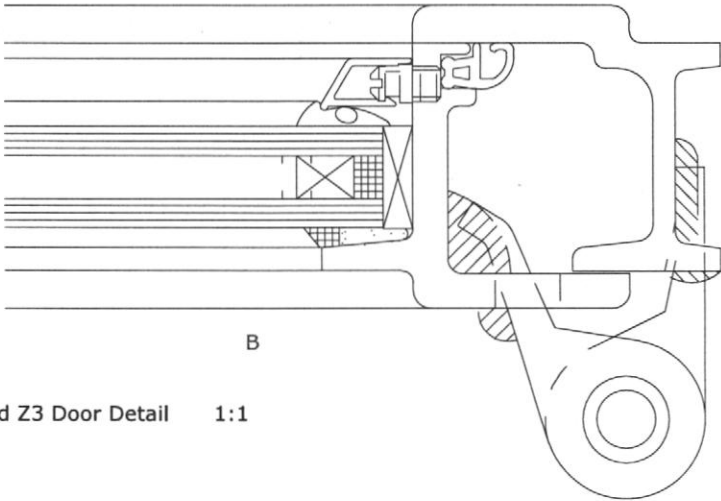

B

Proposed Type Z2 and Z3 Door Detail 1:1

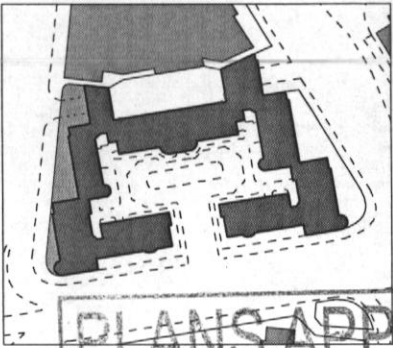

PLANS APPROVED

26 JAN 2012

RECEIVED
01 DEC 2011

2011/5547/P
COPY

Issue/Revision	Date	Rev
Project:		
Regency Lodge, London, NW3 Window Replacement		
Hayhurst and Co.		
26 Fournier Street, London, E1 6QE T: (020) 7247 7028 F: (020) 7247 7029 E: mail@hayhurstand.co.uk www.hayhurstand.co.uk		
Subject:	Type Z2 and Z3 Typical Detail	
Scale:	1:1	Date: 29.11.2011
Original Size:	A3	
Drawing No.:	112 A022	