

© DO NOT SCALE. Use figured dimensions only. Contractor to check all dimensions before commencement of works. This drawing is copyright. This data to be used as a guide only - not as live data. This drawing must only be used for the purpose for which it is supplied.

- LEGEND**
- PROPOSED CEILINGS LEGEND**
- CT.01 Existing plaster ceilings to be repainted RAL 9010 Pure White
 - CT.02 Existing plaster ceilings to be repainted RAL 7016 Anthracite Grey

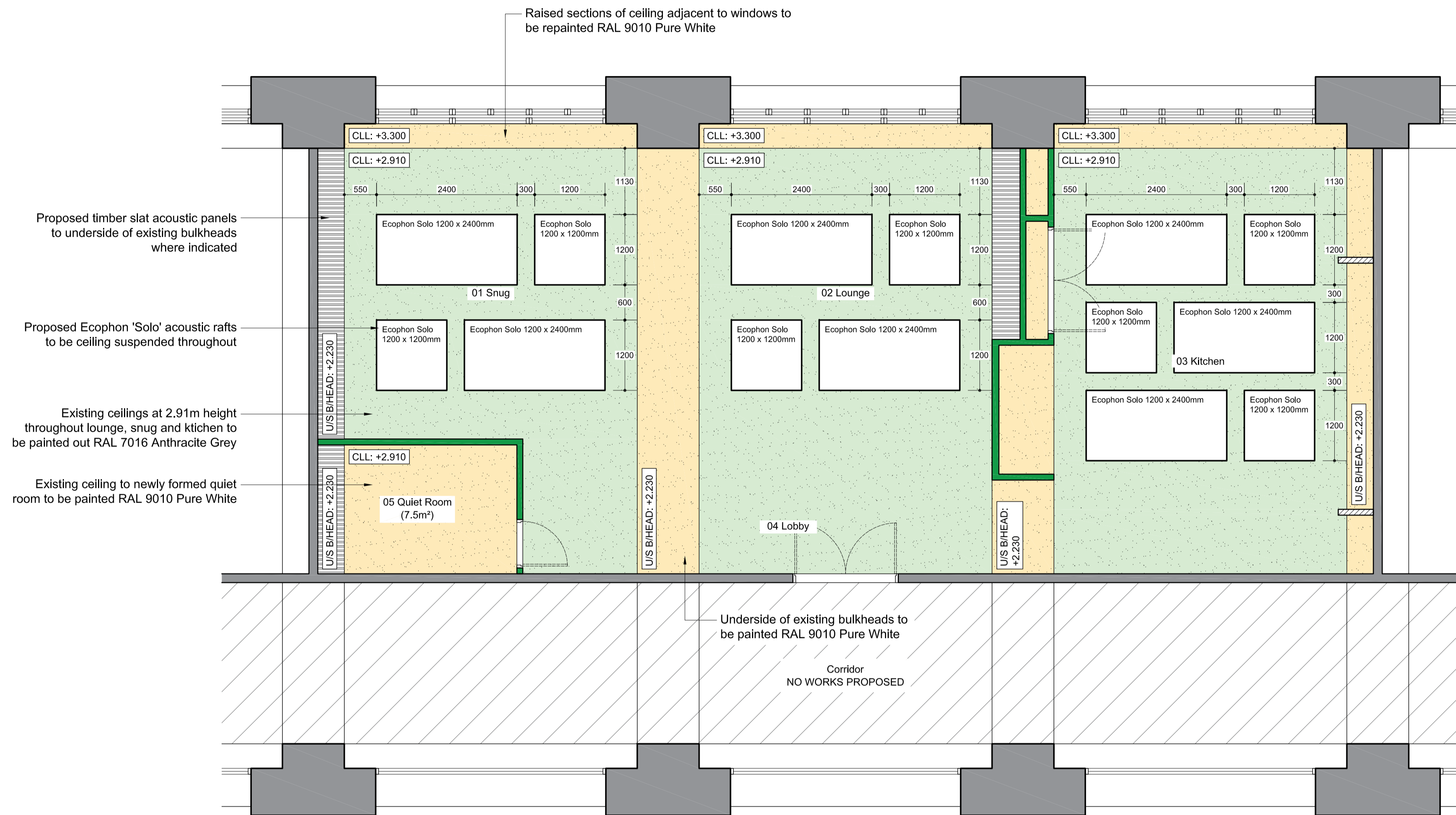

01 Proposed GA Plan
Scale 1:50 @ A1

no.	18/09/24	CM	FOR LANDLORD'S CONSENT	GO	ASF
	date	by	revision details	Ckd	App

STRALA architects
 3rd Floor, 9 Stevenson Square Northern Quarter, Manchester, M1 1DB
 Tel: 0161 236 5866
 E: office@strzarch.co.uk



client
LONDON NORTH EASTERN RAILWAY

project
ELR: ECM1, MILEAGE: 0m 00ch, OS Ref: TQ302830
LONDON KINGS CROSS TRAIN STATION
STAFF MESS ROOM

drawing status
FOR LANDLORD'S CONSENT

drawing title
**PROPOSED REFLECTED
CEILING PLAN**

drawn by	date	checked by	date
CM	18/09/24	GO	18/09/24
Approved by	date	Reviewed by	date
ASF	18/09/24	RES	18/09/24
Network Rail dwg no.	revision no.	sht no.	
	/	1 of 1	

consultant dwg no. 3343-203 scale 1:50 sht size A1