

©
DO NOT SCALE. Use figured dimensions only. Contractor to check all dimensions before commencement of works. This drawing is copyright. This data to be used as a guide only - not as live data. This drawing must only be used for the purpose for which it is supplied.

LEGEND

Site Location

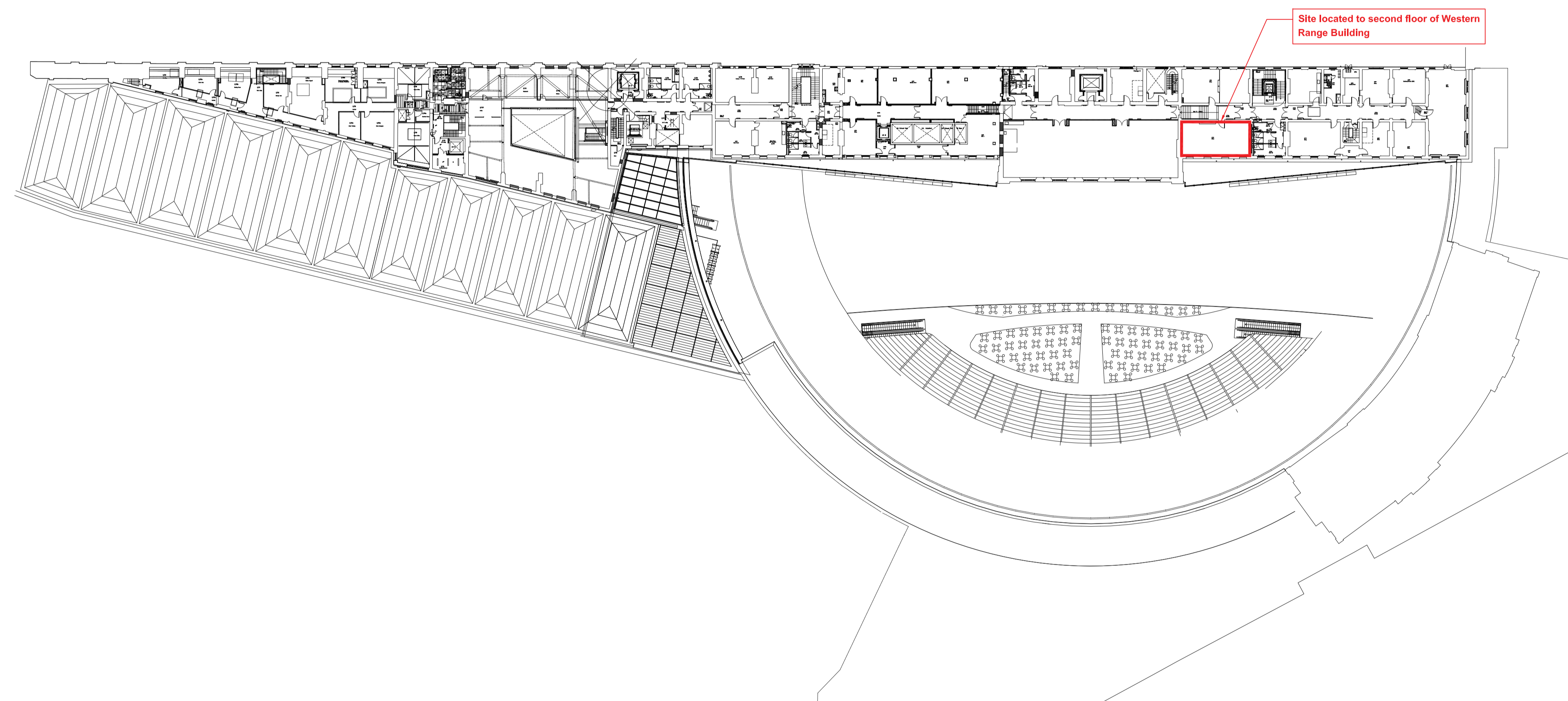

01 Existing Site Plan - Western Range Building Second Floor
Scale 1:500 @ A1

/	18/09/24	CM	FOR LANDLORD'S CONSENT	GO	ASF
no.	date	by	revision details	Ckd	App

STRALA architects
3rd Floor, 9 Stevenson Square Northern Quarter, Manchester, M1 1DB
Tel: 0161 236 5866
E: office@strzarch.co.uk



client
LONDON NORTH EASTERN RAILWAY

project
ELR: ECM1, MILEAGE: 0m 00ch, OS Ref: TQ302830
LONDON KINGS CROSS TRAIN STATION
MEDICAL ROOM

drawing status
FOR LANDLORD'S CONSENT

drawing title
EXISTING SITE PLAN

drawn by	date	checked by	date
CM	18/09/24	GO	18/09/24

Approved by	date	Reviewed by	date
ASF	18/09/24	RES	18/09/24

Network Rail dwg no.	revision no.	sht no.
	/	1 of 1

consultant dwg no.	scale	sht size
3325-001	1:500	A1