

1 Proposed Window Elevation - Typical  
Scale 1:20@A3

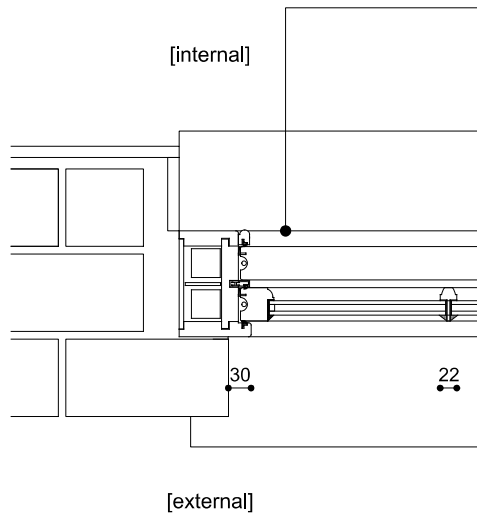

2 Proposed Window Plan Detail - Typical  
Scale 1:10@A3



3 No.154 Existing heritage sash windows

Existing windows replaced with new slimline double glazed hardwood timber sash windows with integral 22mm glazing bars. (Mumford and Wood Classic range box-sash window, or similar)

Six over six original glazing bar arrangement as per neighbouring property (No. 154, see image).

Tickle vents to be avoided. All ironmongery to be made from solid brass.

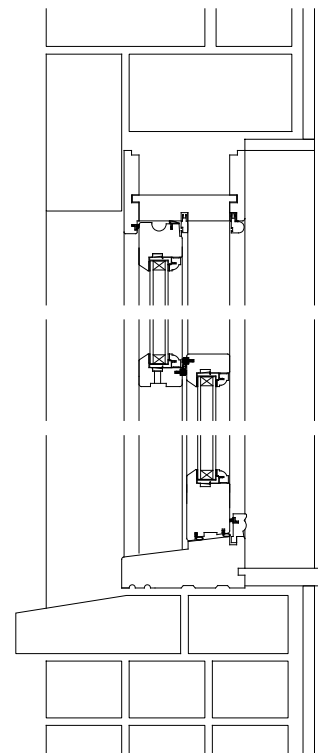

4 Proposed Window Section - Typical  
Scale 1:10@A3

#### WINDOW TYPE A - SASH WINDOWS

Emil Eve Architects

51 Regents Studios  
London, E8 4QN  
T 07805662839 E info@emileve.co.uk  
www.emileve.co.uk



GENERAL NOTES:  
Do not scale from drawings.  
Errors to be reported immediately to the Architect.  
To be read in conjunction with all relevant Architects', Services and Structural Engineers' drawings.  
All existing site, tree and building information has been compiled from different sources. All dimensions to be checked on site.

P1 11/10/24 Planning

Rev. Date Description

Project  
160 Leighton Road  
NW5 2RE

Project number  
124

Client  
Alex & James

Drawing name  
Proposed Replacement  
Sash Window Details

Drawing number  
119\_PR\_550

Date October 2024 Issue  
Scale / Format 1:10 @ A3  
Project Status Information