

The contractor is responsible to ensure that no products are to be utilised that do not comply with relevant British and/or European Standards and/or Codes of Practice, CDM Regulations, Construction Regulations, or which are known or suspected at the time of product selection and/or construction to be deleterious to health and safety or to the durability of the work or not in accordance with good building practice.

The contractor is responsible for checking dimensions, tolerances, levels and references. This drawing/model is to be read in conjunction with all relevant Other Project Team Members' or specialist drawing/modelling Federated Model. Any discrepancy is to be notified to Baily Garner LLP and is to be rectified before proceeding with the works on site or shop drawings. Where an item is covered by drawings to different scales, the larger scale drawing is to be worked to.

Any rights (including copyright) in this drawing/model and any proprietary work contained herein belong to Baily Garner LLP and may only be used in accordance with the licence granted to the Employer and with attribution to Baily Garner LLP.

The drawing to be read in conjunction with Document Suitability Codes page or at www.bailygarner.co.uk/disclosure/

A1

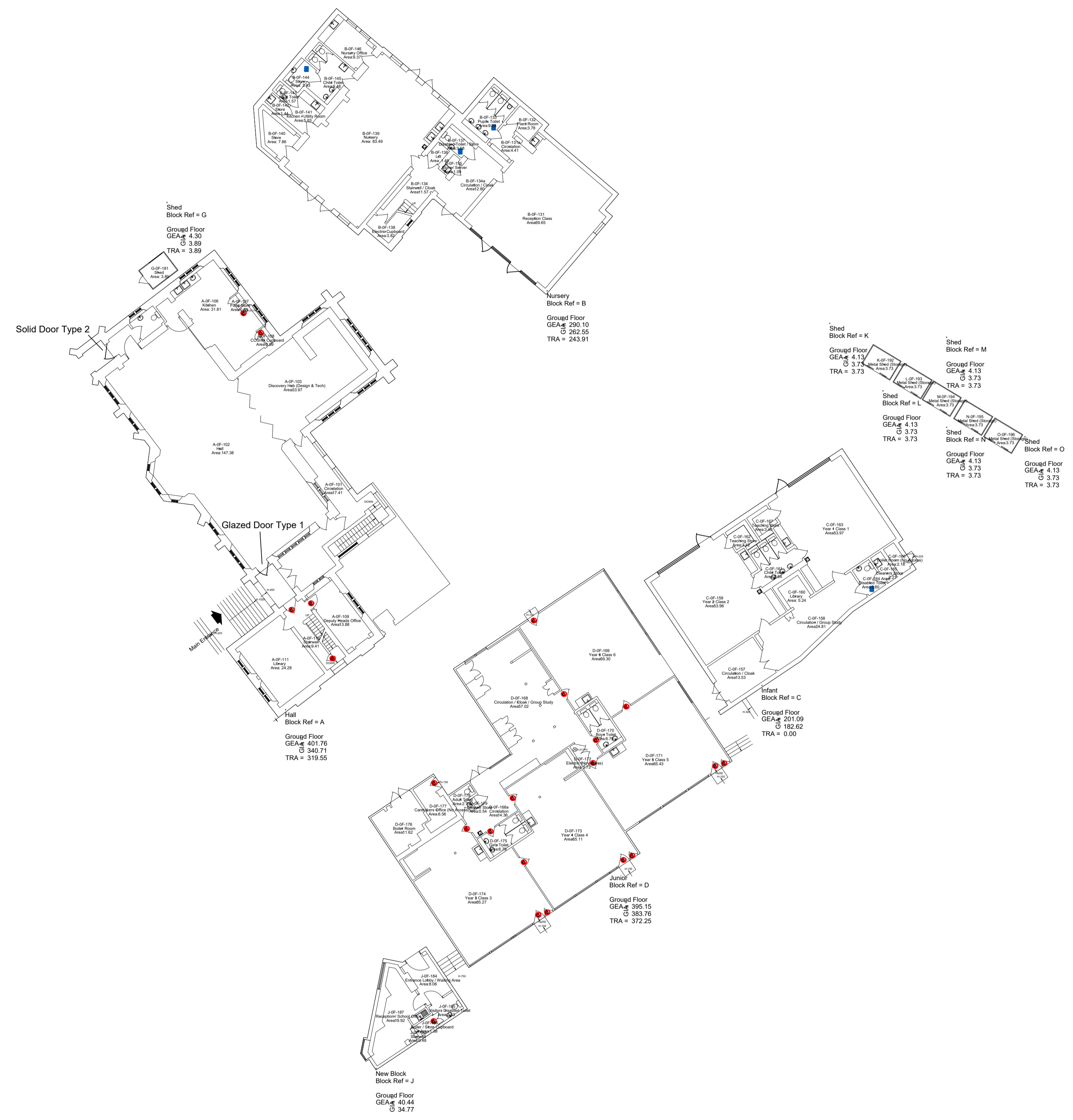
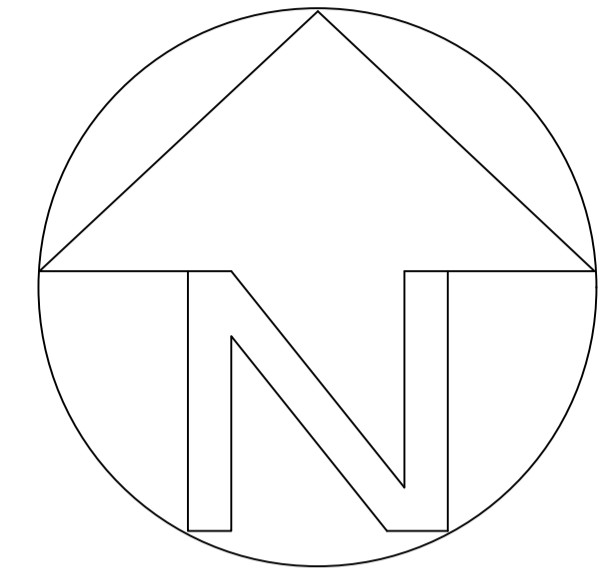

Fitzjohns Primary School

Windows and External Doors Replacement

CLIENT NAME LB of Camden		PROJECT Windows and External Doors Replacement	
PROJECT ADDRESS Fitzjohns Primary School 86A Fitzjohn's Ave London NW3 6NP		TITLE Site Plan	
SCALE NTS		DATE 15/10/2024	
NO/NO	APPROVED	DATE	DATE
35465	BGL	001	GF
001	GF	-	D
001	T	A	

BAILY GARNER

55 CHARLOTTE STREET
BIRMINGHAM B3 1PX
T: 0121 292 2239
E: birmingham@bailygarner.co.uk

The contractor is responsible to ensure that no products are to be utilised that do not comply with relevant British and/or European Standards and/or Codes of Practice, COSHH Regulations, Construction Regulations, or which are known or suspected at the time of product selection and/or construction to be deleterious to health and safety or to the durability of the work or not in accordance with good building practice.

The contractor is responsible for checking dimensions, tolerances, levels and references. This drawing/model is to be read in conjunction with all relevant Other Project Team Members' or specialist drawing/modelatory Federated Model. Any discrepancy is to be notified to Baily Garner LLP and is to be rectified before proceeding with the works on site or shop drawings. Where an item is covered by drawings to different scales, the larger scale drawing is to be worked to.

Any rights (including copyright) in this drawing/model and any proprietary work contained therein belong to Baily Garner LLP and may only be used in accordance with the licence granted to the Employer and with attribution to Baily Garner LLP.

The drawing to be read in conjunction with Document Suitability Codes page or at www.bailygarner.co.uk/discclaimer/

A1

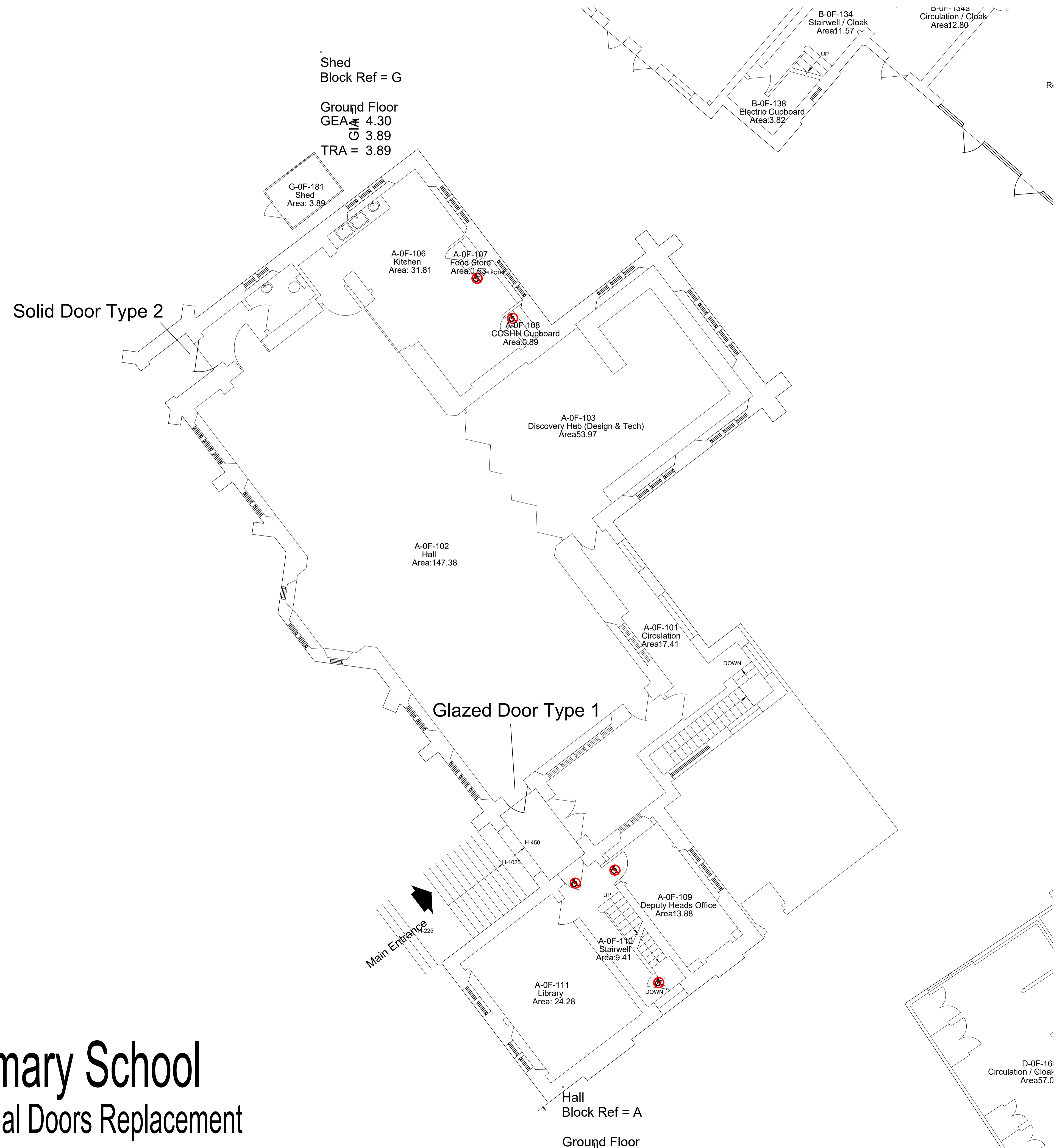

Fitzjohns Primary School

Windows and External Doors Replacement

CLIENT NAME LB of Camden		PROJECT Windows and External Doors Replacement	
PROJECT ADDRESS Fitzjohns Primary School 86A Fitzjohn's Ave London NW3 6NP		TITLE Plan View of Works	
SCALE NTS		SUITABILITY CODE Planning	
DRWN JF	CHKD SF	APPROVED RT	DATE 15/10/2024
PROJ 35465	ALOR BGL	VOLU 001	DESL GF
DCYF -	SOLE D	DRWNO 002	REVSTAT T
			REVISION A



BAILY GARNER

55 CHARLOTTE STREET
BIRMINGHAM B3 1PX
T: 0121 296 2238
E: birmingham@bailygarner.co.uk

The contractor is responsible to ensure that no products are to be utilised that do not comply with relevant British and/or European Standards and/or Codes of Practice, CDM Regulations, Construction Regulations, or which are known or suspected at the time of product selection and/or construction to be deleterious to health and safety or to the durability of the work or not in accordance with good building practices. The contractor is responsible for checking dimensions, tolerances, levels and references. This drawing/model is to be read in conjunction with all relevant Other Project Team Members' or specialist drawings/models/any Federated Model. Any discrepancy is to be notified to Baily Garner LLP and is to be rectified before proceeding with the works on site or shop drawings. Where an item is covered by drawings to different scales, the larger scale drawing is to be worked to. Any rights (including copyright) in this drawing/model and any proprietary work contained therein belong to Baily Garner LLP and may only be used in accordance with the licence granted to the Employer and with attribution to Baily Garner LLP. The drawing is to be read in conjunction with Document Suitability Codes page or at www.bailygarner.co.uk/dsd/stamer/

A1

All Dimensions to be checked on site

To match existing Door set style

Confirmation of Refurbished doors to be agreed

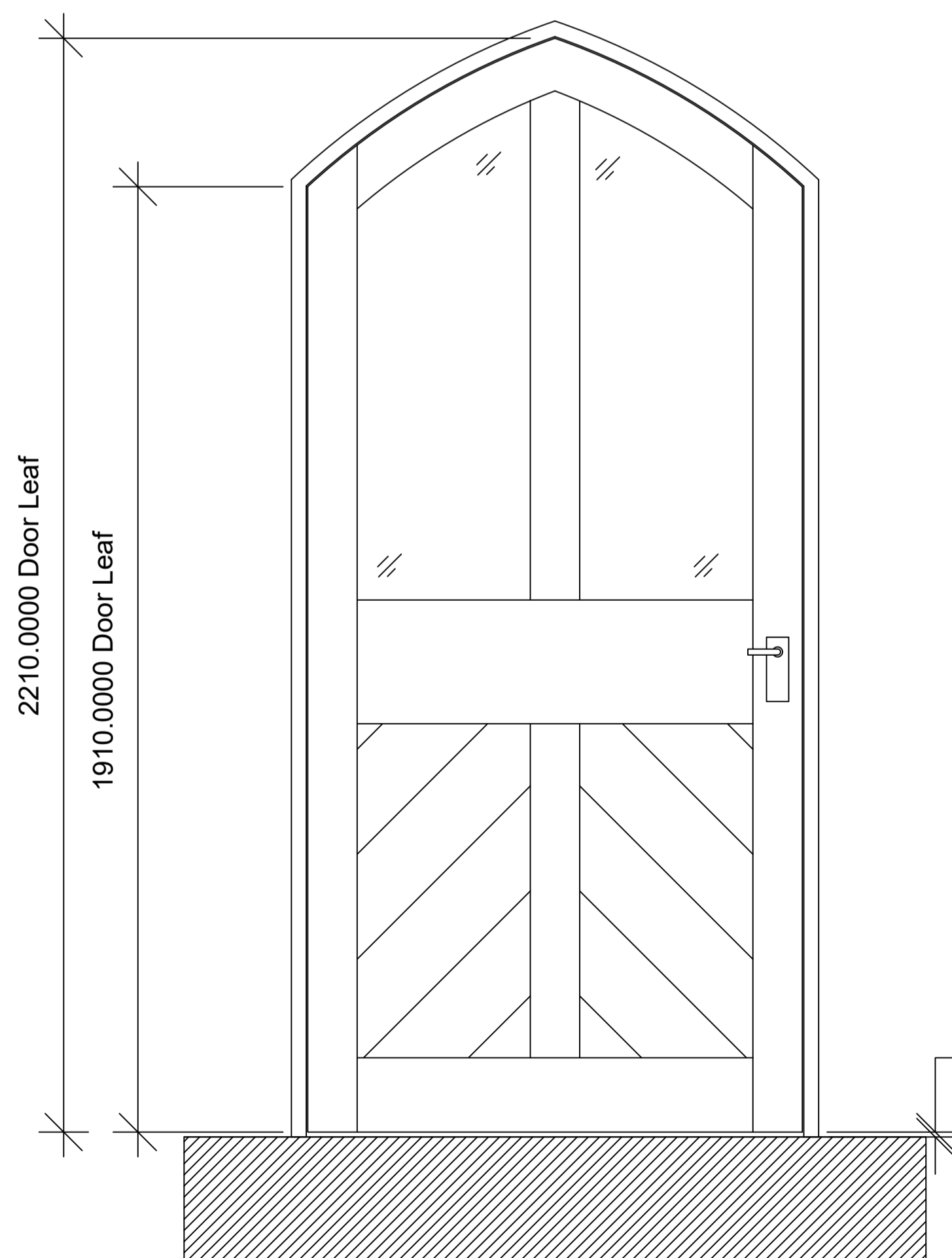
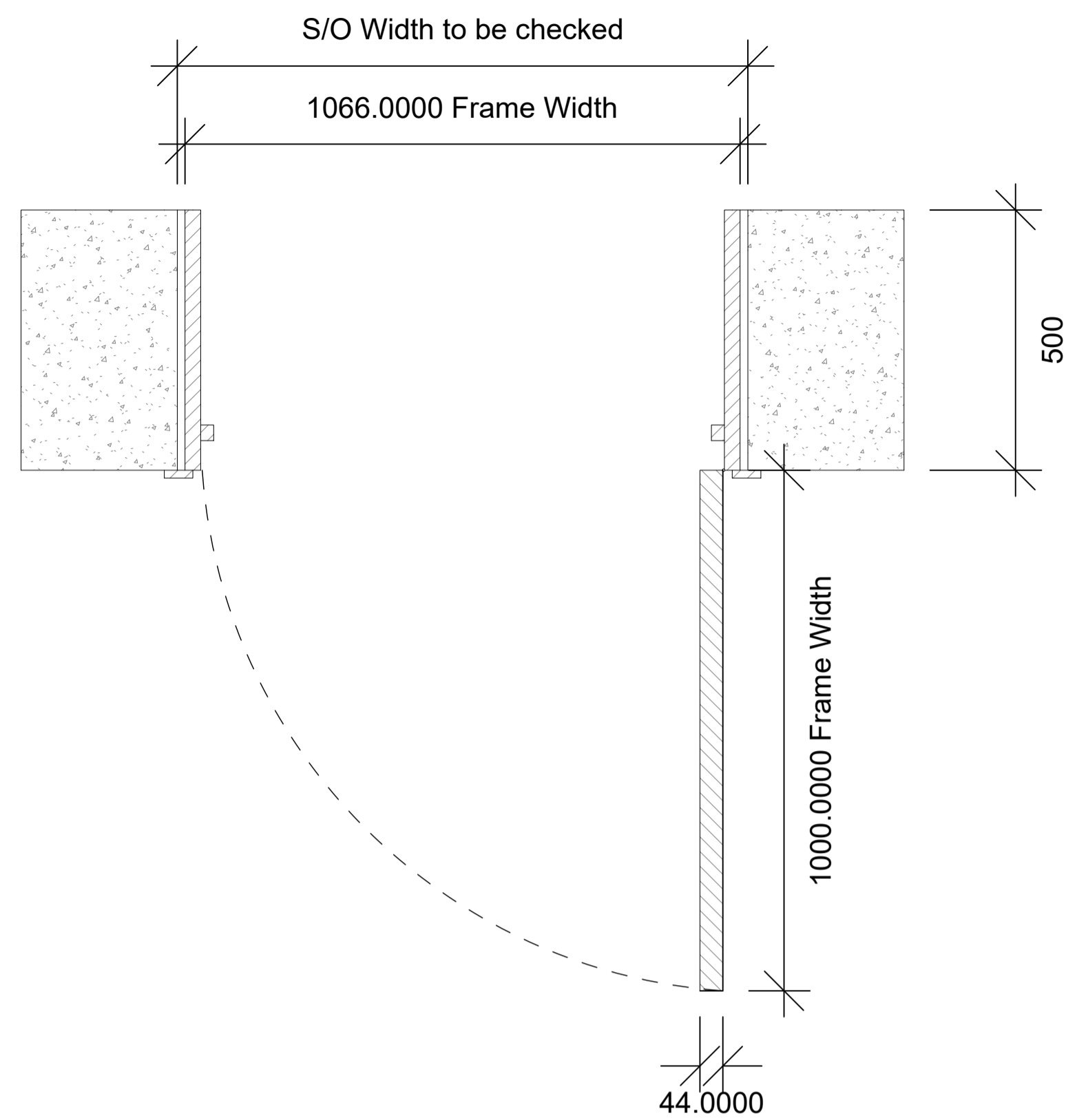

Front

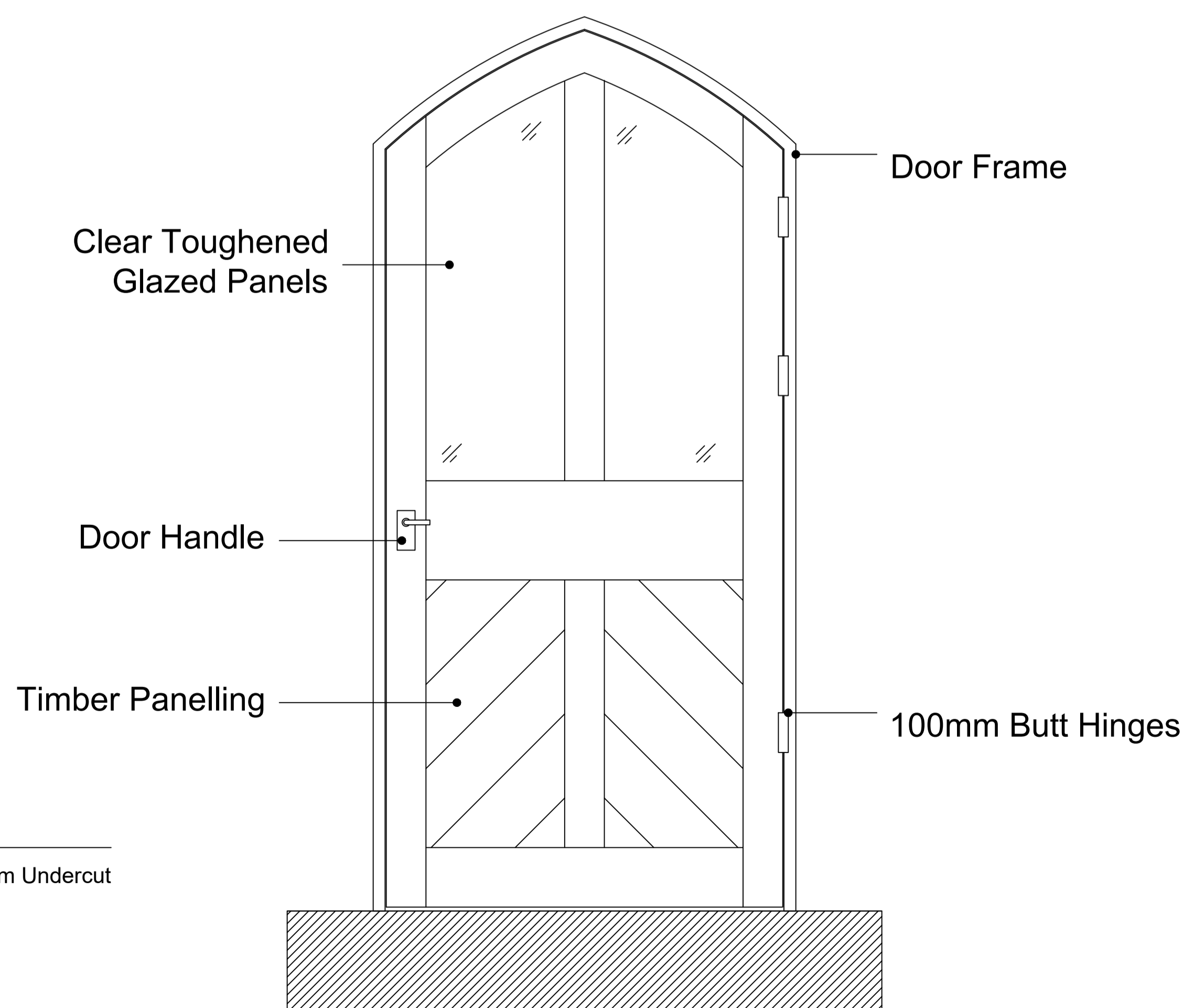

Back

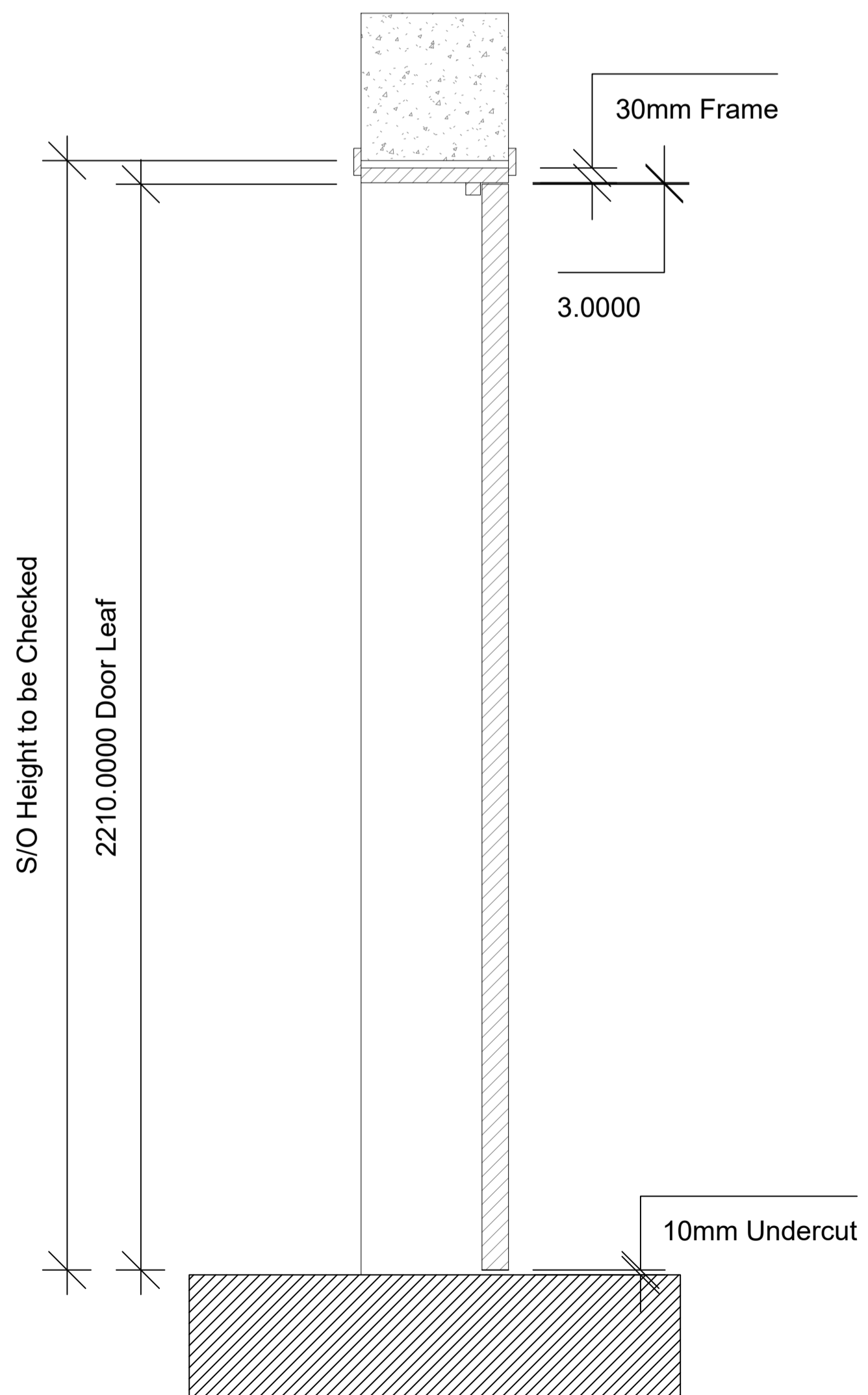

Side Section

Rev No	Description	D	C	DATE



LONDON HEAD OFFICE
145-148 ELTHAM HILL
LONDON SE18 5DY
T: 020 8294 1000
e: general@bailygarner.co.uk

CLIENT NAME

LB of Camden

PROJECT ADDRESS

Fitzjohns Primary School
86A Fitzjohns Avenue, London
NW3 6NP

PROJECT NAME

Windows and External Doors Replacement

DRAWING TITLE

Glazed Timber Door Replacement

Type 1

SUITABILITY CODE

Tender

SCALE	DRAWN	CHECKED	APPROVED	DATE
1:10	TS	JF	RT	15/10/2024
PROJ NO	AUTHOR	VOLUME	LEVEL	DOCTYP
35465	BGL	001	-	-
DRW NO	REV	STAT	REV NO	
D 003	T	A		

The contractor is responsible to ensure that no products are to be utilised that do not comply with relevant British and/or European Standards and/or Codes of Practice, COSH Regulations, Construction Regulations, or which are known or suspected at the time of product selection and/or construction to be deleterious to health and safety or to the durability of the work or not in accordance with good building practices.
 The contractor is responsible for checking dimensions, tolerances, levels and references. This drawing/model is to be read in conjunction with all relevant Other Project Team Members or specialist drawings/models/any Federated Model. Any discrepancy is to be notified to Baily Garner LLP and is to be rectified before proceeding with the works on site or shop drawings. Where an item is covered by drawings to different scales, the larger scale drawing is to be worked to.
 Any rights (including copyright) in this drawing/model and any proprietary work contained therein belong to Baily Garner LLP and may only be used in accordance with the licence granted to the Employer and with attribution to Baily Garner LLP.
 The drawing to be read in conjunction with Document Suitability Codes page or at www.bailygarner.co.uk/dsdstamer/

A1

All Dimensions to be checked on site
 To match existing Door set style
 Confirmation of Refurbished doors to be agreed

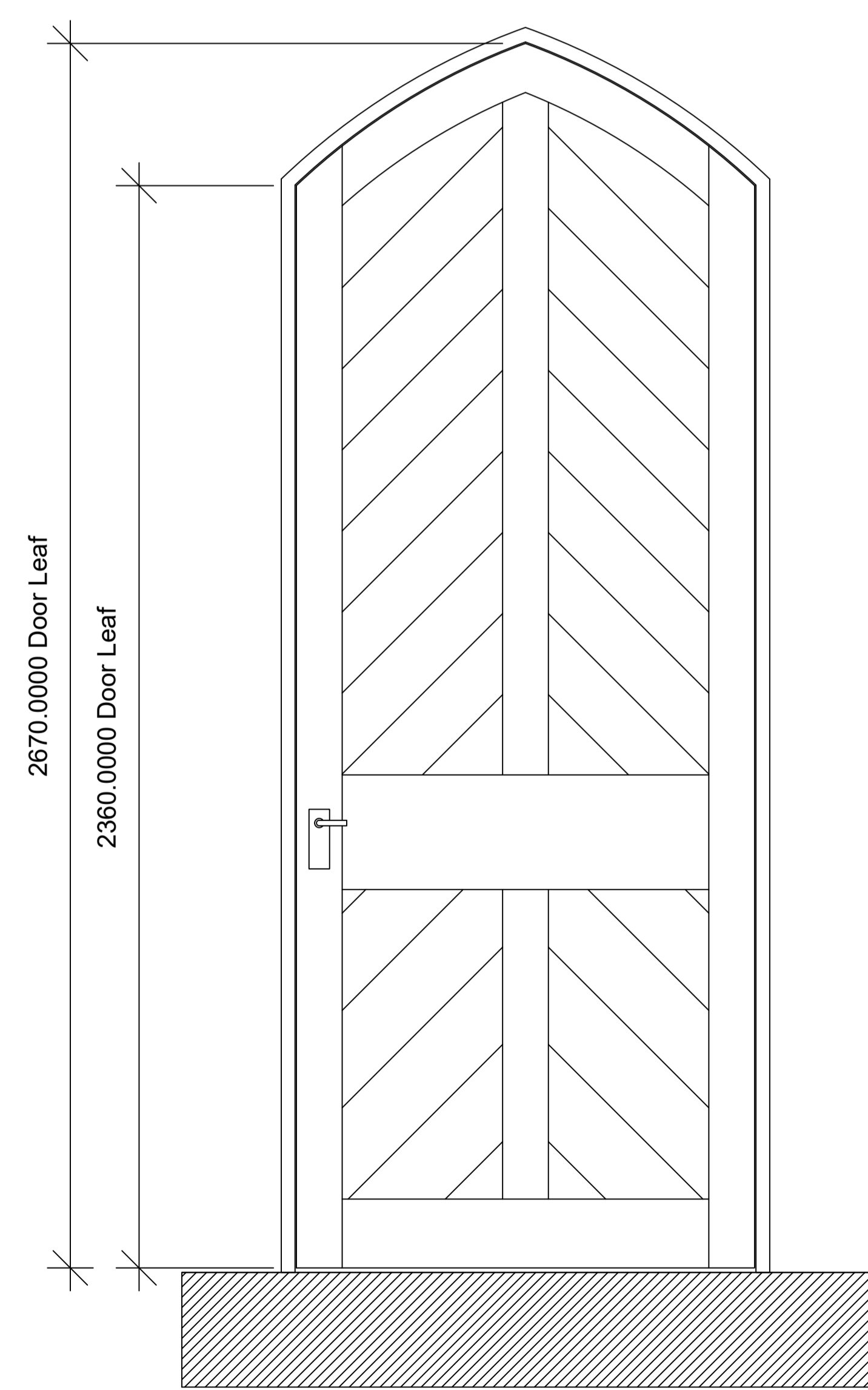
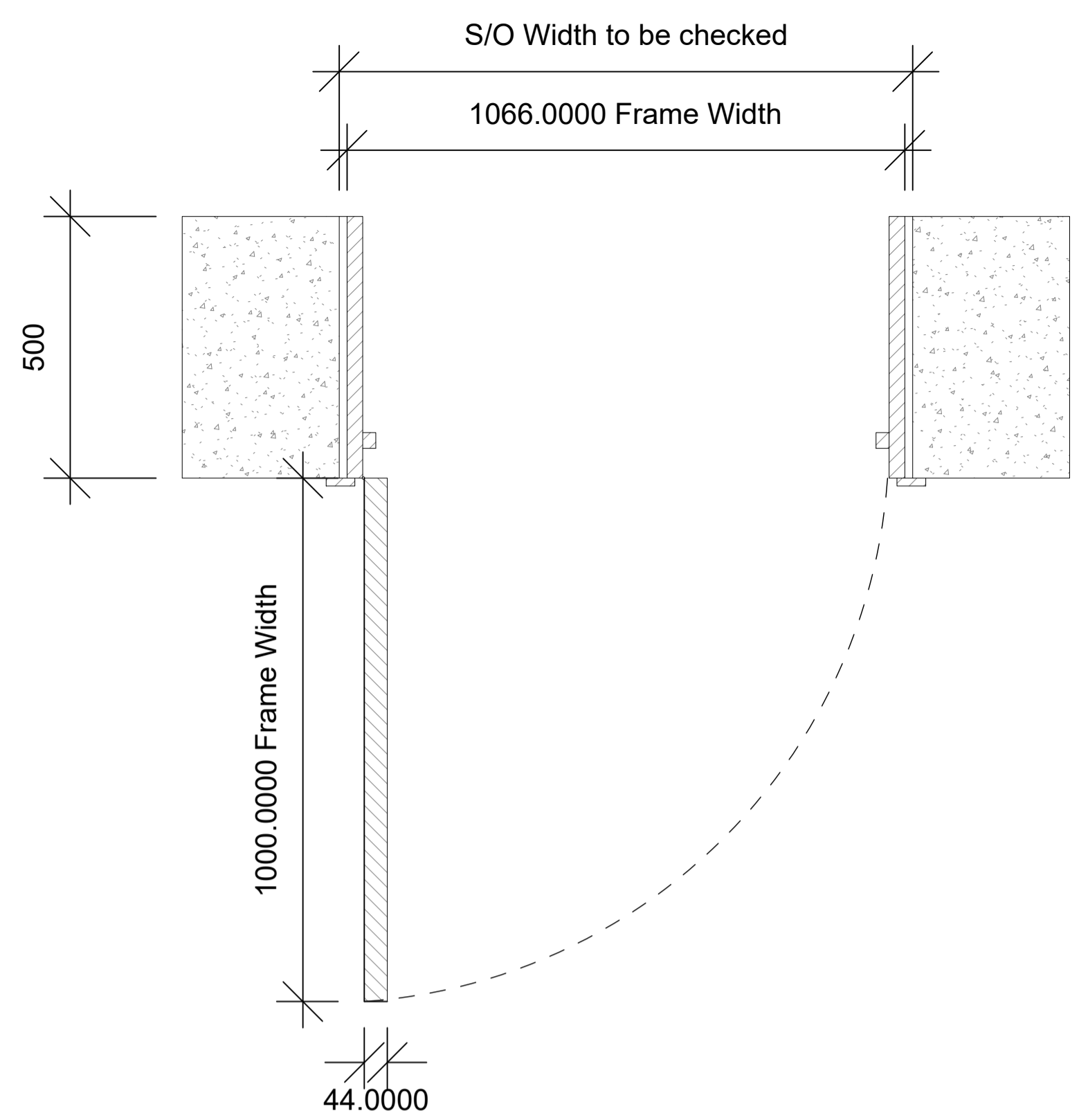

Front

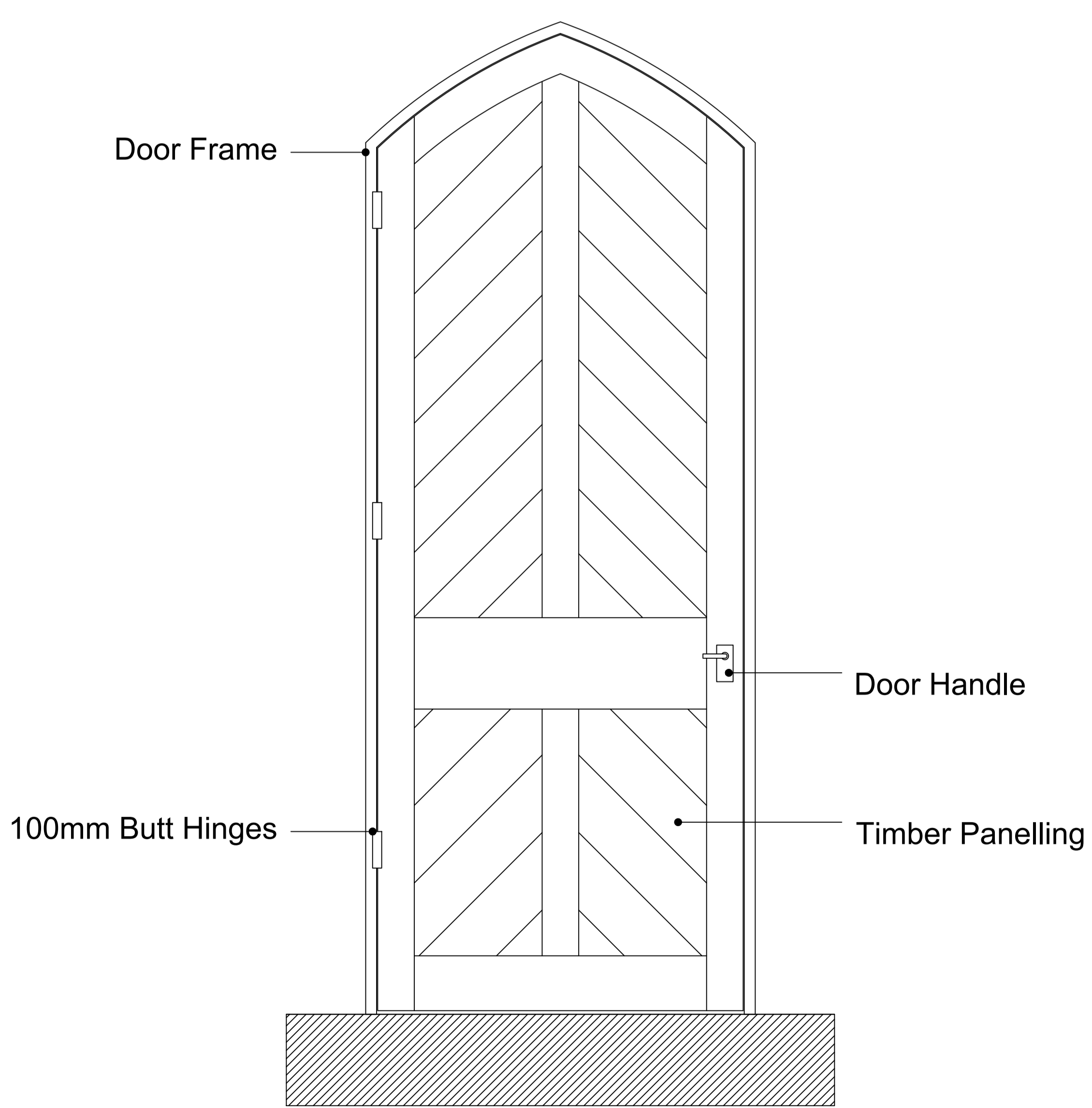

Back

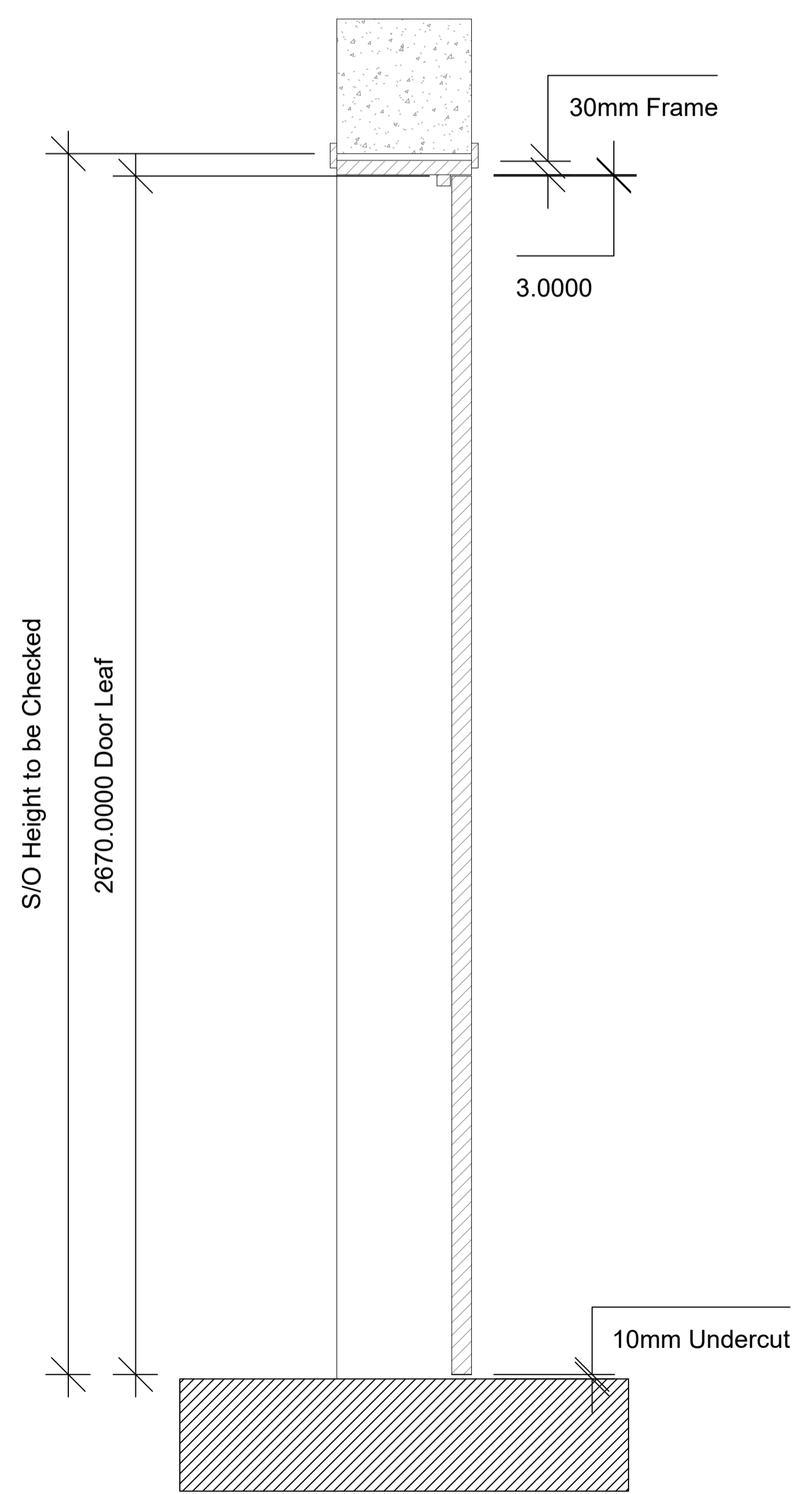

Side Section

Rev No	Description	D	C	DATE



LONDON HEAD OFFICE
 145-148 ELTHAM HILL
 LONDON SE18 5DY
 T: 020 8294 1000
 e: general@bailygarner.co.uk

CLIENT NAME
 LB of Camden

PROJECT ADDRESS
 Fitzjohns Primary School
 86A Fitzjohns Avenue, London
 NW3 6NP

PROJECT NAME
 Windows and External Doors Replacement

DRAWING TITLE
 Solid Timber Door Replacement
 Type 2

SUITABILITY CODE
 Tender

SCALE	DRAWN	CHECKED	APPROVED	DATE
1:10	TS	JF	RT	15/10/2024
PROJ NO	AUTHOR	VOLUME	LEVEL	DOCTYP
35465	BGL	001	-	-
DRW NO	REV	STAT	REV NO	
D 004	T	A		