

- Notes**
1. This drawing is to be read in conjunction with all relevant Architects and Engineer's drawings and specifications.
  2. All workmanship and materials are to comply with Specification, Building Regulations, relevant British Standard and manufacturers recommendations.
  3. All dimensions are in mm unless noted. This drawing is not to be scaled.  
For General Notes Refer to drawing 1550-GN01 to GN03

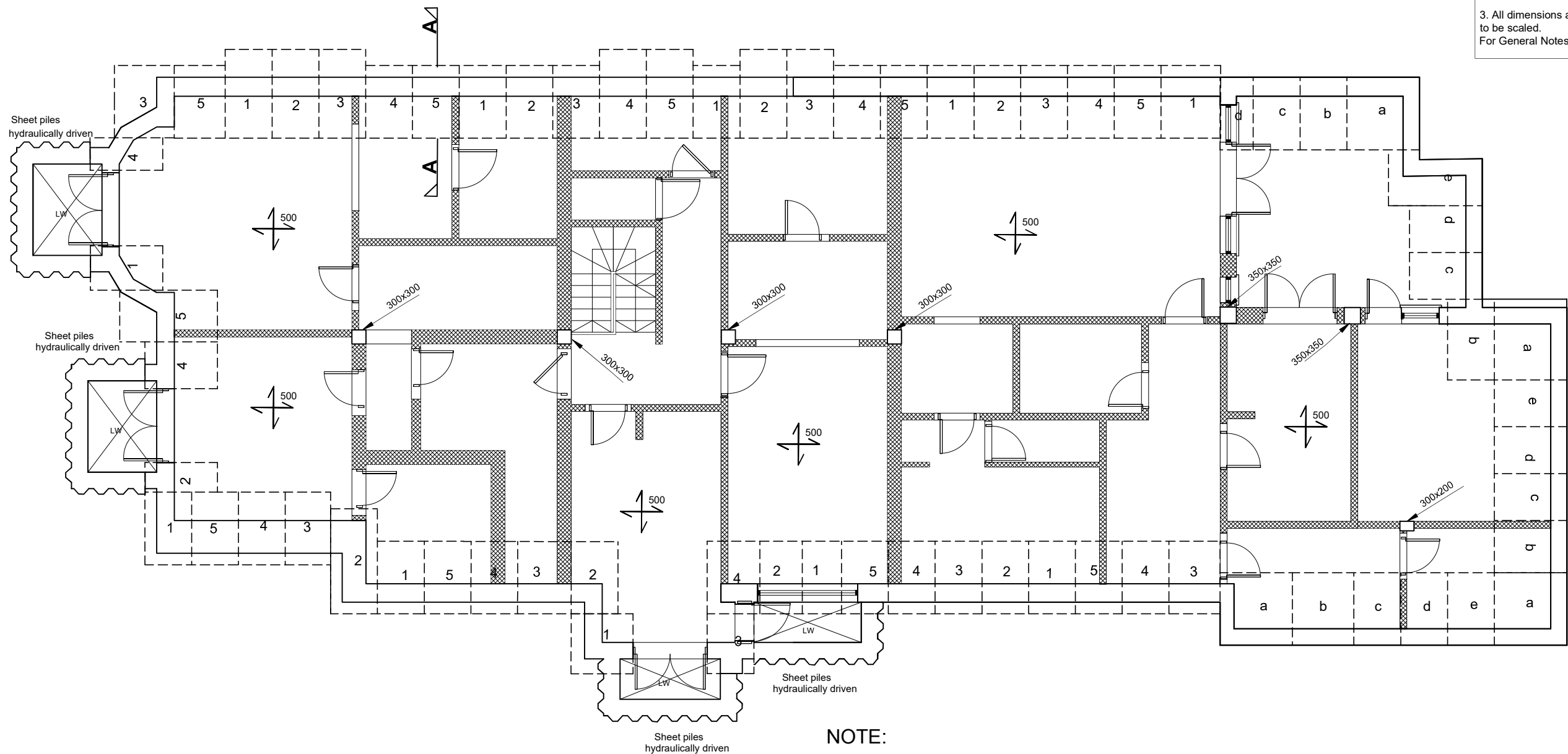

**NOTE:**  
Piles to be vibrationless press in piles. Giken or similar Impact driven piles are not permitted.

**Plan**  
(Scale 1: 100)

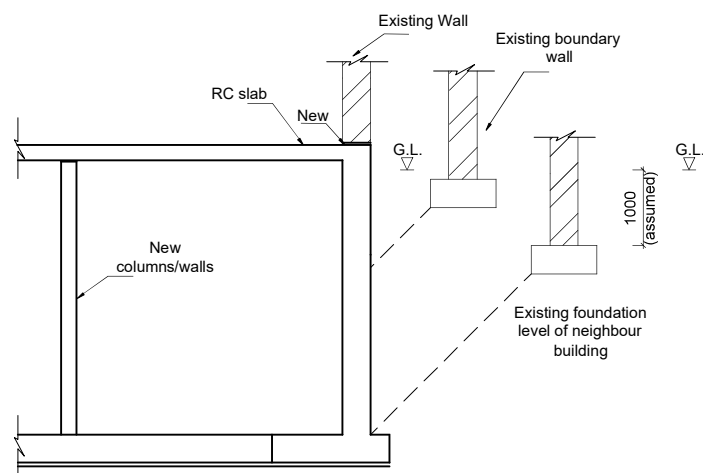

**Section A-A**



FOR PLANNING					
3	17/12/18	Piles noted as press in type	FD	SOH	
2	28/10/15	For planning	CM	SOH	
1	22/10/15	For planning	CM	SOH	
REV	DATE	DESCRIPTION	BY	CHKD	
CLIENT				DATE	
AMEK_PROPERTY_INVESTMENT_LL				OCTOBER_2015	
PROJECT				PRODUCED BY	
1_WADHAM GARDENS				CM	
LONDON_NW3_3DN				SCALE	
TITLE				A1_1:50 A3_1:100	
				CHECKED	
				SOH	
				APPROVED	
				ORIGINAL DRAWING SIZE A3	
				Quadrant Harmon Consulting Ltd.	
				Consulting Civil & Structural Engineers	
				Morley House	
				320 Regent Street	
				London W1B 3BD	
				Tel. 020 7637 2770	
				Fax. 020 7436 7823	
				JOB No.	
				1550	
				DRAWING No.	
				02	
				REV.	
				3	