



notes

When this drawing is issued in uncontrolled CAD format it will be accompanied by a PDF version and is issued to enable the recipient to prepare their own documents / models / drawings for which they are solely responsible.

The recipient should report all drawing errors, omissions and discrepancies to the architect. All dimensions should be checked on site by the contractor and such dimensions shall be the contractor's responsibility.

Allford Hall Monaghan Morris Limited accepts no responsibility or liability for:

- Any use of this drawing by parties other than the party for whom it was prepared or for purposes other than those for which it was prepared
- Any alterations or additions to or discrepancies arising out of changes to the background information on which the drawings are based that was current at the time of issue, and which occur to that information after it has been issued by AHMM
- Any loss or degradation of the information held in this drawing resulting from the translation from the original file format to any other file format or from the recipients reading of it in any other programme or any version of the programme other than that which was used to prepare it
- The accuracy of survey information provided by others or for any costs, claims, proceedings and expenses arising out of reliance on such information

Any scaling from this drawing other than by the local planning authority solely for the purposes of the planning application to which it relates

The drawing shows the general arrangement together with the nominal sizes of selected elements and components. The information shown indicates the design intent of the architect and is to be read in conjunction with the performance specification. The Contractor must include for all design development and coordination required to complete the works.

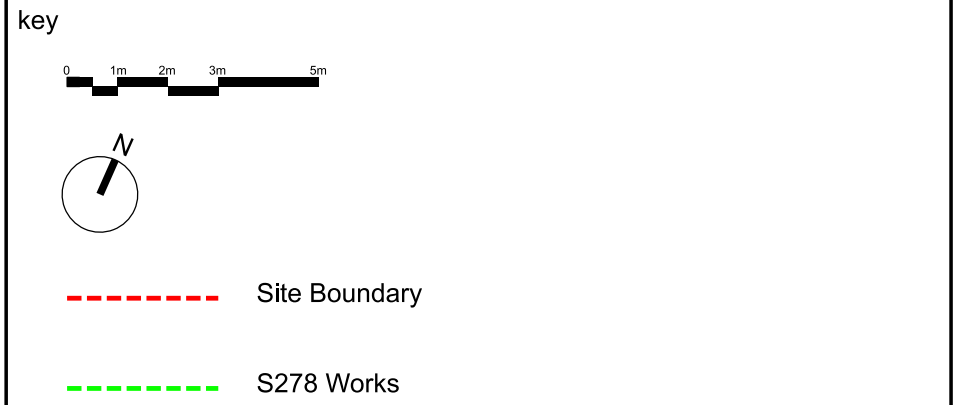

P02	PL	10/10/24	For Planning Issue
P01	PL	30/09/24	For Planning Issue
P00	PL	14/02/24	For Planning Issue

Rev	Status	Date	Description
-----	--------	------	-------------

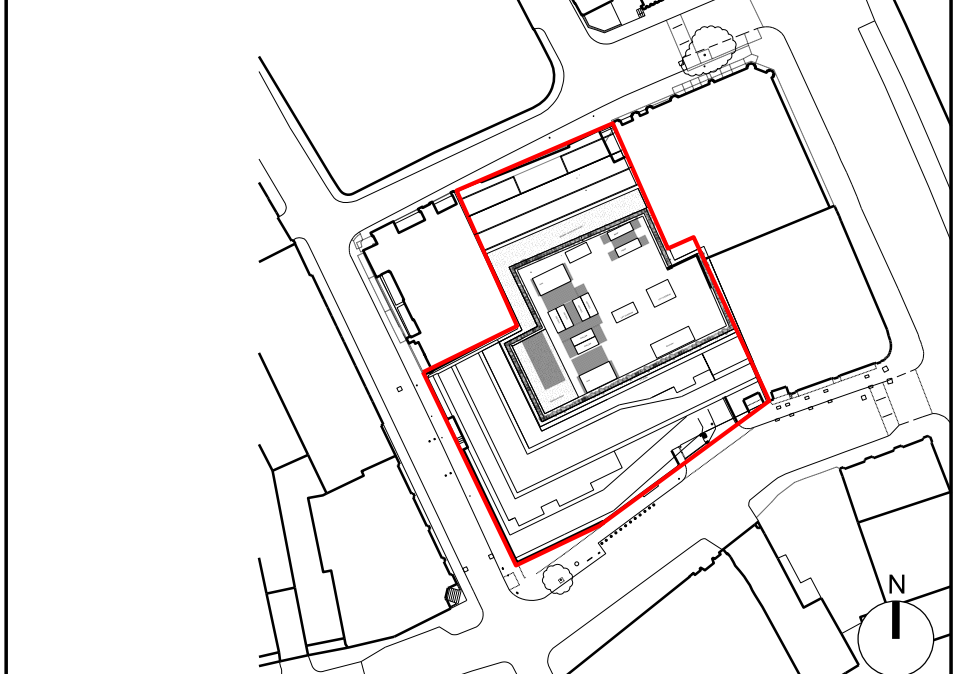

ALLFORD HALL MONAGHAN MORRIS
ARCHITECTS Ltd.
MORELANDS, 5-23 OLD STREET LONDON EC1V 9HL
TEL 020 7251 5261 FAX 020 7251 5123 WEB WWW.AHMM.CO.UK

client
Saffron Hill Investment Holdings Ltd

project name
SAFFRON HILL

drawing title
PROPOSED PLAN, LEVEL 05

drawn	checked	scale	wp	stage	status	revision
NE	BB	1:150@A1	00	02	PL	P02
project	originator	volume	level	type	role	drawing no.
22068	AHMM	ZZ	05	DR	A	PL105

Allford Hall Monaghan Morris Limited