

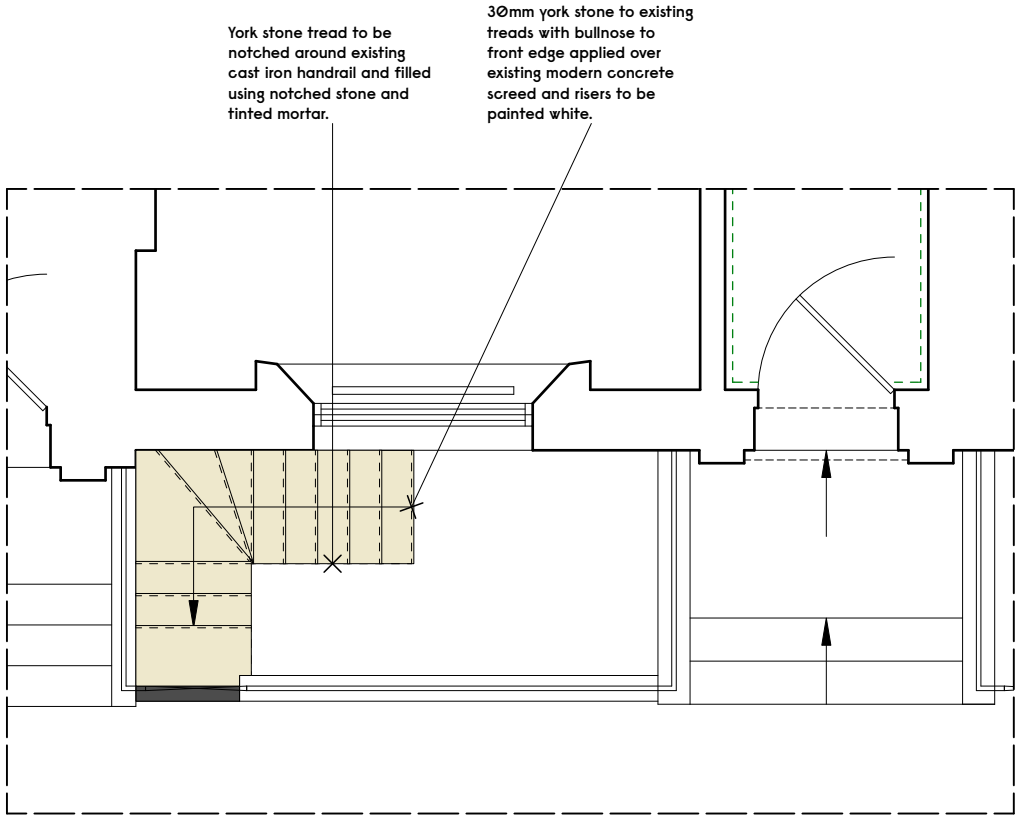

No. 8 Rothwell Street
Basement steps overlaid with York Stone



Specification
York Stone supplies - 30mm Hebden York stone to existing treads with bullnose to front edge of tread



1 Proposed Plan
1:50 @ A3



2 Proposed Front Elevation
1:50 @ A3



3 Elevation Key
1:200 @ A3



Notes

Revision Date Description

Gundry + Ducker

Gundry & Ducker Architecture Ltd
3 Garrick Street
London WC2E 9BF

t +44(0)203 417 4895
info@gundryducker.com

Do not scale. All dimensions to be confirmed on site.
Information contained in this drawing is the sole copyright of the designer
and is not to be reproduced without permission.

Project 3 Rothwell Street, London NW1 8YH

Drawing title Proposed Plan & Elevation

Scale 1:50 @ A3 Drwg. No. Rev

Date 10/2024 405_PL_03 -

Status PLANNING



1:50 @ A3