

ITEM 1

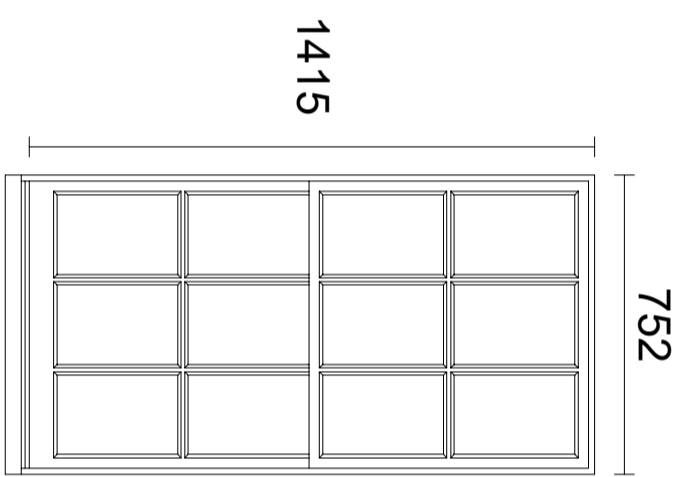

ITEM 2

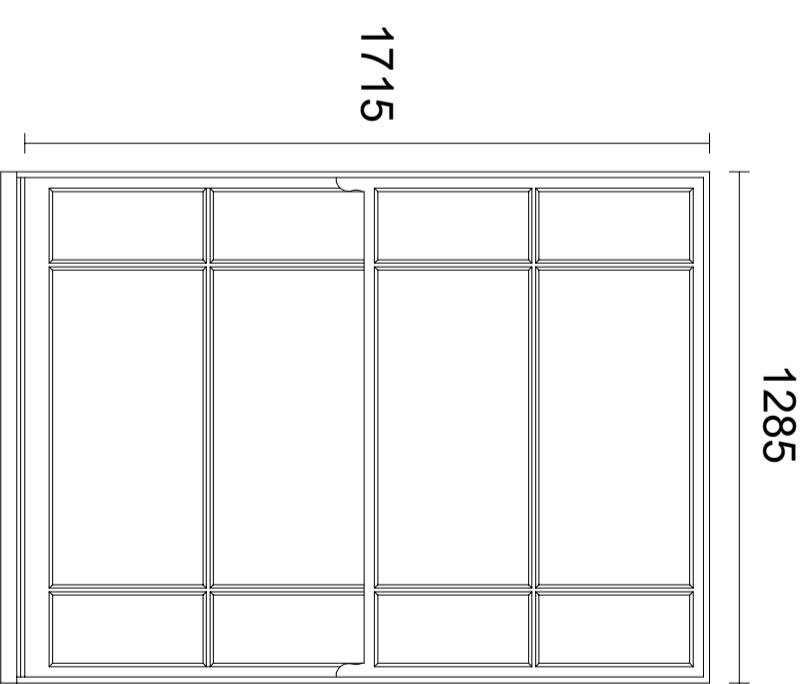

ITEM 3

NOTES

Existing boxes retained and repaired as necessary.

New sashes to be made from PEFC Sapele glazed with slimline double glazing and face puttied externally, and painted white externally to match existing.

All sizes, sections and mouldings to match existing windows unless otherwise required by Conservation Officer.

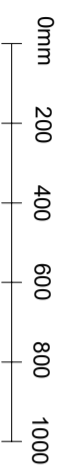

SCALE BAR 1:20

Ventrolla Ventrolla House Crimple Court Hornbeam Park Harrogate HG2 8PB	Notes: All dimensions must be checked on site.	Client: Lindsey Anderson	Scale: 1:20 @ A3	Drawing Title: Proposed External Elevations - Items 1, 2 & 3
		Job Title: 16 Leventon Street, London	Drawn By: SM	Drawing Number: 16/LS/L/02
			Date: August 2023	Rev: