



LEGEND:

-  Existing brickwork wall or internal partition
-  Element / detail hidden from view
-  Property boundary line

NOTES:

- 1- All replacement casement and sash windows to match existing glazing subdivision composition.
- 2- See document "Sash Window - plan and section detail" for clarification of sash windows components dimensions.
- 3- Structural glazing bars for casement windows, doors, and fixed screens to match those of the sash windows.

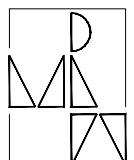
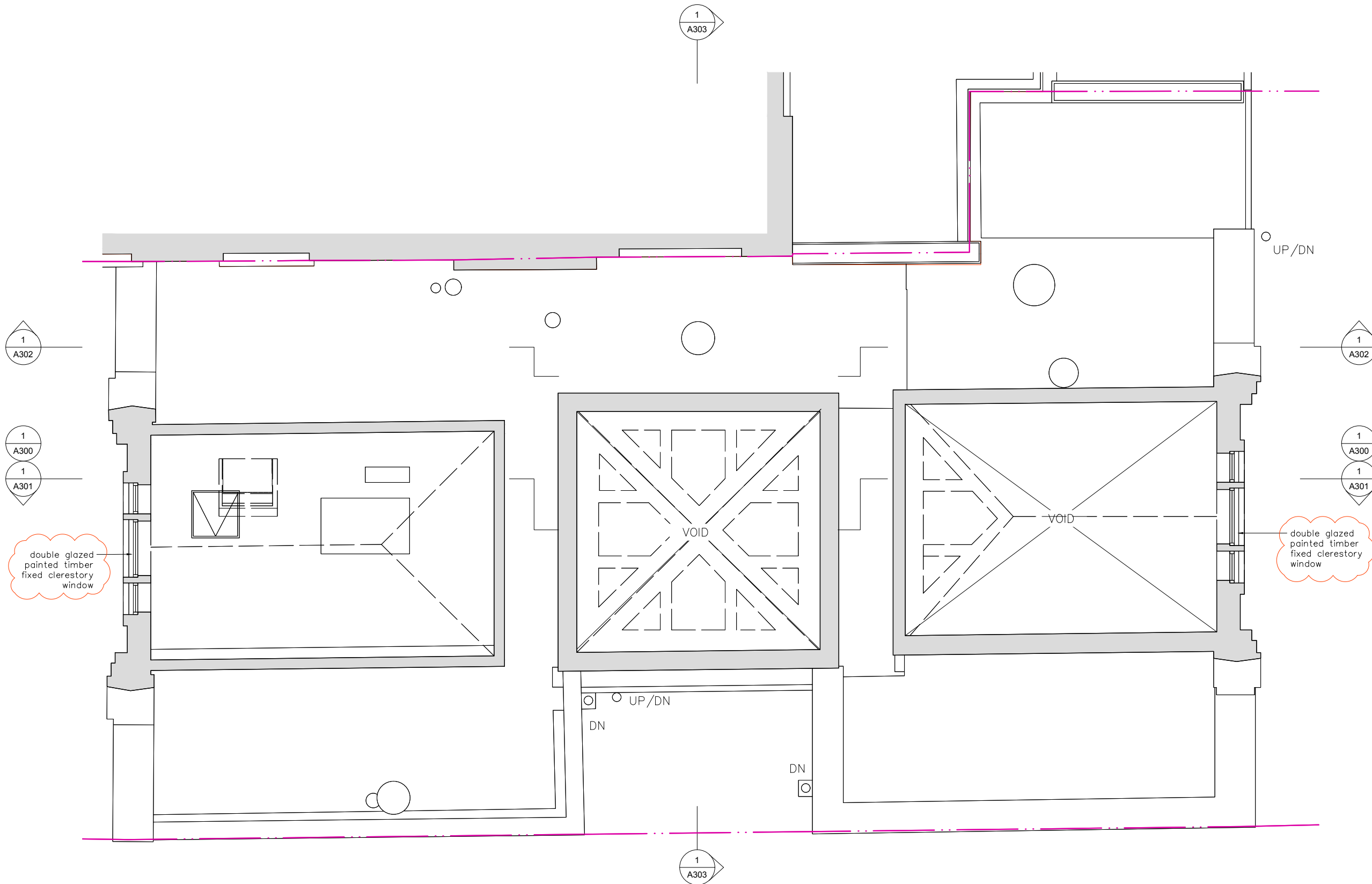

Maryse Renier Architecture
 61 Compayne Gardens, Flat C, London NW6 3DB
 M: (+44) 077 6317 2322 - E: mrenier@maryserenier.com

COPYRIGHT:

The design and drawings remain the property of Maryse Renier. The client for this project will be licensed to use this design and documents on this site only upon full payment of architectural fees. This licence is non-transferable. The design and drawings shall not be reproduced, up-loaded to the internet or traced without the permission of Maryse Renier.

DIMENSION NOTES:

All the dimensions indicated in this set are in mm based on survey drawings prepared by specialist consultant commissioned by the Client. It is VERY IMPORTANT that all dimensions are checked carefully before any work commences or any materials are ordered. If any discrepancies are noticed between these drawings and any other contract document then, please, contact M. Renier immediately.

2304

JOB NO:

STAGE 3

37

DWG NO:

UR

DRAWN BY:

43a LANCASTER GROVE

PROJECT NAME:

PLANNING

RELEASE:

MR

CHECKED BY:

PROPOSED SECOND FLOOR PLAN 1

1:50 @ A3

SCALE:

**SECOND FLOOR
 PROPOSED PLAN**

4 OCT 2024

DATE:

0 500 1000
 mm

P2-S3-A102-1