

General Notes:  
 This drawing is to be read in conjunction with all other issued information incl. architect's and structural engineer's drawings and specifications.  
 Report any discrepancies to the architect.  
 Copyright Adam Richards Architects

KEY

1. Existing window cill lowered to reinstate door
2. New conservatory replaces existing bank and terrace
3. External stairs reinstated
4. New timber framed glazing
5. Coach House
6. New external wall to match appearance adjacent wall
7. New handrail to match adjacent
8. New timber framed french door replcaes unoriginal glazed doors. Style/ materiality and height to match doors on the main house. The outer panes become side lights with reduced glazing to bottom panels to give a sese of a reduced opening
9. Rustication reintroduced to facade

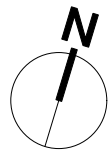

Revision	Date	Description
1	29/11/2022	First issue
2	14/12/2022	Revised issue for Pre-App
3	10/05/2024	Planning
3	26/09/2024	Planning

**DRAFT**

**ARA** Unit 1  
 1 Rufus Street  
 London  
 N1 6PE  
 England  
 02076135077  
 www.adamrichards.co.uk

Project: Park Village West  
 Job No: 21-08

Drawing: NorthEast Elevation-Proposed

Scale: 1:100@A3  
 Date: 26/09/2024  
 Status: Planning  
 Drawn: TE  
 Checked: AR

Number: 21-08-211 Rev: P04

NorthEast Elevation - Proposed



scale bar 1:100@A3

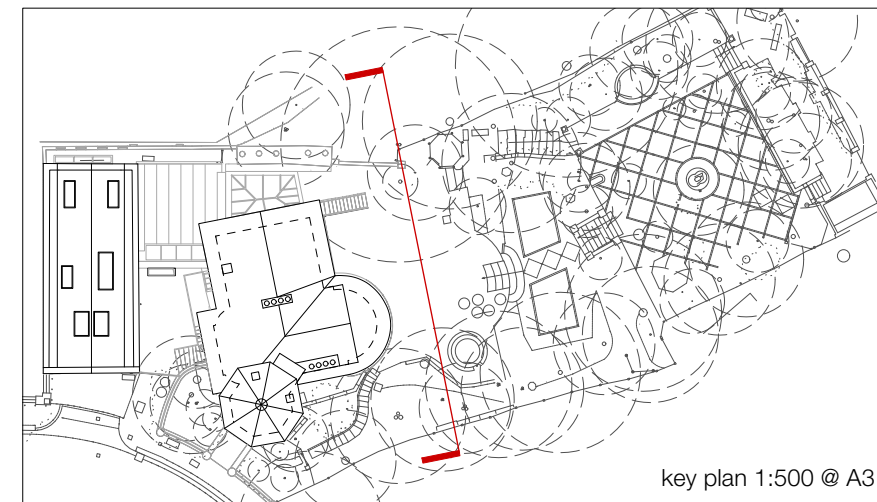

key plan 1:500 @ A3