

KEY:

- ▽ Floor Level
- △ Ceiling Level
- svp Soil and Vent Pipe
- rwp Rain Water Pipe
- ic Inspection Cover
- cl Cover Level
- u/s Underside Height
- BH 2000 Beam Height
- AH 2500 Arch Head
- SPR 1800 Spring Point
- FS 0780 Floor to Sill
- SH 1850 Sill to Head
- Drainage
- - - Boundary Line
- - - Above
- New Structure(130mm)/Insulation(215mm)
- Joinery
- Free-standing Furniture
- ▭ Radiator
- ⊙ Section Marker

- Upper Floor Flat GIA
- Area at 2.5m high and above

Total Upper Floor Flat GIA on SF: 28m²
 Upper Floor Flat GIA on SF at 2.5m high and above: 3m²

Total GIA of Upper Floor Flat: 100m²
 Total GIA of Upper Floor Flat at 2.5m high and above: = 75% of GIA

Refer to P100, P110 & P120

(BELSIZE LANE) BELOW

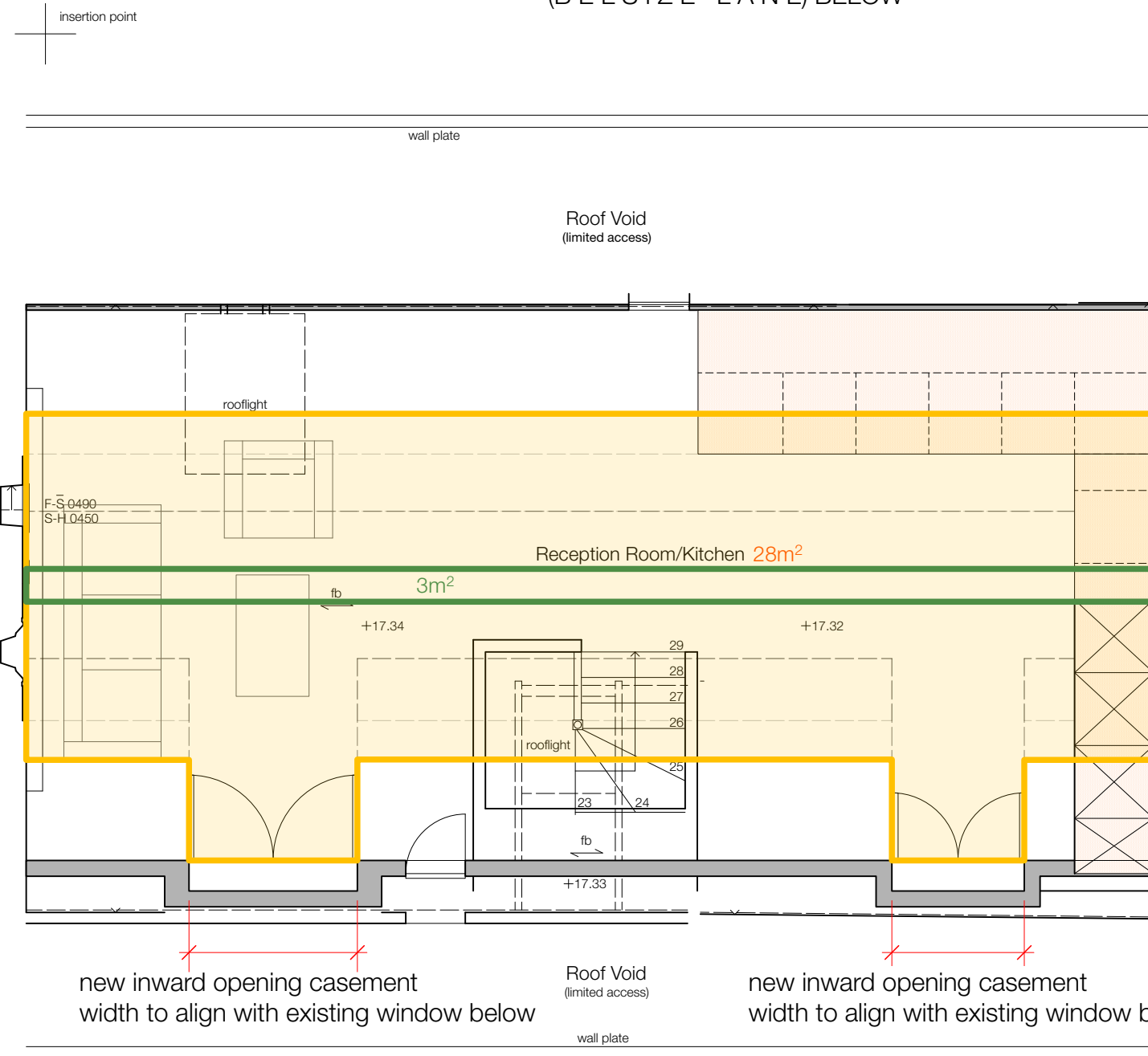

new inward opening casement
width to align with existing window below

new inward opening casement
width to align with existing window below

(BELSIZE COURT GARAGES) BELOW

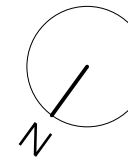

TITLE: Second Floor Plan (as built) PROJECT: 4 Belsize Court Garages, London	NO: P120 REV: PL2	DATE: 01 October 2024	PAPER: A3 SCALE: 1:50	SANYA POLESCUK ARCHITECTS 8a BELSIZE COURT GARAGES LONDON NW3 5AJ T:0207 431 8580 e-mail:enquiries@polescukarchitects.com
---	------------------------------------	------------------------------	--	--