

SOUTHAMPTON ROW

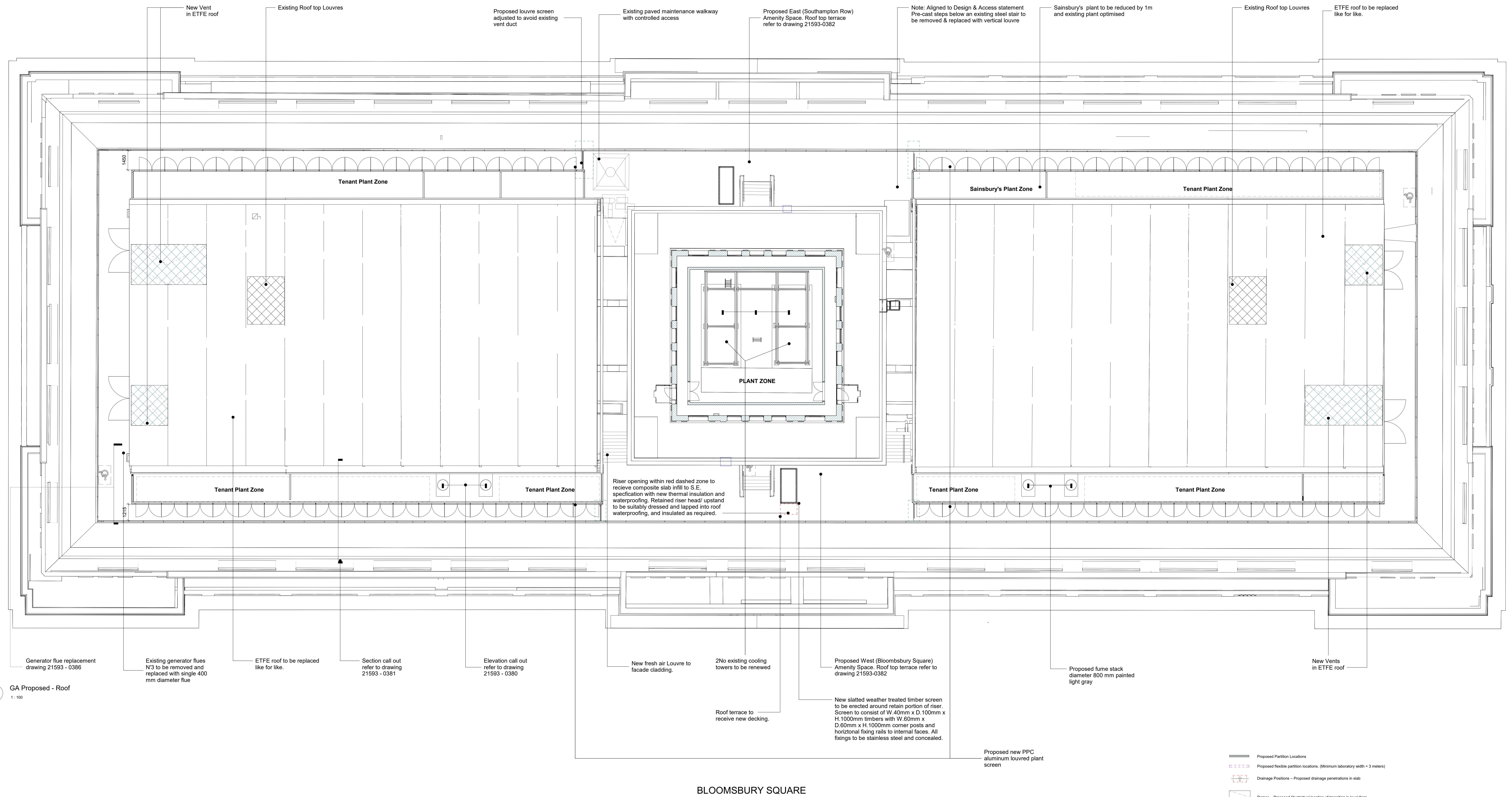

BLOOMSBURY SQUARE

1 GA Proposed - Roof
1:100

- Proposed Partition Locations
- Proposed flexible partition locations. (Minimum laboratory width = 3 meters)
- Drainage Positions - Proposed drainage penetrations in slab
- Ramps - Proposed 'illustrative' location of transition in level from slab to raised access floor. Location dependent on final tenant fit out.

Note
For all items being removed, please refer to demolition drawings 21593-0340 - 0356
Existing services in modernised areas to be altered, refer to services consultant drawings and reports for details.

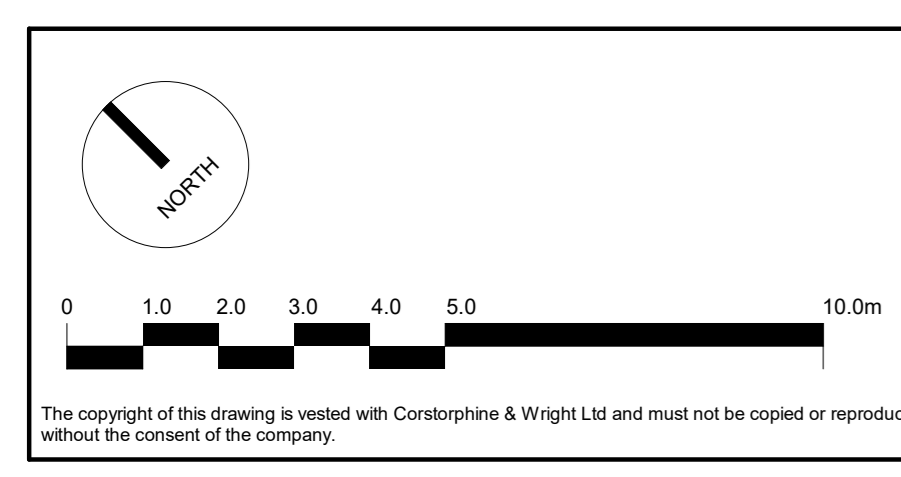

Rev.	Description	Date	Drawn	Checked
P-03	PLANNING AMENDMENTS TO RISER	25/09/2024	TJ	MS
P-02	PLANNING AMENDS	11/10/2022	TI	RS
P-01	PLANNING REVISED	26/09/2022	TI	RS
P-00	FOR PLANNING	01/07/2022	RS	ATJ

Planning Legend Key	
	Indicated location of proposed security gates
	Indicated area of existing riser to be cut back to improve access.
	Existing Building
	Location of additional disabled call point

Client: Oxford Victoria House Ltd.		Corstorphine & Wright	
Project: Victoria House		London Studio 21-27 Lamb's Conduit Street, Holborn, London, WC1N 3NE 020 7464 9000 corstorphine-wright.com	
Drawing Title: Proposed - Roof Plan	Drawing No: 21593-CWA-VH-A-0336	Revision: P-03	Revision
Drawing Status: PLANNING	Drawn: ATJ	Checked: RS	Paper Size: A0
	Scale: 1:100	Date: 22/07/2022	