

Bike storage lockers
27 no. spaces.

Reduced ceiling height
below ductwork.

Sheffield hoops
28 no. spaces.

Semi-vertical inclined racks
140 no. spaces.

Cycle store amended from
consented scheme
2021/2775/L
2021/2775/P.

Downstand beams with
reduced ceiling height.

Goods lift.
Passenger lift.

Proposed Accessible Shower

Amended WC / Showers proposed.
Female amended from consented scheme
2021/2775/L
2021/2775/P.
Proposed arrangement to include; 7 showers,
1 WC and 1 accessible shower

Proposed plant room

1 Cycle Storage -Proposed
1 : 100

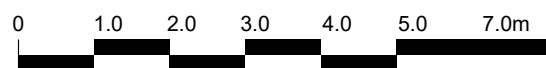
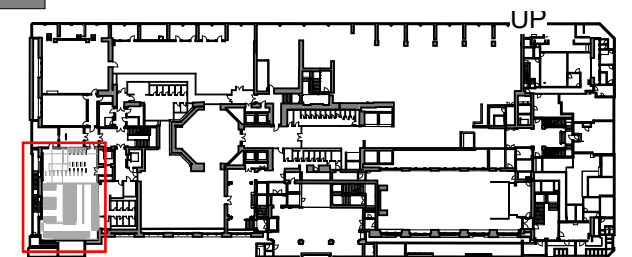

The copyright of this drawing is vested with Corstorphine & Wright Ltd and must not be copied or reproduced without the consent of the company.

P-00	FOR PLANNING	01/07/2022	RS	ATJ
	Rev. Description			
		Date	Drw.	Chk.

Client
Oxford Victoria House Ltd.

Project
21593 - Victoria House

Drawing Title
Cycle Store Proposed

Drawing Status
CONSENTED

Corstorphine & Wright

London Studio
One Mortimer Street, London, W1T 3JA
020 7842 0820
corstorphine-wright.com

Drawing No. 21593-CWA-VH-A-0389		Revision P-00	
Drawn TI	Checked RS	Paper Size A3	Scale As indicated
Date 20/07/2022			