

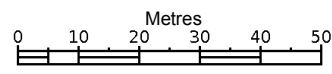

Produced 23 Jul 2018 from the Ordnance Survey MasterMap (Topography) Database and incorporating surveyed revision available at this date.

The representation of a road, track or path is no evidence of a right of way. The representation of features as lines is no evidence of a property boundary.



1:1250

Supplied by: **Stanfords 23 Jul 2018**  
Licence: © Crown Copyright and database rights 2018 OS100035409  
Order Licence Reference: OI1249101  
Centre coordinates: 528630 186113

6, Laurier Rd, London  
NW5 1SG

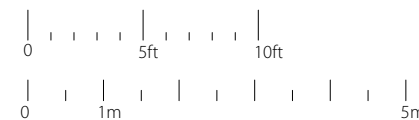
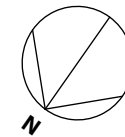
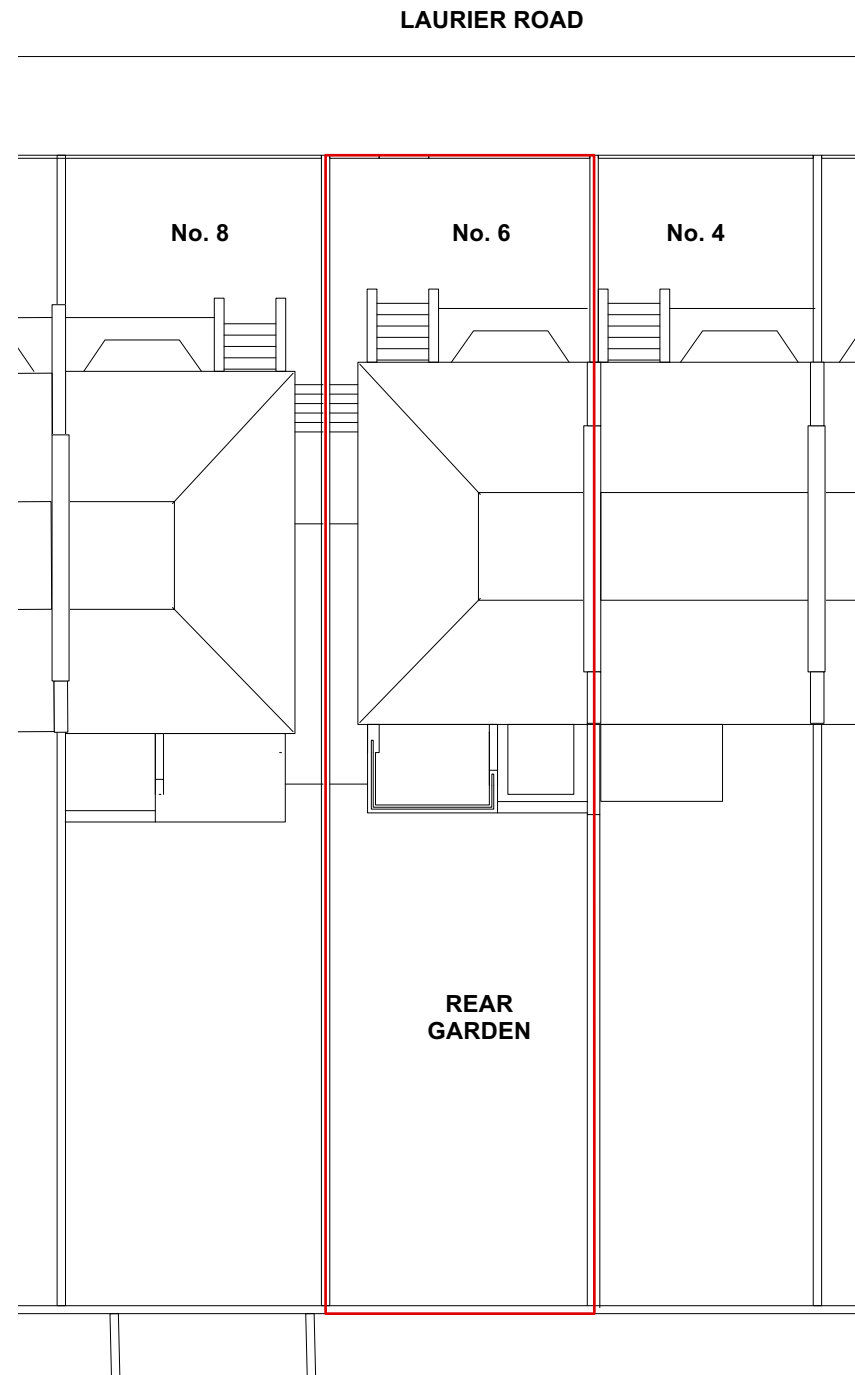

Notes

Revisions By Authorised

**CMA**  
Ciarcelluti Mathers Architecture

Unit 1, 1 Ghent Way  
London E8 2PE  
Tel: +44 (0)20 7254 7470  
Email: mail@studiocma.co.uk

**Client**  
Virginia Kerridge and Robert Sumerling

**Project**  
6 Laurier Road, NW6 1SG

**Title**  
LOCATION MAP and BLOCK PLAN

**Scale**  
1:1250 and 1:200 @ A3

**Drawn** **Checked** **Authorised**

**Date** **Issuing Discipline**  
30/09/24 ARCHITECTURE

**Issue status**

**Planning**

**Drawing number** **Rev**  
**P161 / PD / 01** -

**Important note**  
Where dimensions are not given, drawings must not be scaled and the matter referred to the architect.

In the event of any detail or dimensional conflict between the architectural drawings, the matter must be referred to the architect for clarification.

© Copyright 2024 - Ciarcelluti Mathers Architecture Ltd.