

# Corstorphine & Wright

## Development Management

Regeneration and Planning  
London Borough of Camden  
Town Hall  
Judd Street  
London  
WC1H 9JE

20<sup>th</sup> September 2024

Dear Sir/Madam,

### RE: **Listed Building Consent Reference 2024/2076/L**

This design note has been put together to support the discharge of Condition 5 in reference to the Listed Building Consent Application referred to above.

The condition states:

*Details of all secondary glazing shall be submitted to and approved by the LPA prior to installation.*

*Reason: In order to safeguard the special architectural and historic interest of the building in accordance with the requirements of policy D2 of the Camden Local Plan 2017.*

The proposed works constitute the installation of 31no. window openings with secondary glazing as per planning approved drawing VTH-CWA-ZZ-ZZ-DR-A-0491\_P-02 to the following levels:

Level 1: 16 no. windows

Level 5: 6 no. windows

Level 6: 9 no. windows

The largest of the windows contained on Level 1, will have horizontal sliding units installed in a stacked arrangement to span the full width of the window arrangement. This utilises Series 10 Slimline and Series 46 Slimline for the small pane at the base of the window. Both series are from the Selectaglaze range.

The mid-sized windows contained on Level 5 will have vertical sliding units installed in order to line up with the central horizontal sight line within the primary window. This utilises Series 20 Slimline from the Selectaglaze range.

The smaller of the windows contained on Level 6 will have Tilt-in vertical sliding units installed in order to line up with the off-set horizontal sight line in the primary window and allow cleaning access. This utilises Series 60 Tilt-in from the Selectaglaze range.

# Corstorphine & Wright

Specification sheets provided by Selectaglaze are enclosed for the following systems:

- Series 10 Slimline
- Series 20 Slimline
- Series 60 Tilt-in

The following detail drawings by Selectaglaze are enclosed for Series 20 and Series 60 Tilt-in:

## Series 20 Slimline

- DS-221-AA
- DS-222-AA

## Series 60 Tilt-in

- DS-260-BB

The following associated drawings are included with the application and outline the extent of the work together with detail drawings:

VTH-CWA-P4-01-DR-A-4502\_P-02

VTH-CWA-P4-01-DR-A-4503\_P-02

VTH-CWA-P4-ZZ-DR-A-4504\_P-01

Kind Regards,

**Henry Jones**

Associate Architect

For & on Behalf of

**CORSTORPHINE & WRIGHT**

Enclosures: Selectaglaze Series 10 Slimline, Selectaglaze Series 20 Slimline, Selectaglaze Series 60 Tilt-in, DS-221-AA, DS-222-AA & DS-260-BB



A slim and versatile horizontal sliding system that provides easy access to the external window for ventilation.

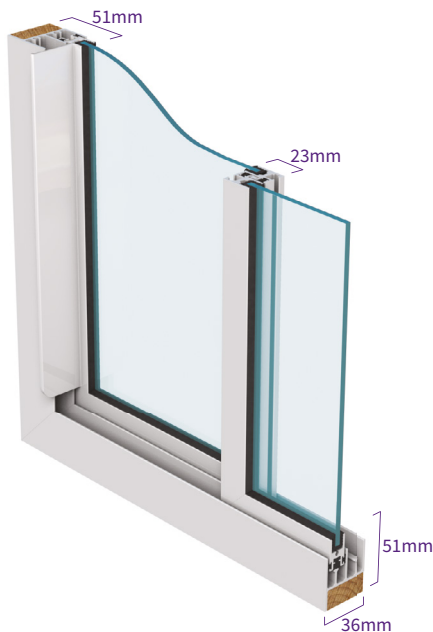

For product photo gallery, case studies and CAD files click here to visit our website



FEATURES

- Available with 2, 3 or 4 sliding sashes (panels)
- Sashes slide on glide pads (ref R1)
- Full height, integral projecting handle (ref H1)
- 23mm wide interlock stile
- Twin brush seals ensure high sealing efficiency
- Fixings concealed within the frame – trims not required
- Sashes are removable for maintenance and cleaning
- Frames may be linked with a colour matched aluminium transom/mullion section
- Integral full height finger pull

DIMENSIONS

Recommended maximum frame

Format	Height (mm)	Width (mm)
2 PANES	2200	2800
3 PANES	2200	4200
4 PANES	2200	4900

Maximum sash (h)2200mm x (w)1400mm, minimum sash (h)350mm x (w)250mm

Overall dimensions are subject to a maximum sash weight of 40kg and a risk assessment covering window location and type of end user

Sash height to width ratio should not normally exceed 4:1

FRAME COLOUR

Stock finish is white HIPCA 9910 semi-gloss

Any standard powder paint, wood grain finish or anodised finish to order

OPTIONS

<b>Glazing</b>	4mm to 6.8mm
<b>Frames</b>	Heavy duty interlock stile Heavy duty box interlock stile Low profile running track to clear inward opening windows (ref F2) Triple track allowing 3 sashes to stack at one end (ref F3)
<b>Hardware</b>	R2 Medium duty ball-race with nylon tyre
<b>Ironmongery (see page 44/45)</b>	H3 Recessed finger pull for contra-sliding L1 Shoot-bolt L2 Lockable fitch catch L4 Plunge lock L13 Sliding latch L28 'U' channel track restrictor



A slim section vertical sliding unit suitable for treating traditional sash windows. Spring balances fully support the sliding sashes in all positions.

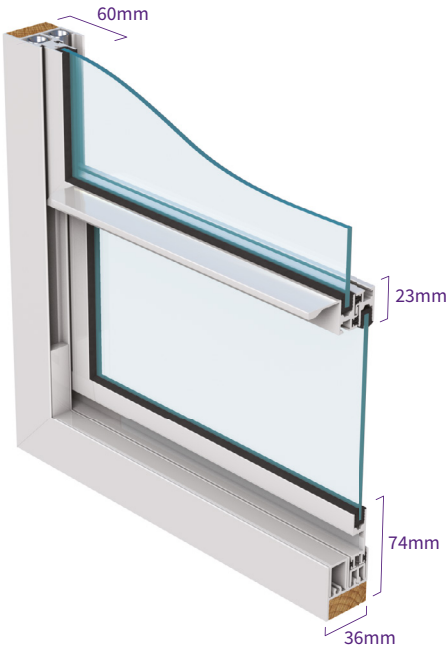

For product photo gallery, case studies and CAD files click here to visit our website



FEATURES

- Recessed finger pull on lower sash allows contra-sliding to assist with cleaning
- 23mm interlock stile with projecting finger pull
- Twin brush seals ensure high sealing efficiency
- Fixings concealed within the frame - trims not required
- Frames may be linked with a colour matched aluminium transom/mullion section
- Interlock finger pull

DIMENSIONS

Recommended maximum frame

Format	Height (mm)	Width (mm)
2 PANES	3000	1400

Maximum sash (h)1500mm x (w)1400mm, minimum sash (h)300mm x (w)350mm

Overall dimensions are subject to a maximum sash weight of 20kg

Sash height to width ratio should not normally exceed 1:3

A minimum frame to frame gap of 75mm is recommended for access to the outer window

FRAME COLOUR

Stock finish is white HIPCA 9910 semi-gloss

Any standard powder paint, wood grain finish or anodised finish to order

OPTIONS

<b>Glazing</b>	4mm to 6.8mm
<b>Frames</b>	Heavy duty box interlock stile Curved heads - minimum radius 660mm
<b>Ironmongery</b> (see page 44/45)	H3 Recessed finger pull to upper sash H17 Cranked 'D' handle to upper sash L2 Lockable fitch catch L4 Plunge lock L13 Sliding latch





A vertical sliding unit with panels that can tilt-in; useful when windows have unequal pane sizes or if frames need to be fitted close together. Sashes are supported on spring balances and have stay arms to allow safe tilting for cleaning or access.

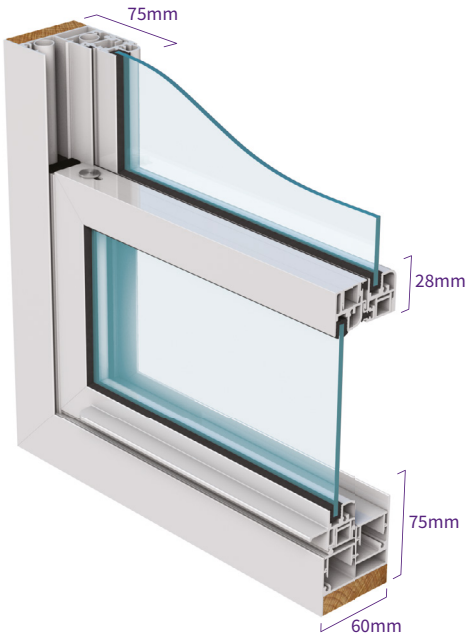

For product photo gallery, case studies and CAD files click here to visit our website



FEATURES

- Sprung release catches allow sashes to tilt in
- Stainless steel stay arms safely hold the sash in the open position
- Friction brake mechanism prevents the sashes sliding in the tilt position
- Integral projecting finger pull to lower sash
- Twin seals ensure good sealing efficiency
- Fixings concealed within the frame - trims not required
- Frames may be linked with a colour matched aluminium transom/mullion section

FRAME COLOUR

Stock finish is white HIPCA 9910 semi-gloss  
Any standard powder paint, wood grain finish or anodised finish to order

OPTIONS

- Glazing** 4mm to 6.8mm
- Ironmongery** H17 Cranked 'D' handle to upper sash  
(see page 44/45) L2 Lockable fitch catch

DIMENSIONS

Recommended maximum frame

Format	Height (mm)	Width (mm)
2 PANES	3000	1500

Maximum sash (h)1500mm x (w)1500mm, minimum sash (h)400mm x (w)400mm

Overall dimensions are subject to a maximum sash weight of 20kg

Sash height to width ratio should not normally exceed 1:3

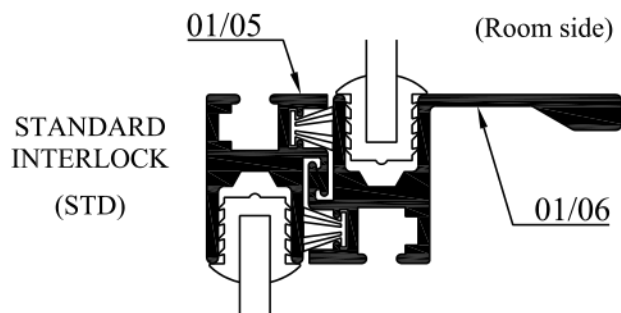

DRAWN	DATE	ISSUE	AA					
S. THOMPSON	08-04-13	C.N.	13/011					
DESCRIPTION	SERIES 20 VSCB - INTERLOCK OPTIONS							
This document is the property of Selectaglaze Ltd and full copyright is reserved				SHEET 1 OF 1 SHEETS		CAD FILE NAME DS-221-AA.dwg		
				DATA SHEET NUMBER		DS-221		ISSUE AA

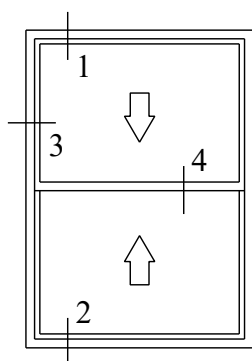

STYLE VSCB

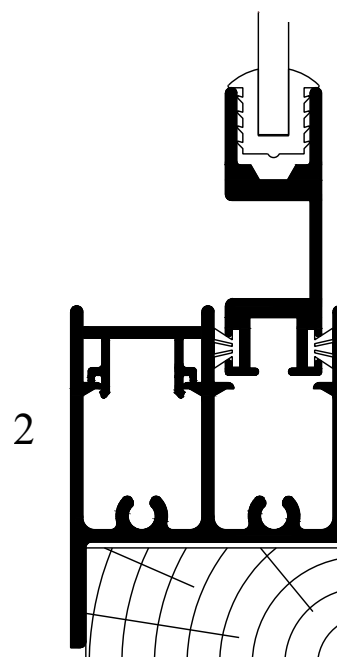
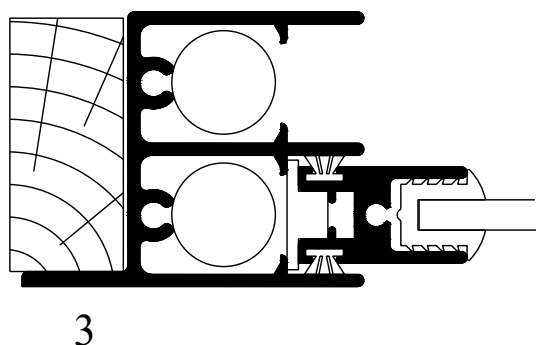
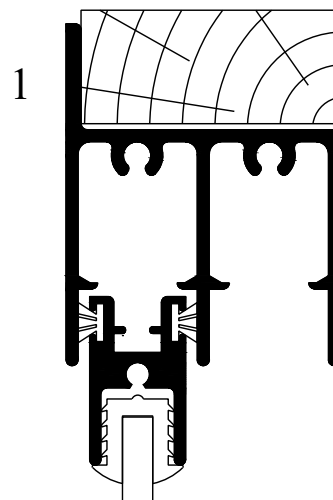

Drawings show standard 33 x 15mm softwood grounds without packing tolerance.  
Selectaglaze Ltd. reserves the right to alter any of the sections without prior notice.

SCALE 1:1  
(print without scaling)

DRAWN	DATE	ISSUE	AA					
S. THOMPSON	08-11-18	C.N.	18-052					
DESCRIPTION	SERIES 20 EXTENDED COVER VERTICAL SLIDING UNIT							
This document is the property of Selectaglaze Ltd and full copyright is reserved				SHEET 1 OF 2 SHEETS		CAD FILE NAME	DS-222-AA.dwg	
				DATA SHEET NUMBER		DS-222		ISSUE AA

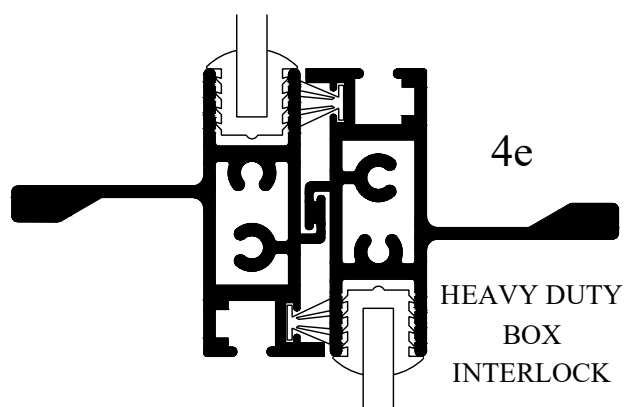
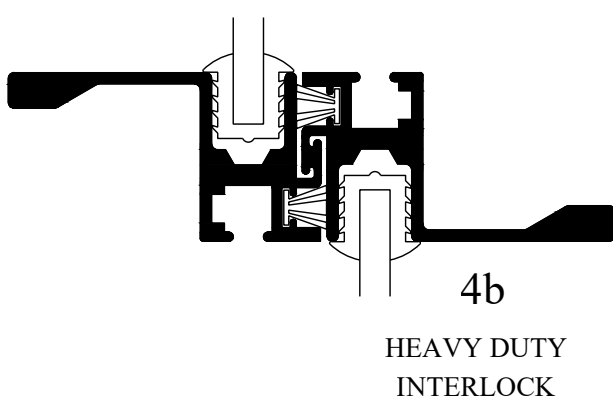
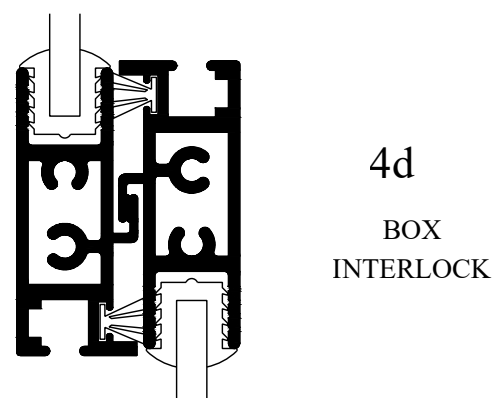
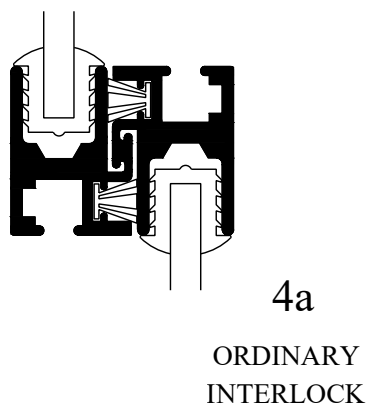
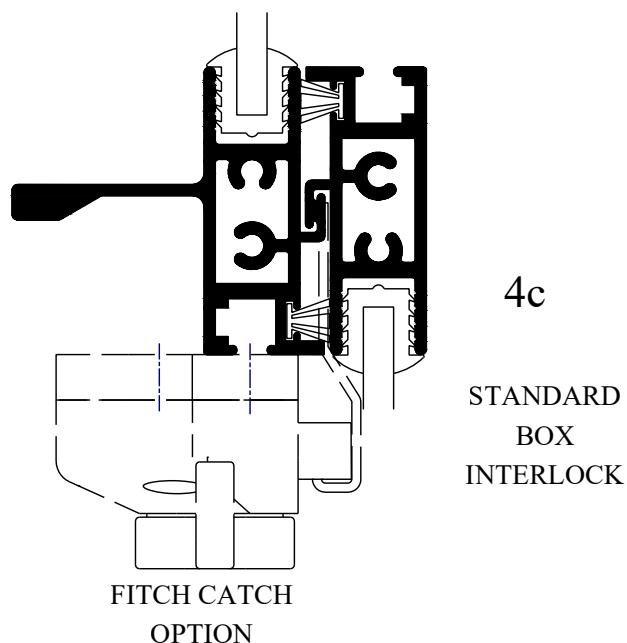
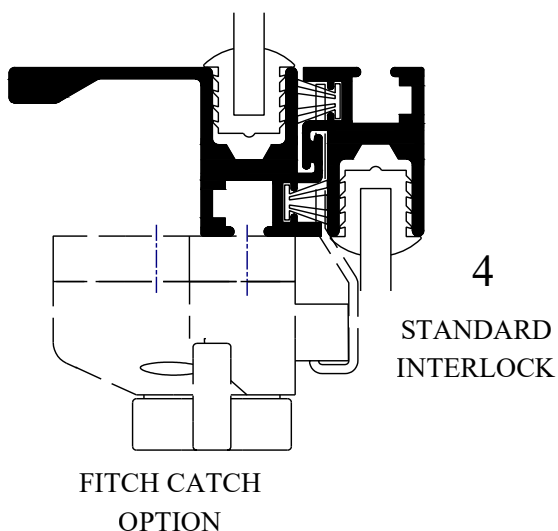

Drawings show standard 33 x 15mm softwood grounds without packing tolerance.  
Selectaglaze Ltd. reserves the right to alter any of the sections without prior notice.

SCALE 1:1  
(print without scaling)

DRAWN	DATE	ISSUE	AA					
S. THOMPSON	08-11-18	C.N.	18-052					
DESCRIPTION	SERIES 20 EXTENDED COVER VERTICAL SLIDING UNIT							
This document is the property of Selectaglaze Ltd and full copyright is reserved				SHEET 2 OF 2 SHEETS		CAD FILE NAME	DS-222-AA.dwg	
				DATA SHEET NUMBER		DS-222		ISSUE AA



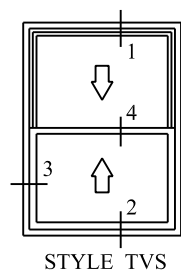

FITCH CATCH  
OPTION

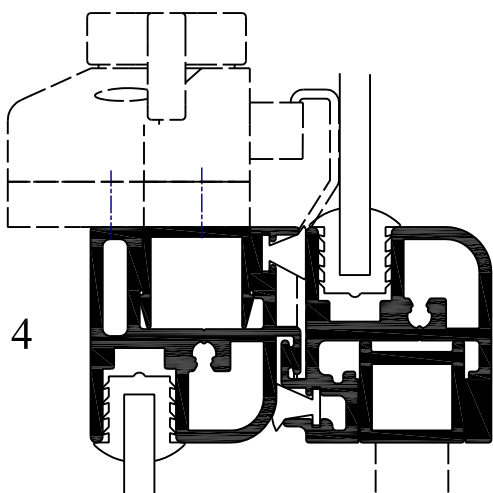

D - HANDLE  
OPTION

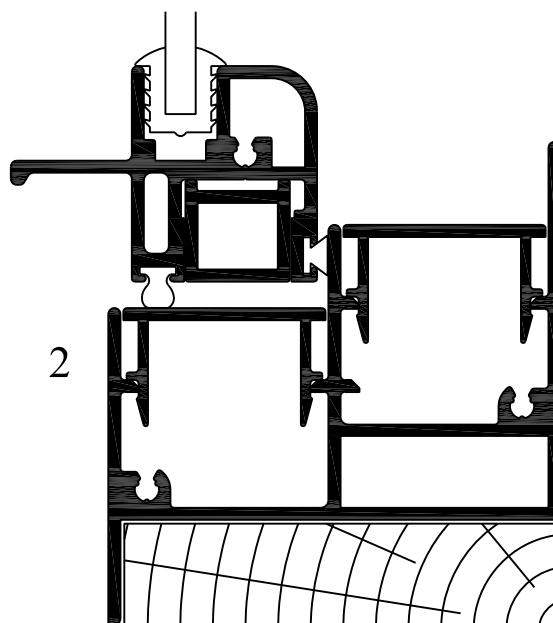
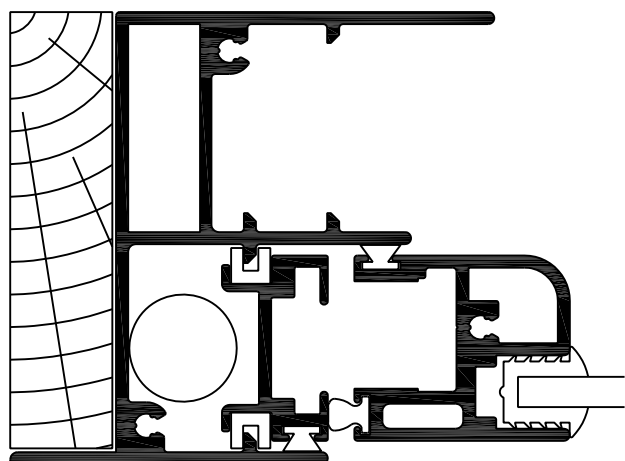
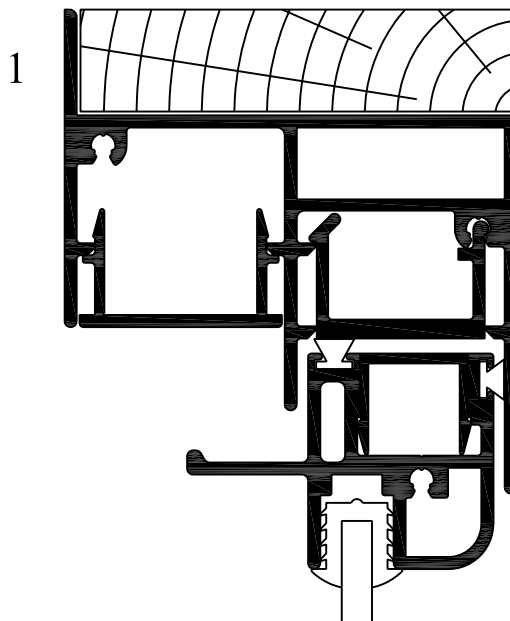

Drawings show standard 58 x 15mm softwood grounds without packing tolerance.  
Selectaglaze Ltd. reserves the right to alter any of the sections without prior notice.

SCALE 1:1  
(print without scaling)

DRAWN	DATE	ISSUE	AA	AB	BA	BB		
S. THOMPSON	06-10-06	C.N.	06/035	07/043	11/008	14-031		
DESCRIPTION	SERIES 60 TILT-IN VERTICAL SLIDING UNIT							
This document is the property of Selectaglaze Ltd and full copyright is reserved			SHEET 1 OF 1 SHEETS		CAD FILE NAME		DS-260-BB.dwg	
			DATA SHEET NUMBER		DS-260			ISSUE BB