

© DO NOT SCALE. Use figured dimensions only. Contractor to check all dimensions before commencement of works. This drawing is copyright. This data to be used as a guide only - not as live data. This drawing must only be used for the purpose for which it is supplied.

- LEGEND**
- PROPOSED DEMOLITION LEGEND**
- Proposed demolition works
- PROPOSED PARTITIONS LEGEND**
- SW.01 100mm THK metal stud partition
- PROPOSED WALL FINISHES LEGEND**
- WF.01 White matt emulsion paint to existing and proposed walls
 - WF.02 Acoustic slat timber wall panels
 - WF.03 PVC hygienic cladding splashback
- PROPOSED FLOORING LEGEND**
- FT.01 Proposed carpet tiles
 - FT.02 Proposed barrier mat
- PROPOSED CEILING LEGEND**
- CT.01 Proposed lay-in grid suspended ceiling
 - CT.02 Repaint existing plaster ceiling
- PROPOSED FURNITURE LEGEND**
- Proposed loose furniture
 - Proposed fitted furniture

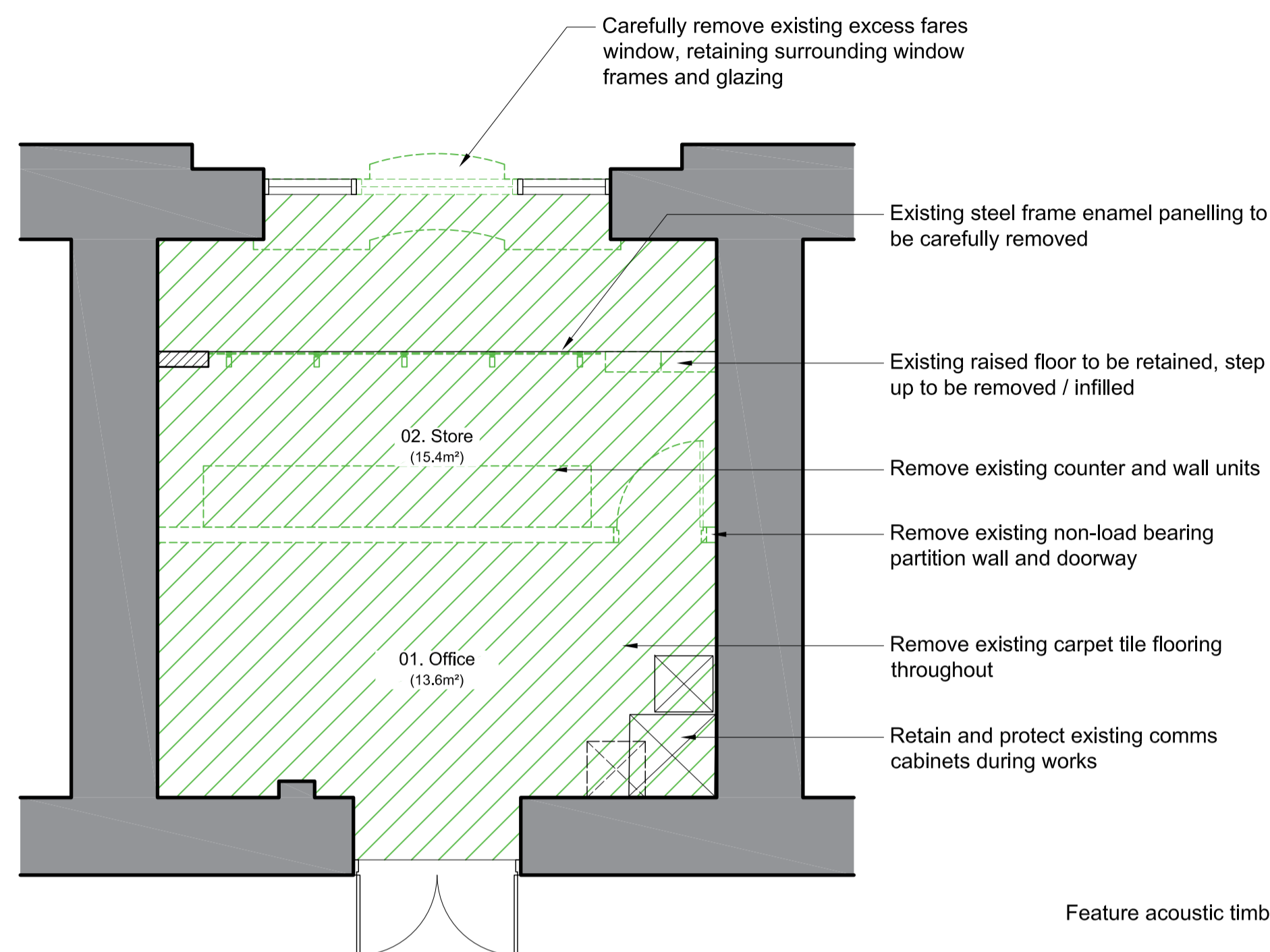

01 Proposed Demolition and Alterations Plan
Scale 1:50 @ A1

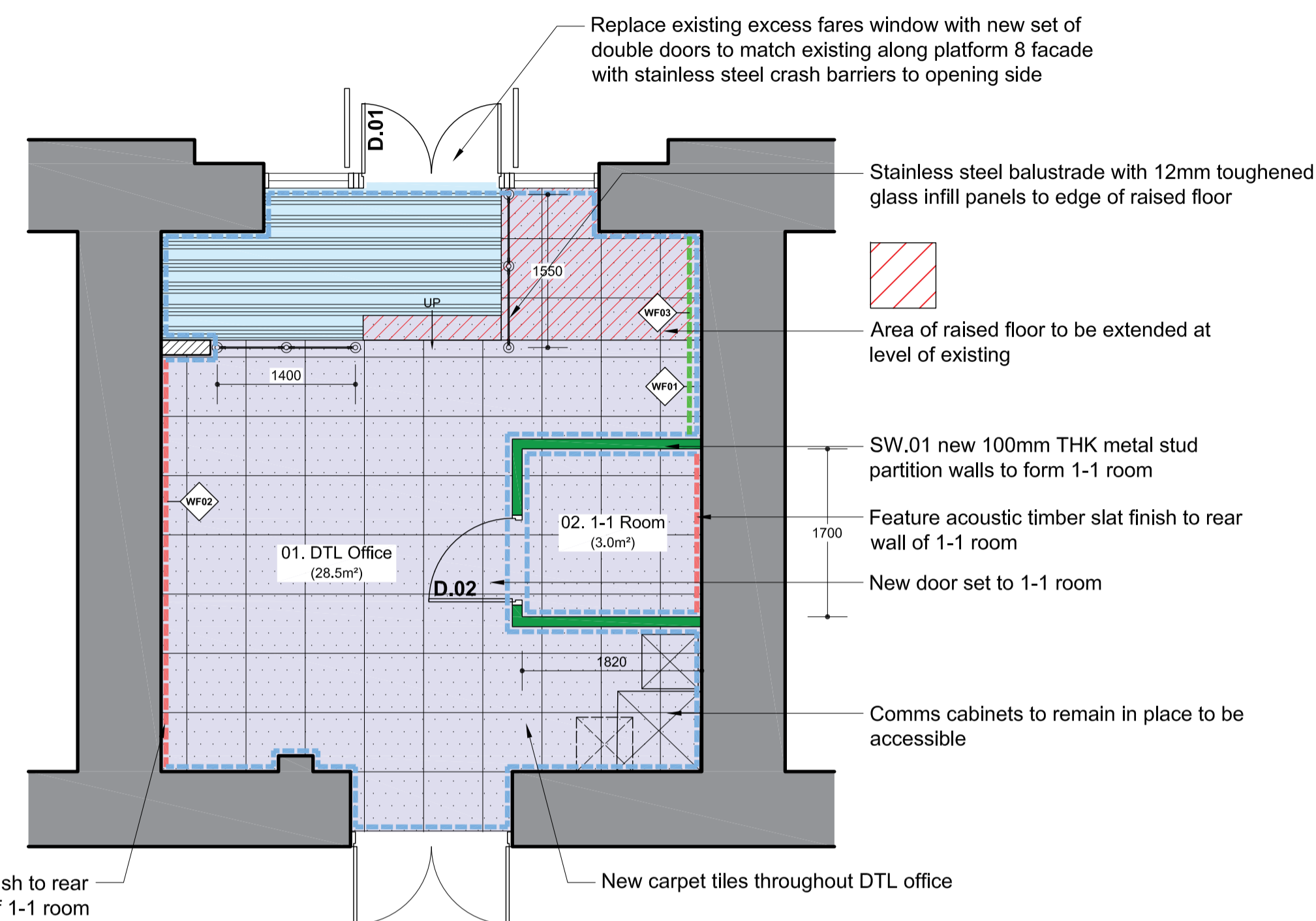

02 Proposed GA Plan
Scale 1:50 @ A1

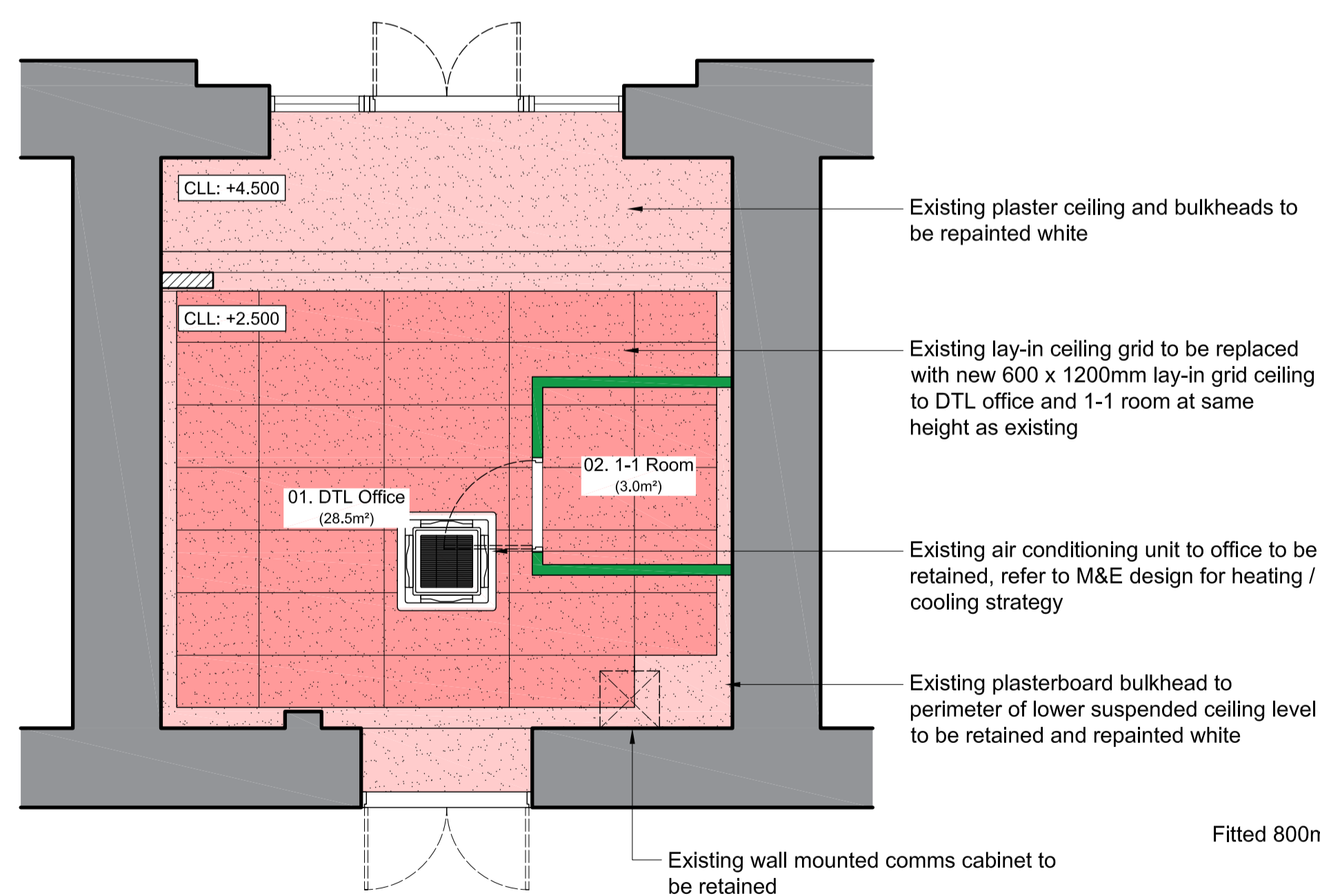

03 Proposed Reflected Ceiling Plan
Scale 1:50 @ A1

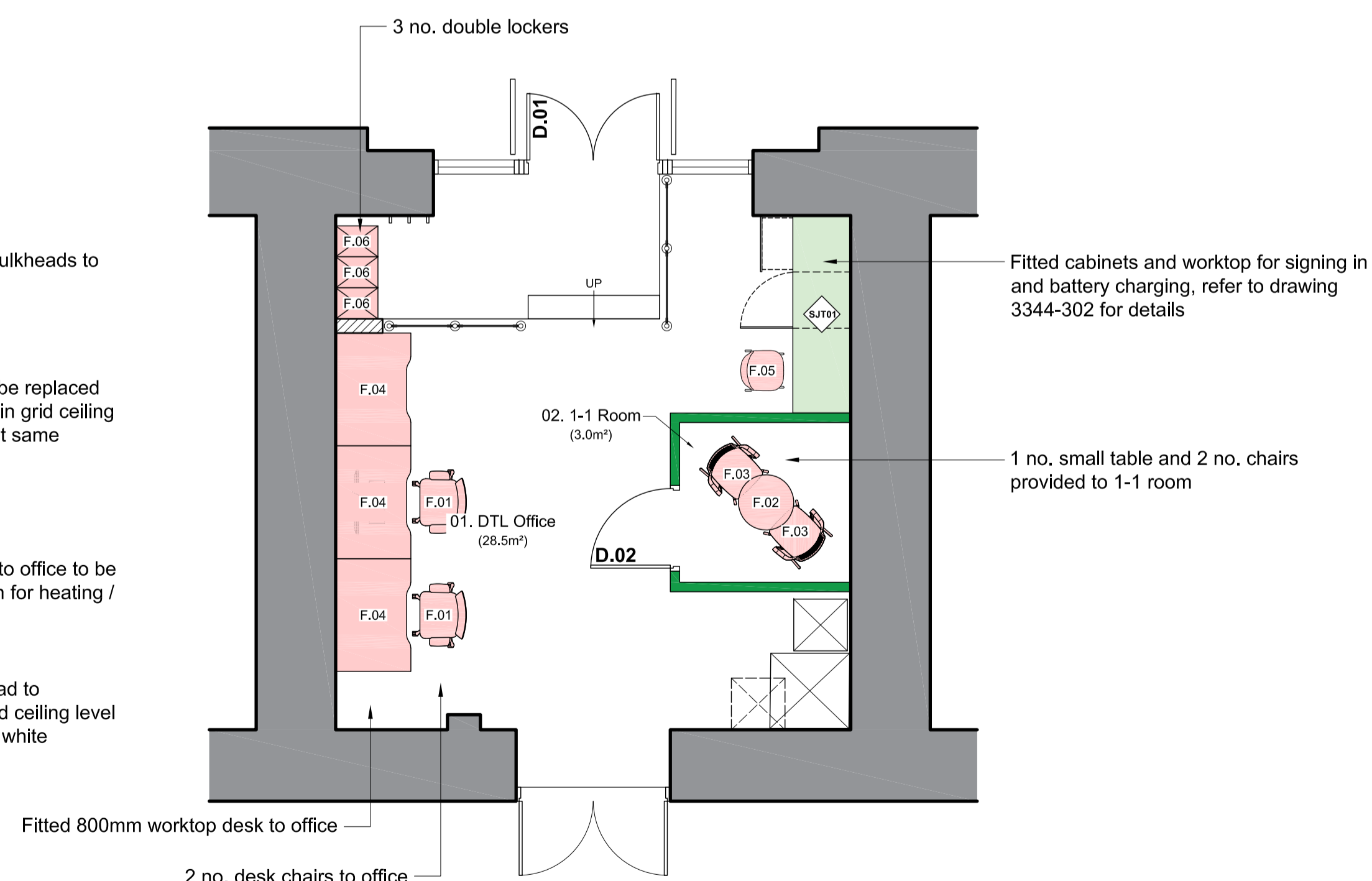

04 Proposed Furniture Plan
Scale 1:50 @ A1

no.	date	by	revision details	Ckd	App
/	18/09/24	CM	FOR LANDLORD'S CONSENT	GO	ASF

STRALA architects
3rd Floor, 9 Stevenson Square
Northern Quarter, Manchester, M1 1DB
Tel: 0161 236 5866
E: office@strzarch.co.uk

LNER

client
LONDON NORTH EASTERN RAILWAY

project
ELR: ECM1, MILEAGE: 0m 00ch, OS Ref: TQ302830
LONDON KINGS CROSS TRAIN STATION
DUTY TEAM LEADER'S OFFICE

drawing status
FOR LANDLORD'S CONSENT

drawing title
PROPOSED PLANS

drawn by	date	checked by	date
CM	18/09/24	GO	18/09/24

Approved by	date	Reviewed by	date
ASF	18/09/24	RES	18/09/24

Network Rail dwg no.	revision no.	sht no.
	/	1 of 1

consultant dwg no.	scale	sht size
3344-201	1:50	A1