

A saw cut to be made at the boundary above the party wall. The old asphalt is removed and the substrate prepared before new IKO Permaphalt is applied up to and flush with the old retained asphalt. The detail is completed by applying a torch-on IKO Cap Sheet to lap at least 75mm onto the flat.

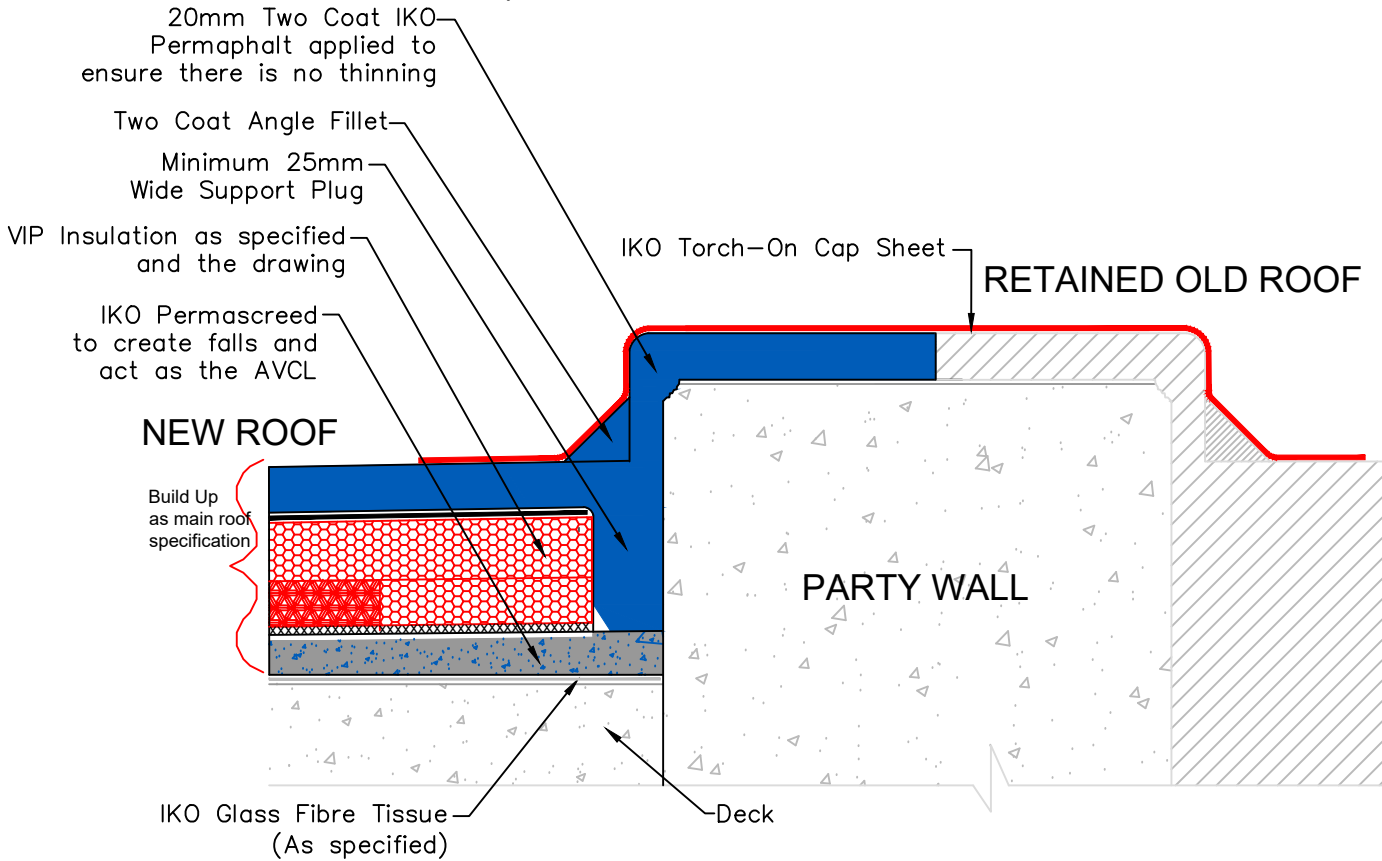

**Mastic Asphalt Roofing to existing asphalt at the boundary on the party wall**  
(Concrete Deck - Warm VIP Roof)

A saw cut to be made at the boundary above the party wall. The old asphalt is removed and the substrate prepared before new IKO Permaphalt is applied up to and flush with the old retained asphalt. The detail is completed by applying a torch-on IKO Cap Sheet to lap at least 75mm onto the flat.

Remove all existing waterproofing to the detail.

Inspect & carry out any necessary maintenance work to the upstand. i.e; repairing frost damage.

Wire brush the surfaces to remove all loose dust & foreign material. Surfaces to which the waterproofing system is to be applied to must be smooth, clean, dry & sound.

Prime all cementitious upstands, slopes etc with **IKOpro High Bond Primer** and allow to dry. Ensure that primer is continued in to any recesses.

Apply the specified IKO Cap sheet to lap a minimum 75mm onto the asphalt on the flat.

White solar reflective paint to be applied to all exposed **Permaphalt** on completion of the rendering.



**Polymer Modified Mastic Asphalt**  
TECHNICAL SERVICES  
PROSPECT QUARRY, GRANGEMILL, MATLOCK,  
DERBYSHIRE, DE4 4BW  
Tel: 01257 256888  
Internet: www.ikogroup.co.uk  
Email: technical@ikogroup.co.uk

PROJECT NAME & ADDRESS

-----

DRAWING TITLE

**Mastic Asphalt Roofing to existing asphalt at the boundary on the party wall with VIP Insulation**

SPEC No:

-----

DATE:

09/07/2024

NOTES/REVISIONS

DWG NO:

B5VIP  
SPECIAL

DRAWN:

ME

COPYRIGHT RESERVED - PLEASE NOTE THAT THIS DRAWING & THE COPYRIGHT THEREIN IS THE PROPERTY OF IKO & IS ISSUED ON THE UNDERSTANDING THAT THE DRAWING OR ANY DETAIL THEREOF WILL NOT BE DIVULGED TO A THIRD PARTY UNLESS WRITTEN PERMISSION IS FIRST OBTAINED FROM IKO TECHNICAL SERVICES DEPARTMENT. THE DRAWING IS VALID ONLY WHEN APPROVED BY THE ARCHITECT/ CONTRACTOR CONCERNED. SHOULD IT NOT BE POSSIBLE TO REPRODUCE THE DETAIL SHOWN, TECHNICAL SERVICES SHOULD BE NOTIFIED IMMEDIATELY.

NB: THIS DRAWING HAS BEEN DRAWN USING THE INFORMATION PROVIDED AT SURVEY STAGE. IF THERE ARE ANY AMENDMENTS TO THE DRAWING, IKO TECHNICAL SERVICES MUST BE CONTACTED IMMEDIATELY. THIS DRAWING IS FOR INDICATIVE PURPOSES ONLY & MUST NOT BE USED FOR SCALING/MEASUREMENT PURPOSES.