

PLANNING

GENERAL NOTES

1. This drawing is copyright of Powell Tuck Associates and must not be used or reproduced without permission from Powell Tuck Associates. All rights reserved.
2. This drawing should be removed from currency immediately when a revised version is issued.
3. IMPORTANT - Drawing to be read in conjunction with all specifications, schedules, drawings and documents provided by the design team. Any discrepancies between these documents to be referred immediately to PTA.

DIMENSIONING

1. No dimensions to be scaled from this drawing. All dimensions in mm's unless otherwise stated.
2. IMPORTANT - All dimensions are to be site checked by contractors, sub-contractors and suppliers prior to commencing any works or fabrication/ shop drawings.
3. IMPORTANT - All dimensions taken from finished face unless otherwise stated, if in doubt confirm before proceeding.
4. Dimensions followed by [ref] indicate reference dims, these should be used as check dims only and not as the primary source for setting out.
5. Dimensions followed by [site check] indicate check dimensions that the contractor must confirm to PTA prior to proceeding with setting out.
6. Dimensions followed by [s/o] indicate dims of structural opening.
7. Dimensions followed by [f/o] indicate dims of finished opening.

NOTE:

This drawing is issued for planning application purposes only, no dimension is to be taken from this drawing. Drawing to be read in conjunction with existing, proposed and demolition drawings.

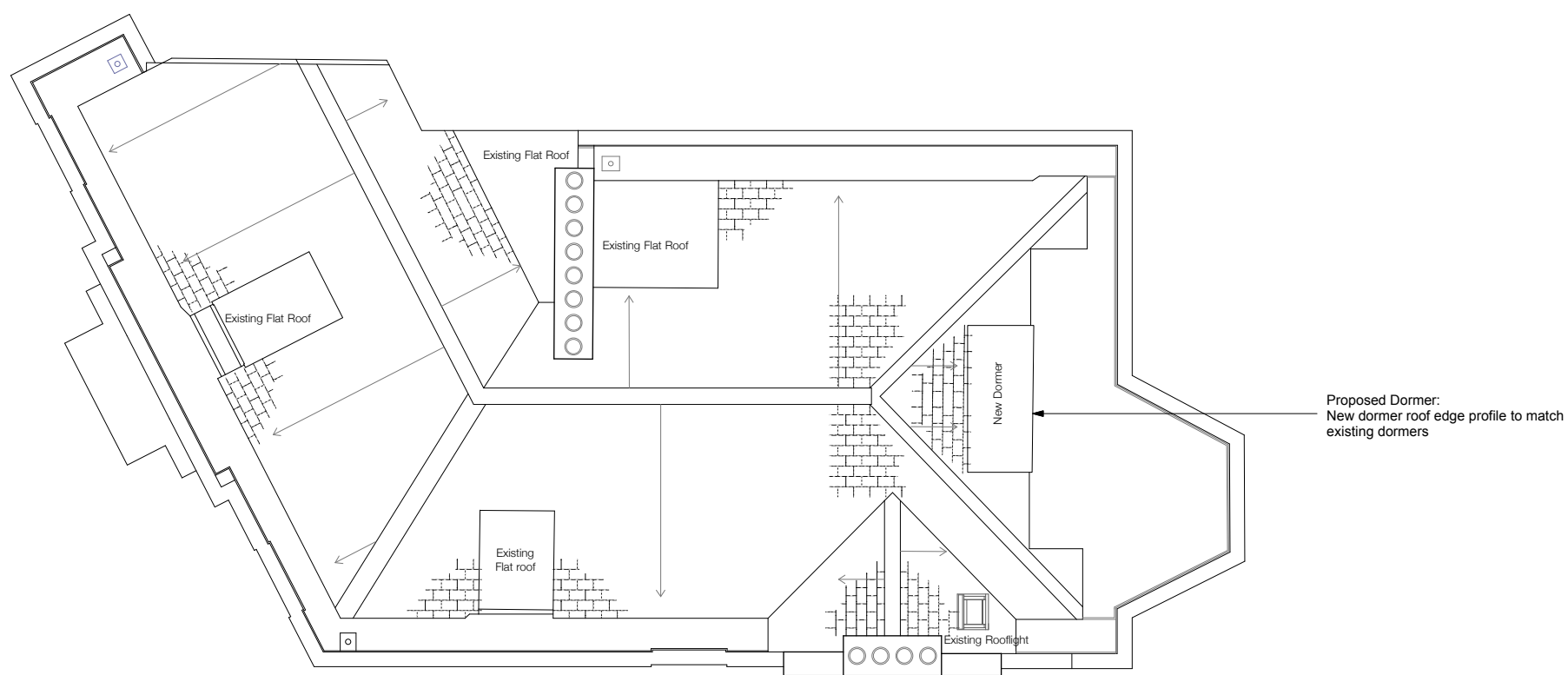

PROPOSED ROOF PLAN

PL2	PLANNING issue - Rear Dormer proportions updated	13/09/24	BB
PL1	PLANNING issue	12/07/24	BB
REV	DESCRIPTION	DATE	NAME

Powell Tuck Associates
 6 Stamford Brook Road
 London W6 0XH
 +44 (0)20 8749 7700
 powelltuckassociates.co.uk

PROJECT TITLE
 15 CHURCH ROW
 LONDON
 NW3 6UP

DRAWN BB	CHECKED AS	
DATE 13.09.24	SCALE 1:100 @ A3 1: 50 @ A1	

DRAWING TITLE
 PROPOSED:
 ROOF PLAN

JOB NO. 2649	DRAWING NO. PL-01-004	REV. PL2
------------------------	---------------------------------	--------------------

