

Crediton Hill

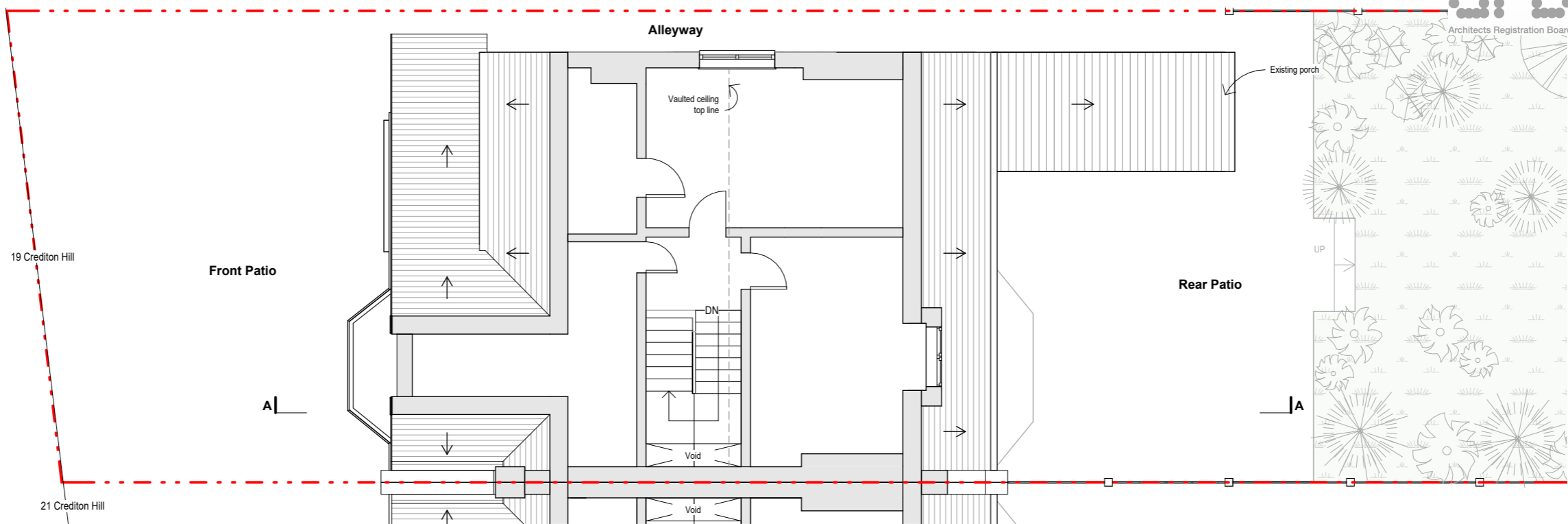

Existing Second Floor Plan

Crediton Hill

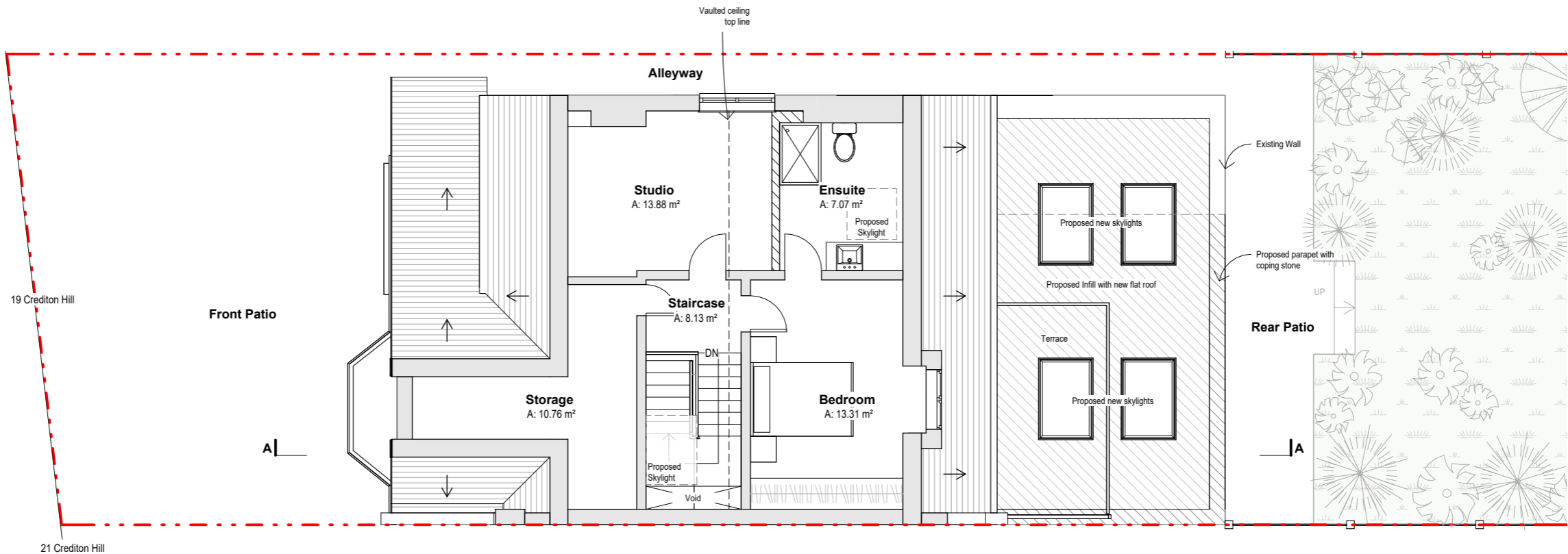

Proposed Second Floor Plan

Legend

- Existing walls
- New walls

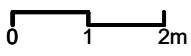

PROJECT
Crediton Hill

ADDRESS
19 Crediton Hill
London. NW6 1HS

DRAWING TITLE

Existing & Proposed SF Plans

SCALE	DATE	REV	DWG NO.
1:100	02/04/24		D103

www.hampsteadarchitects.com 663 Finchley Road, Hampstead, NW2 2HN T - 02074356231

