

Ref.	Common Name	Physiol.	Struct.	Category	RPA Rad.
G2	Mixed shrubs	Good	Good	C2	1.8m
T1	Silver birch	Good	Good	C2	11m
T3	London plane	Good	Good	A2	8m
T4	London plane	Good	Good	A2	8.3m
T5	London plane	Good	Good	A2	10.2m
T6	London plane	Good	Good	A2	8.6m
T7	London plane	Good	Good	A2	0.8m
T8	Cut leafed alder	Fair	Fair	C2	0.8m
T9	London plane	Good	Good	A2	8.6m
T10	London plane	Good	Poor	U	7.1m
T11	London plane	Good	Good	A2	7.7m
T12	London plane	Good	Good	A2	7.1m
T13	London plane	Good	Good	A2	9.1m
T14	False acacia	Good	Good	A2	2.4m

Extended root protection area shown as dashed circles

Once hard surfacing has been removed, soil surface to be covered with ground protection boards and additional fencing installed. Foundations to be constructed with engineered pile foundations. For details see Arboricultural Method Statement.

Protective fencing around planting area

Protective fencing around planting areas

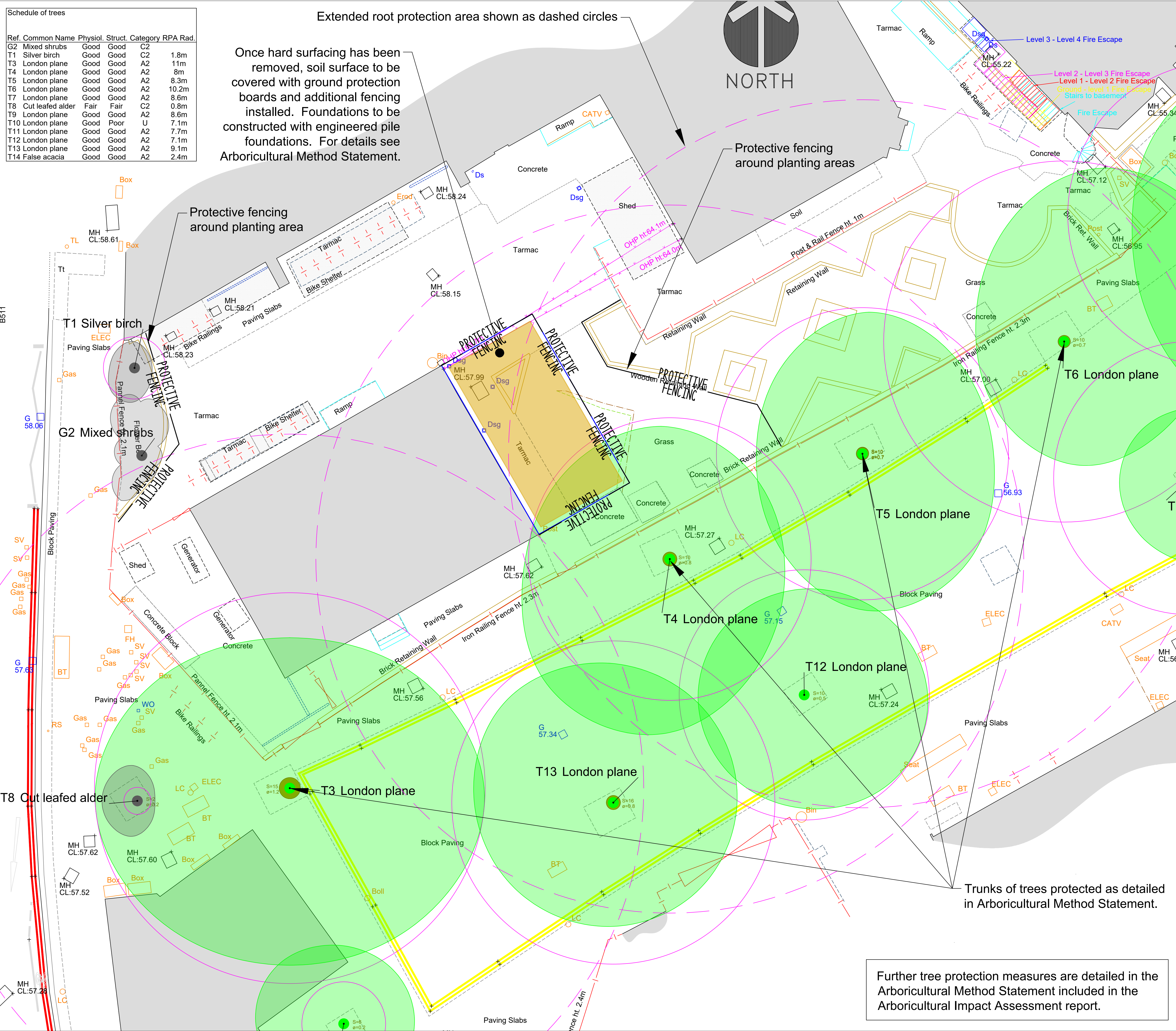

Examples of Tree Protection Barriers from BS5837 2012

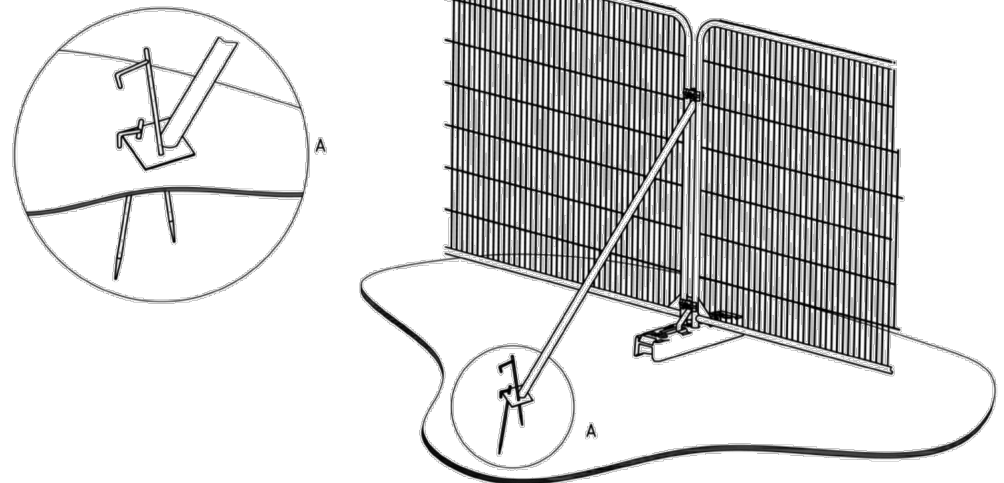

a) Stabilizer strut with base plate secured with ground pins.

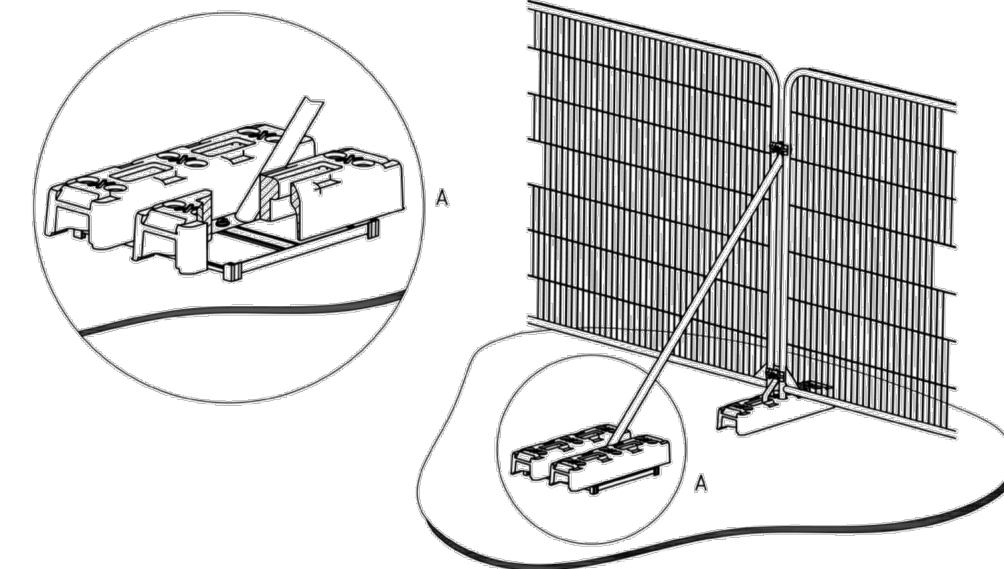

b) Stabilizer strut mounted on block tray.

- 1 Porous/permeable wearing course
- 2 Separation geotextile (100-300g/m2)
- 3 HDPE geocell filled with aggregate
- 4 Base geotextile (300g/m2 min.)
- 5 Existing subgrade

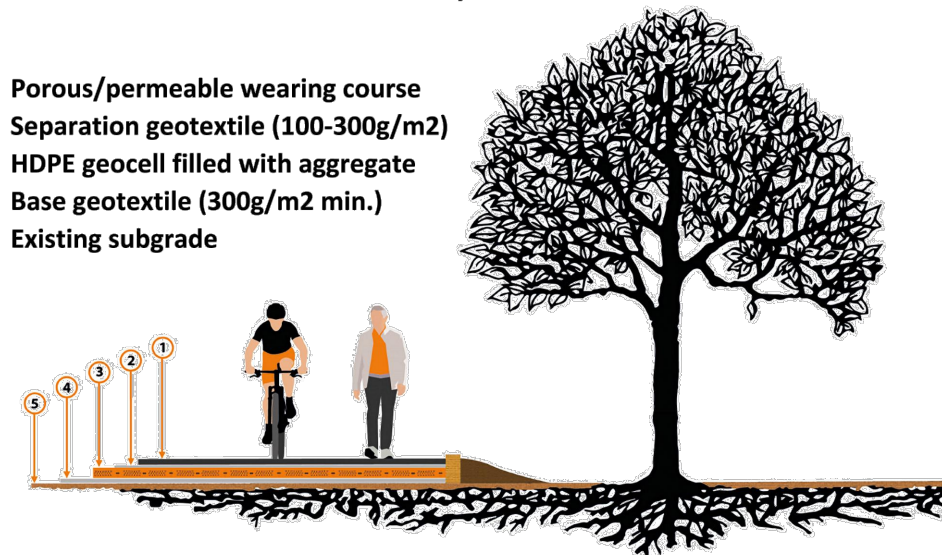

Geocell 'no-dig' construction for access drives and parking near trees to minimise root damage. There are several proprietary systems based on 3-dimensional cellular confinement systems that allow pedestrian and vehicular surfaces to be laid within the RPA. Further details can be obtained from companies including Geosynthetics Cellweb and Terram Geocell.

Protective Measures

- Barriers will have all-weather notices attached with words such as: "CONSTRUCTION EXCLUSION ZONE - NO ACCESS".
- The construction exclusion zones will be protected by barriers before any materials or machinery are brought onto the site. The barriers will remain in place until completion of all works.
- Due to the highly alkaline leachate produced during the curing of wet concrete, concrete will not be poured within the RPA unless an impermeable liner has been installed.
- To avoid contamination and compaction no materials will be stored within 10 metres of a tree trunk or on any unprotected soil surfaces. This includes building materials, scaffolding, fuel, site huts and temporary toilets.
- Notice boards will not be attached to any part of a tree and no fires will be allowed within 10 metres of the canopy or the protective barrier of any retained tree.
- The main contractor will be responsible for:
 - Monitoring of all operations with regard to tree protection on site.
 - The compliance of sub-contractors.
 - Ensuring that the planning conditions attached to the planning consent are adhered to at all times.

Site Guidance Notes

- | | |
|---------------------------------------------------------------------------------------------------------------------------------------------------------------------------------------------|----------------------------------------------------------------------------------------------------------------------------------------------------------------------------------------------------------------------------|
| 1: Monitoring protection
https://www.barrelltreecare.co.uk/resources/technical-guidance/sgn01/ | 7: Excavation in root protection areas
https://www.barrelltreecare.co.uk/resources/technical-guidance/sgn07/ |
| 2: Fencing protected trees
https://www.barrelltreecare.co.uk/resources/technical-guidance/sgn02/ | 8: Removing surfacing and structures in root protection areas
https://www.barrelltreecare.co.uk/resources/technical-guidance/sgn08/ |
| 3: Ground protection
https://www.barrelltreecare.co.uk/resources/technical-guidance/sgn03/ | 9: Installing/upgrading surfacing in root protection areas
https://www.barrelltreecare.co.uk/resources/technical-guidance/sgn09/ |
| 4: Pollution control
https://www.barrelltreecare.co.uk/resources/technical-guidance/sgn04/ | 10: Installing structures in root protection areas
https://www.barrelltreecare.co.uk/resources/technical-guidance/sgn10/ |
| 5: Site cranes and piling rigs
https://www.barrelltreecare.co.uk/resources/technical-guidance/sgn05/ | 11: Installing services in root protection areas
https://www.barrelltreecare.co.uk/resources/technical-guidance/sgn11/ |
| 6: Height restrictions
https://www.barrelltreecare.co.uk/resources/technical-guidance/sgn06/ | 12: Landscaping in root protection areas
https://www.barrelltreecare.co.uk/resources/technical-guidance/sgn12/ |

AT2 TREE SURVEY.CO.UK

Royal Central School of Speech and Drama

Tree Protection Plan: Rev A

20-Aug-24 Scale 1:100 at A1

Central School of Speech and Drama, London AIA.dwg

Further tree protection measures are detailed in the Arboricultural Method Statement included in the Arboricultural Impact Assessment report.

- Tree Gradings
- A
 - B
 - C
 - U
- Tree for removal
- Root protection area (RPA)

All dimensions in metres. Copyright AT2 Tree Survey