



B/2/032  
PREHISTORY & EUROPE  
STUDENTS ROOM



B/4/021  
OFFICE (one room)



B/2/032  
PREHISTORY & EUROPE  
STUDENTS ROOM



B/4/021  
OFFICE (one room)

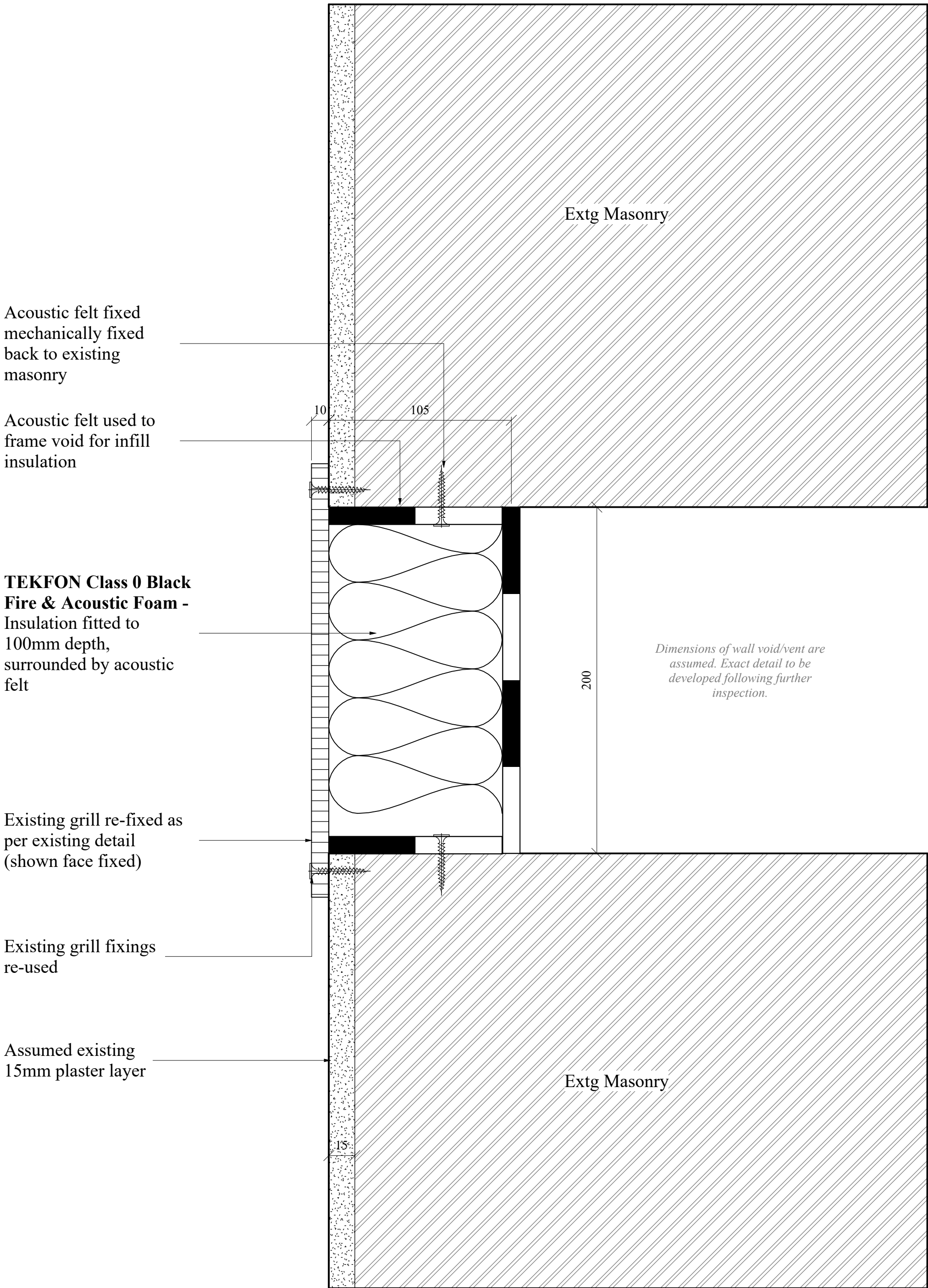

1 Proposed internal face vent treatment  
1 : 2

WRIGHT & WRIGHT ARCHITECTS

89-91 Bayham Street  
London NW1 0AG  
T: +44(0)20 7426 9593  
E: [ww@wrightandwright.co.uk](mailto:ww@wrightandwright.co.uk)

This drawing is not to be scaled. Dimensions govern. Wright & Wright Architects shall be notified in writing of any discrepancies. All dimensions are in millimeters unless noted otherwise. This drawing issued at First Contract is indicative of design intent and should be read in association with all specifications, schedules and consultants information. The Contractor is required to complete the detailed design, final coordination and interfaces. Contractor and Sub-Contractors design are subject to Architects acceptance.

Note : Drawings to be read in conjunction with the LBC design statement and installed to manufacturers guidance. Refer to design statement for further information on fixing details.

P4	Tender revision	09.08.2024	JB	BM
P3	For information	05.07.2024	JB	BM
P2	For approval	10.05.2024		
P1	WIP Issue	11.04.2024		

Rev	Note	Date	Issued By	Issued To
-----	------	------	-----------	-----------

Security Classification: Official

Key Revision

Client

British Museum

Project Name

Energy Centre  
Programme: Noise  
Mitigation

Stage

RIBA Stage 4

Drawing Title

Proposed Typical  
Internal Face Vent  
Detail

Drawing Number

SW001-WWA-1000-X-DDG-A-5121

Scale

1:2

Sheet Size

A1

Issue Date

09.08.2024

Revision

P4

Status

S4 - For approval