

1 Proposed Third Floor Plan
Scale: 1:100

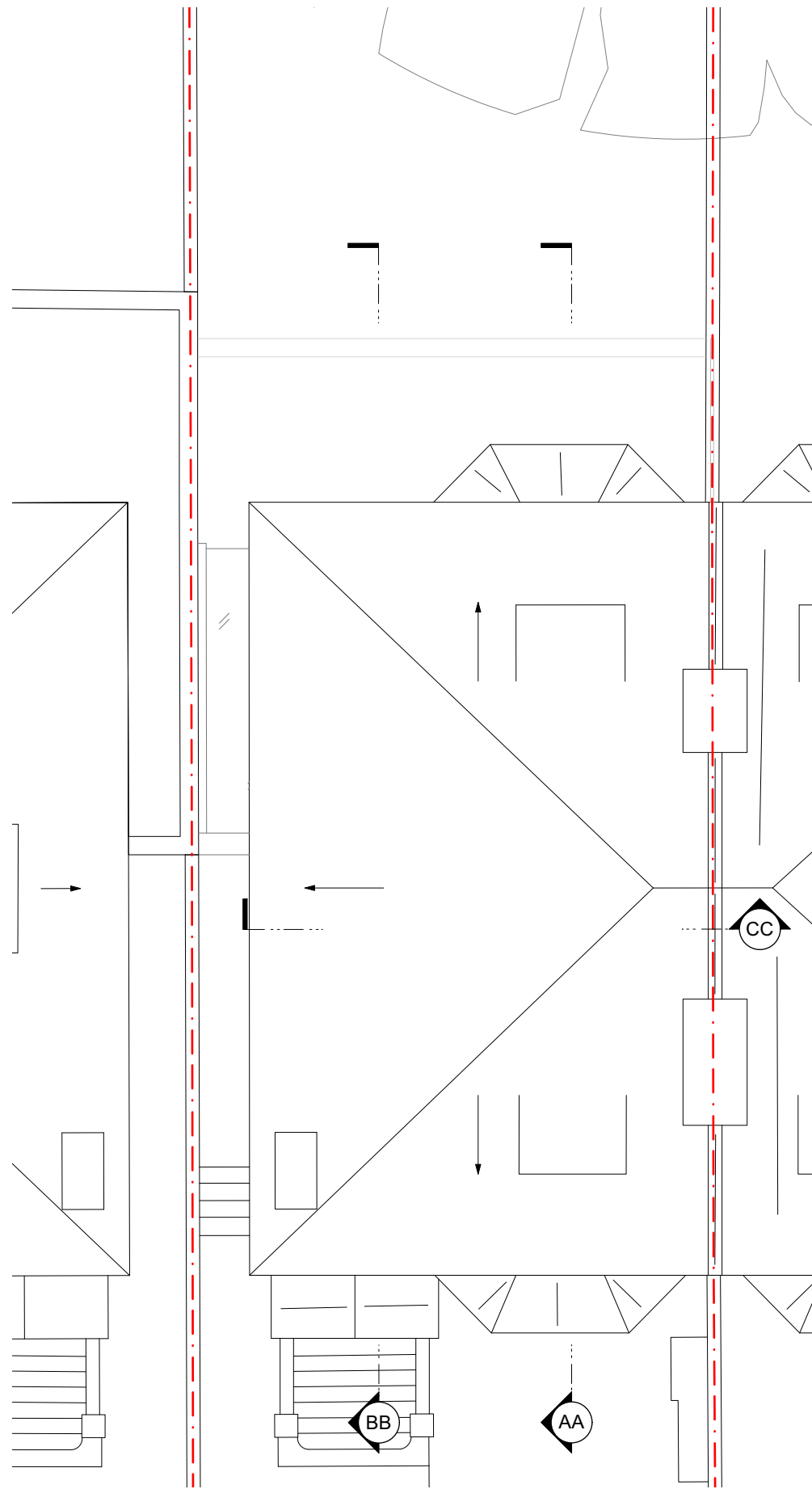

2 Proposed Roof Plan
Scale: 1:100

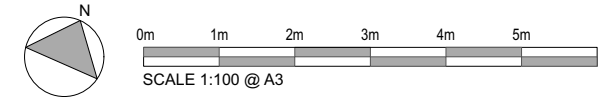

NOTES RELATING TO ALL EXTERNAL/PLANNING ITEMS

- 1 NEW FULL-WIDTH BRICK EXTENSION BRICK TO MATCH EXISTING.
- 2 NEW GLAZED METAL SLIDING DOOR.
- 3 NEW TRADITIONAL TIMBER FRENCH DOORS TO MATCH EXISTING STYLE
- 4 NEW BRICK SOLDIER COURSE BANDING.
- 5 EXISTING TIMBER SASH WINDOW TO BE REPLACED WITH MATCHING SMALLER WINDOW
- 6 INFILLING EXISTING DOOR & NEW TIMBER SASH WINDOW TO MATCH EXISTING
- 7 INFILLING EXISTING ARCHWAY & NEW TIMBER DOOR TO MATCH EXISTING
- 8 NEW PAVED TERRACE AREA
- 9 NEW GLAZED INFILL EXTENSION WITH BRICK NIB TO MATCH EXISTING.
- 10 NEW MASONRY STEPS TO MAIN GARDEN LEVEL WITH BLACK PAINTED METAL BALUSTRADE
- 11 GREEN ROOF TO PROPOSED EXTENSION WITH GRAVEL DRAINAGE & NEW ROOFLIGHT TO PROJECT NO MORE THAN 150MM FROM ROOFLINE
- 12 TRELLIS / PRIVACY SCREEN TO BOUNDARY WALL
- 13 FIXED BLACK PAINTED METAL BALUSTRADE

NOTE: REFER TO DESIGN AND ACCESS STATEMENT FOR ADDITIONAL DETAIL.

REVISION	A	11/09/2024	Updated Drawing Information
DATE	07.08.2024		SCALE 1:100 @ A3
PROJECT	19 Cannon Place, London, NW3 1EH		
CLIENT	Chris & Parya Arnold		
DRAWING TITLE	PROPOSED PLAN - THIRD FLOOR & ROOF		
DRAWING No.	TRS134_PP_103		
ISSUE	Planning		

TR STUDIO
Architecture | Interiors

The Blackfriars Room
St Bride Foundation
14 Bride Lane | London EC4Y 8EQ
T: +44 (0)203 567 0569
E: office@trstudio.co.uk
W: www.trstudio.co.uk

This drawing must not be scaled from nor should it be used for the calculation of areas for the purposes of valuation. All dimensions are indicative and must be verified on site prior to the commencement of any works. This drawing must be read in conjunction with all necessary information from all other design consultants and contractors. All works must comply with the relevant British standards and building control requirements. Drawing errors to be reported to the Architect.