

PLAN DETAILING THE DOMESTIC SERVICES LAYOUT

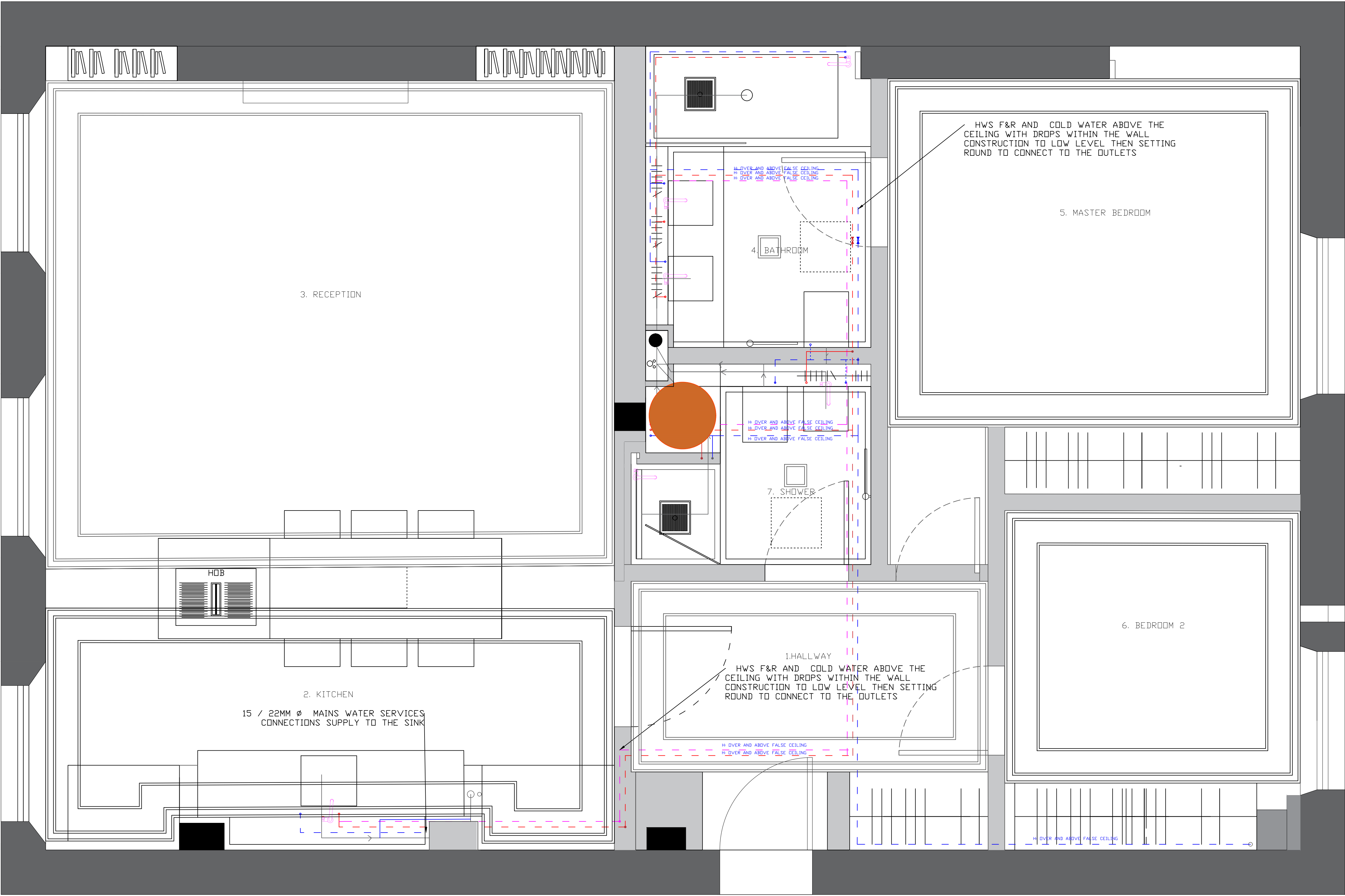

HOT AND COLD WATER SERVICES NOTES:

CONNECTION SIZE TO THE EQUIPMENT
BATH 28MM Ø COPPER
SHOWER 22MM Ø COPPER
BASIN 15 MM Ø COPPER
SINK 15 MM Ø COPPER
DISHWASHER 15MM Ø COPPER
WASHING MASCHINE 15MM Ø COPPER
UNLESS OTHERWISE SPECIFIED

ALL INSTALLATION TO BE CARRIED OUT BY SPECIALIST CONTRACTOR, QUALIFIED HEATING AND PLUMBING ENGINEER AND CONSUMABLES SPECIFIED AND ALLOWED ACCORDINGLY



General Notes

- 1.This drawing and associated drawings set out the aesthetic concept only and indicate preliminary and outline technical & material reference only.
- 2.All current LOCAL standards, Building Regulations, Specifications, Planning, Fire Health and Safety codes to be followed by each works contractor/supplier
- 3.Each supplier/sub contractor will be responsible for checking all site dimensions and conditions, taking setting out points and attainment of proper alignment and levels.
4. figured dimensions are to be taken in preference to those scaled. The contractor is to verify all dimensions and conditions on site

LEGEND

- HWS FLOW
- HWS RETURN
- COLD SUPPLY
- ⊗ ISOLATION VALVE
- ELECTRICAL CYLINDER

No.	Revision/Issue	Date

Firm Name and Address
SPEC GROUP
SOLAR HOUSE
915 HIGH ROAD
N12 8QJ
LONDON

Project Name and Address
5 CUMBERLAND TERRACE

Title PROPOSED HOT & COLD WATER SERVICES	Drawing # 190
Date 18/06/2024	
Scale 1:20 @ A1	