

Basement

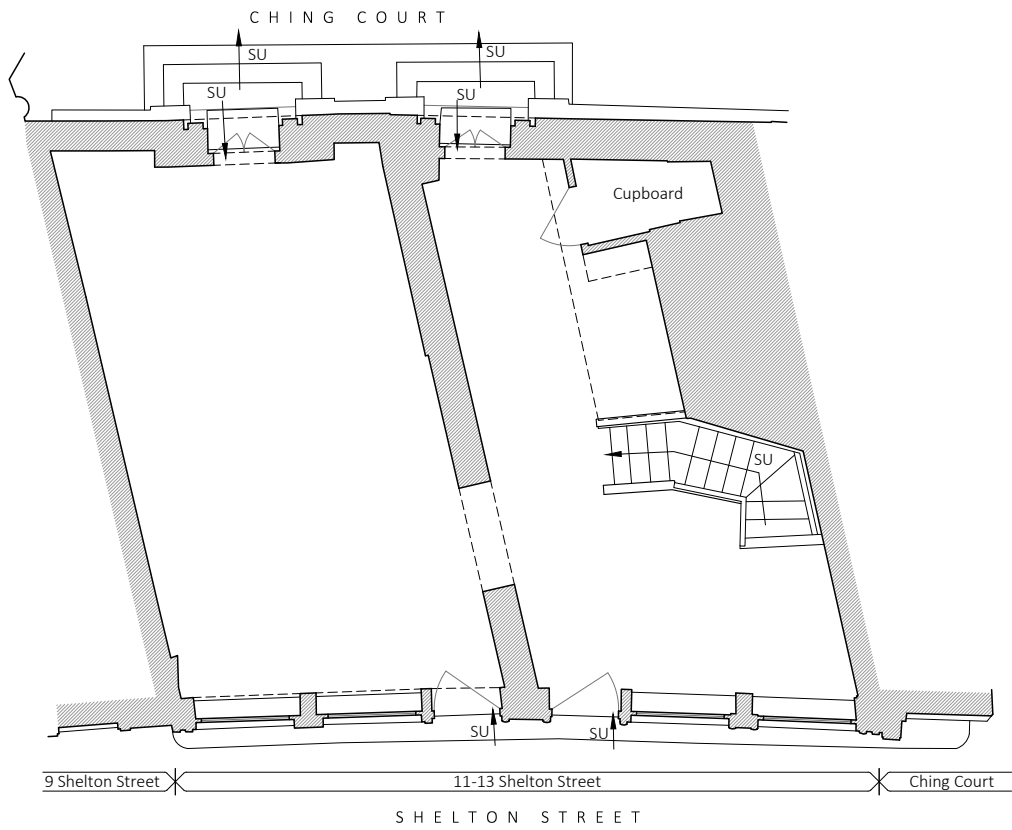

Ground Floor

P1	DMV	Initial issue	31.05.2023
Rev	Iss.	Description	Date

DRAWING TITLE

Basement & Ground
Floor Plans
As Existing

PROJECT NAME
Listed Building Application

ADDRESS
11-13 Shelton Street
London, WC2H 9JN

CLIENT
Shaftesbury Covent Garden Ltd

DRAWN BY
DMV

CHECKED BY
NP

JOB NO.
25857

Queen's House / 55-56 Lincoln's Inn Fields / LONDON WC2A 3JL
020 7391 7100 / www.fandt.com

SCALE
1:100@A3

DATE
May 23

DRAWING NO.
A-100-P1

