

01 | Typical Toilet
401 | 1:20

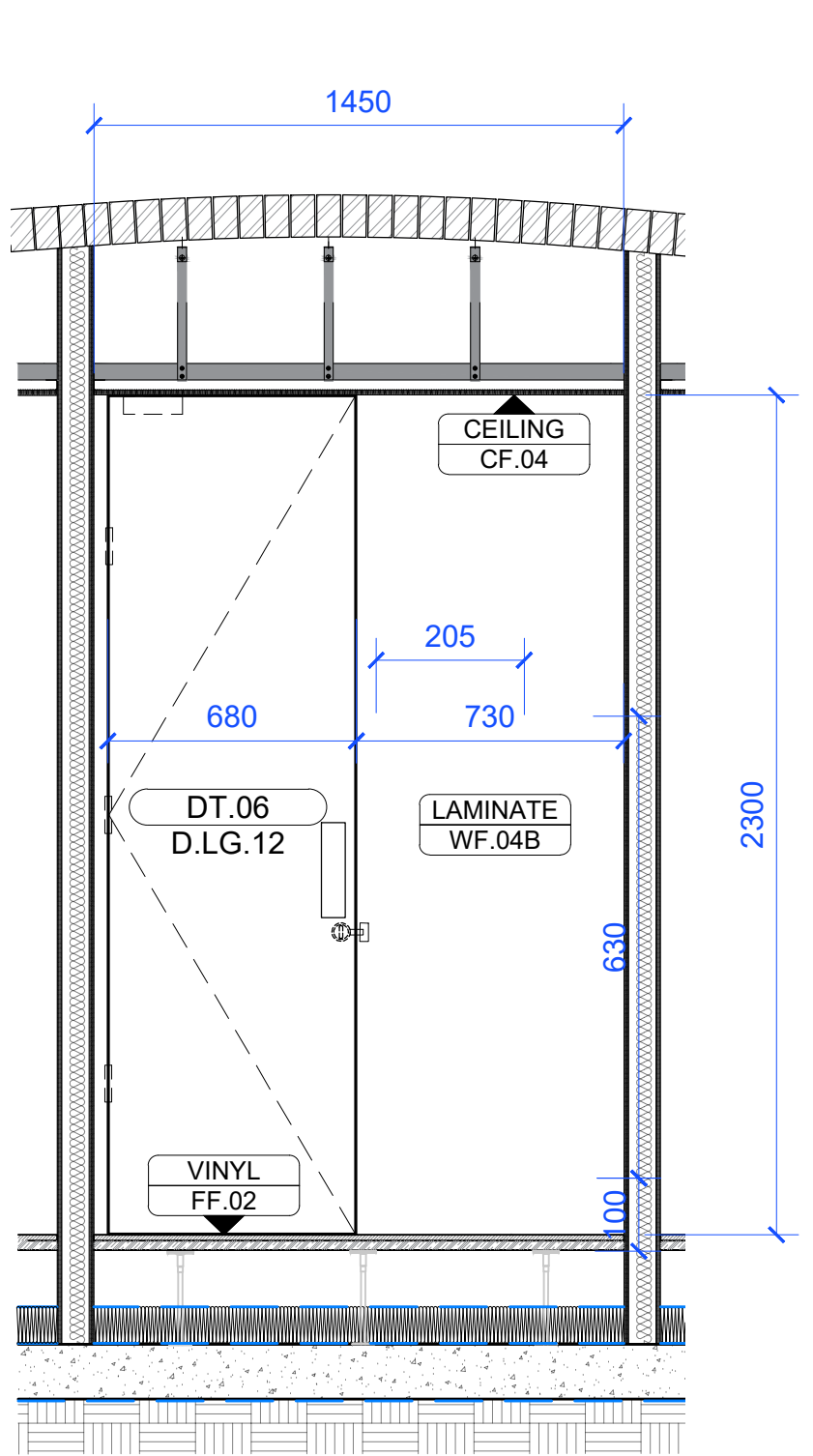

03 | Elevation 02
401 | 1:20

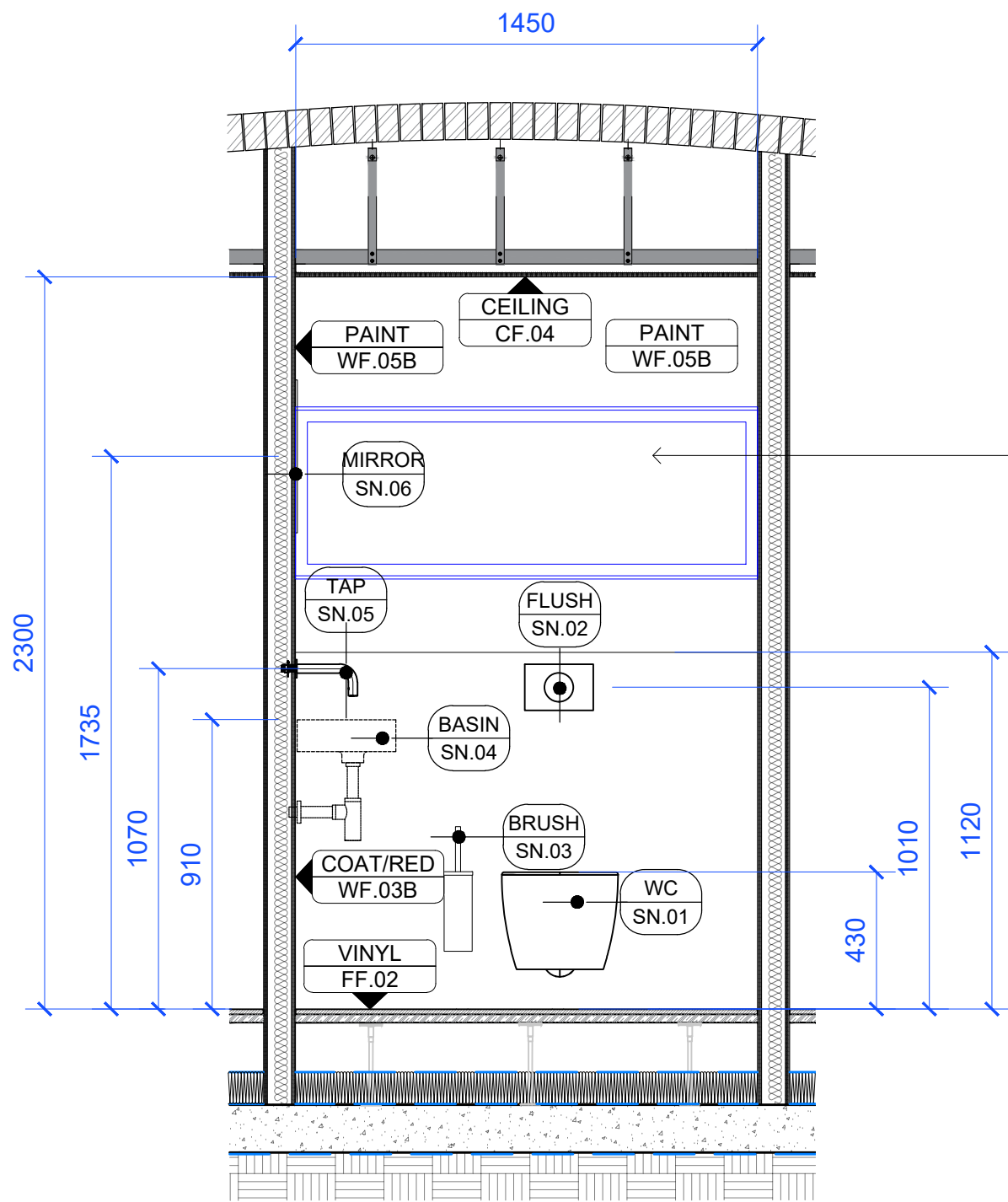

02 | Elevation 01
401 | 1:20

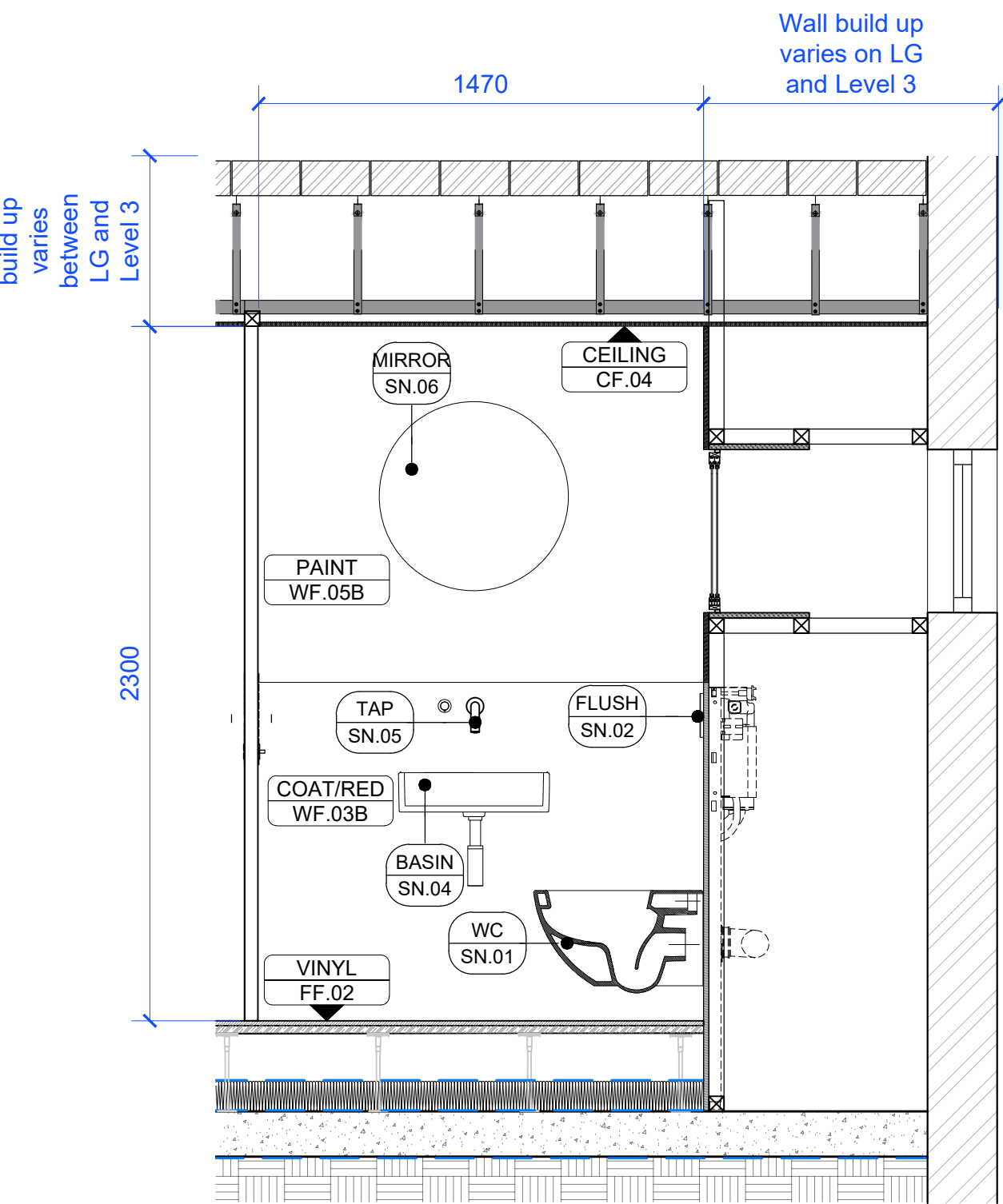

04 | Elevation 03
401 | 1:20

Secondary glazing to be installed in toilet corresponding to external windows

NOTES

- Drawings to be read together with Design Intent information and technical drawings
- All drawings shall be read in conjunction with the fire strategy
- All layouts are subject to compliance review by Building Control
- Drawings are based on survey data and review survey data for further details.
- Do not scale from this drawing. All dimensions are to be verified on site before proceeding with the work.
- Architect shall be notified in writing of any discrepancies.

EQUIPMENT SCHEDULE

- SN-01** Duravit; Happy D.2; Toilet wall mounted Duravit Rimless 255009.00
SN-01 (Alternative) Ceramic Toilet floor mounted TBC
- SN-02** Dolphin Blue Pneumatic Flush Plate; DB5550.P; Finish TBC
SN-03 Toilet Brush TBC
- SN-04** Duravit; Happy D.2 Handrinse basin wall mounted
SN-05 Dolphin; DB1675 Panel Mounted Mixer Tap; Finish TBC
SN-06 Mirror wall mounted TBC
- SN-07** Toilet Handrail TBC

WALL FINISHES KEY

- WF-01A** EXPOSED EXISTING WALL FINISHES (Brickwork)
CLEAN GRIT BLASTING
- WF-01B** EXISTING BRICK WALL (CLEAN BRICKWORK)
(STEAM / WATER)
- WF-02** RENDER (Waterproofing)
- WF-03A** CEMENTITIOUS WALL COATING - GREY
- WF-03B** CEMENTITIOUS WALL COATING - RED
- WF-04A** TIMBER VENEER
- WF-04B** LAMINATE
- WF-05A** PAINT FINISH - WHITE
- WF-05B** PAINT FINISH - GREY
- WF-06** NEW METAL FINISH

FLOOR FINISHES KEY

- FF-01** TIMBER FLOORING
- FF-02** OPTION 1: VINYL FLOORING (SLIP RESISTANT)
OPTION 2: CERAMIC LARGE TILES (SLIP RESISTANT)
- FF-03** TILE FLOORING

CEILING FINISHES KEY

- CF-01** EXPOSED EXISTING CEILING FINISHES (Brickwork)
- CF-02** EXPOSED EXISTING CEILING FINISHES (Concrete)
- CF-03** EXPOSED EXISTING CEILING FINISHES (Structural Steel)
- CF-04** NEW PLASTERBOARD
- CF-05** EXISTING PLASTERBOARD

- CFL : +3.09m**
- CFL : +3.11m**

2	Issued for planning	DF	OG	24.07.2024
1	Issue for Stage 3 Design	DF	OG	15.01.2024
DR	Issued for Review	DF	OG	15.01.2024
Rev	Description	By	Check	Date

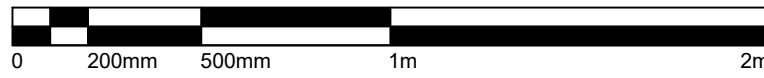

STUDIO GHAZAL

Contractor



QOB Interiors
3 Marshalsea Road
London
SE1 1EP

Client

RAILPEN

RAILPEN

Project

Camden Works, The Rotunda
42-43 Gloucester Crescent, Camden Town, NW1 7PE

Drawing

Lower Ground Typical Toilet Elevations

Scale	Date	Drawn	Approved
1:20 @ A1	24.07.2024	DF	OG
Drawing No.	Revision		
CDW-SGH-PR-LG-DR-A-401	02		