

The Copyright of this drawing belongs to Majher Architect and shall not be used or reproduced in any form without its express permission. The moral right of the author is hereby asserted.

Do not scale from this drawing - Work to figured dimensions only. All dimensions to be checked on site prior to the execution of any work.

For the avoidance of doubt all dimensions are measured to wall structure and not the finishes unless otherwise stated.

Where any discrepancy is found to exist within or between drawings and/or documents it should be reported to the architect immediately.

Majher Architect shall not be liable for any use of drawings and documents for any purpose other than for which the same were prepared by or on behalf of Majher Architect.

Please send corrections and error reports to: monika@majher-architect.com

Notes

-	PLANNING ISSUE	xx/06/24
Revision	Author & Description	Date

MAJHER ARCHITECT

Client
Hallwell Ltd
479 Holloway Road
London N7 6LE

Project
Former Kentish Town
London Underground
Station
141-145 Kentish Town Road
London NW1 8PB

Title
Existing
Sheet 3 of 3

Drawing:	47-08-23 E03		
Date:	xx/06/2024	By:	MM
Scale:	1:100,200@A1	Check:	MM

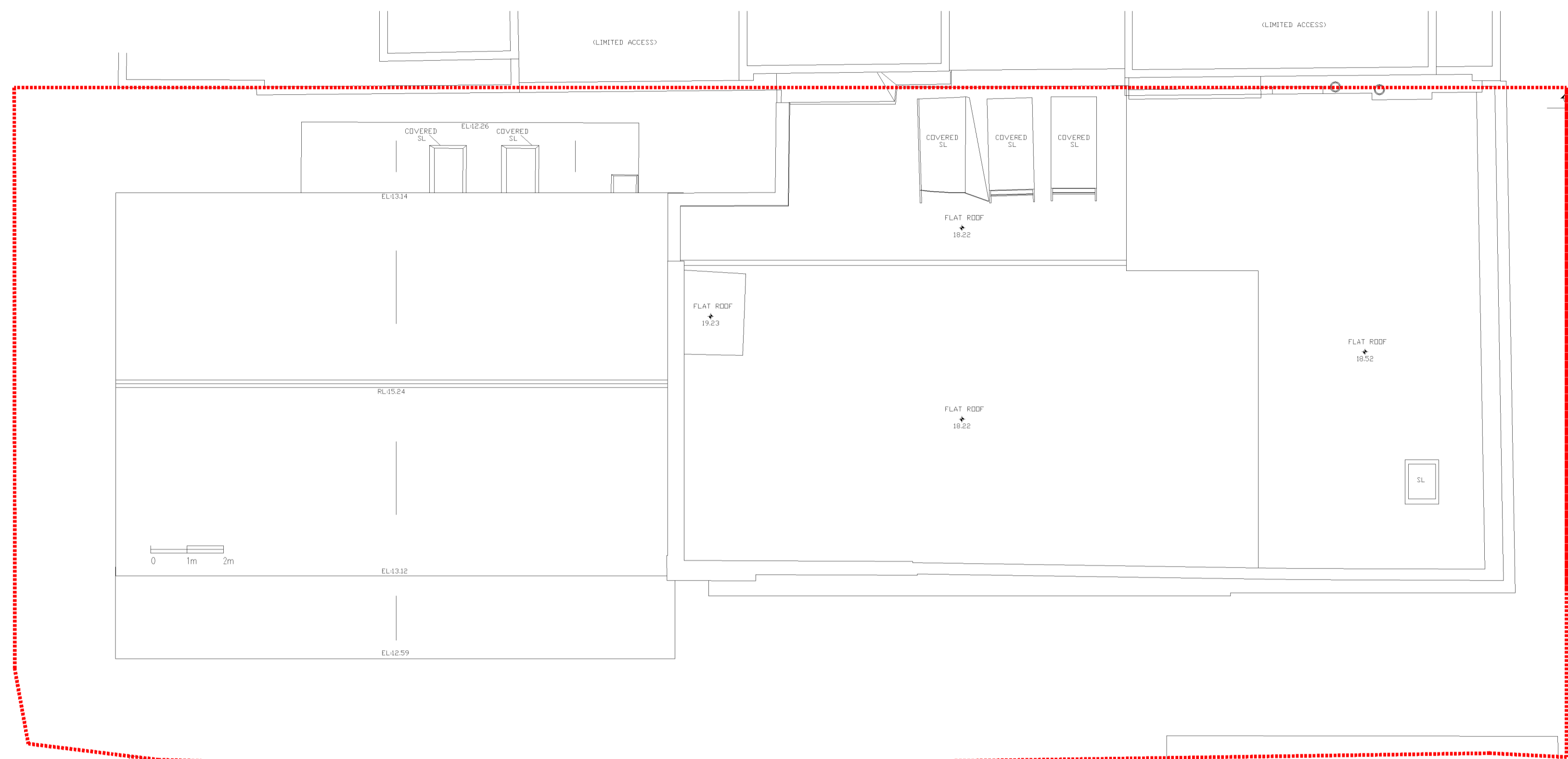

Roof Plan, 1:100

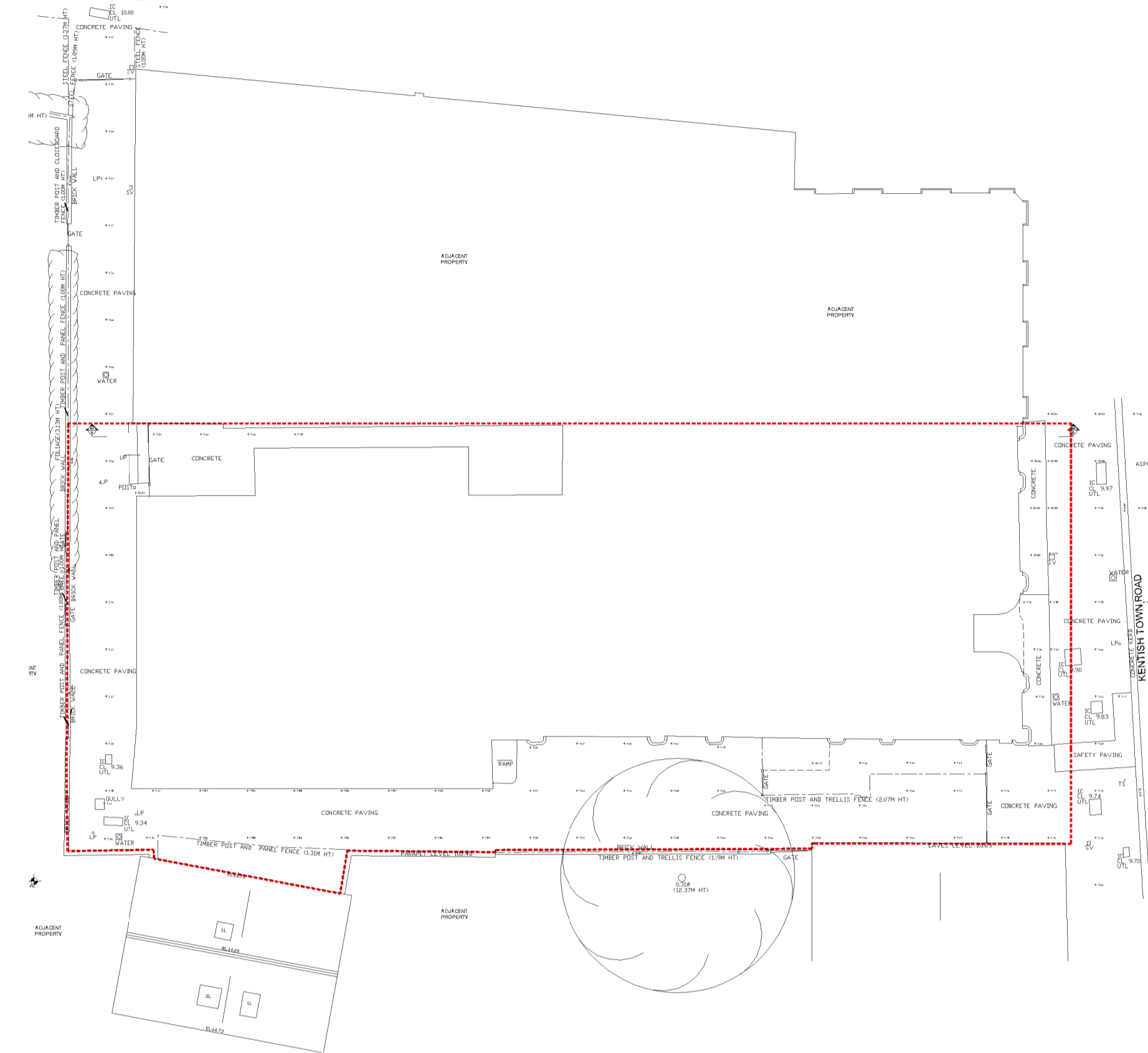

Site Plan, 1:200

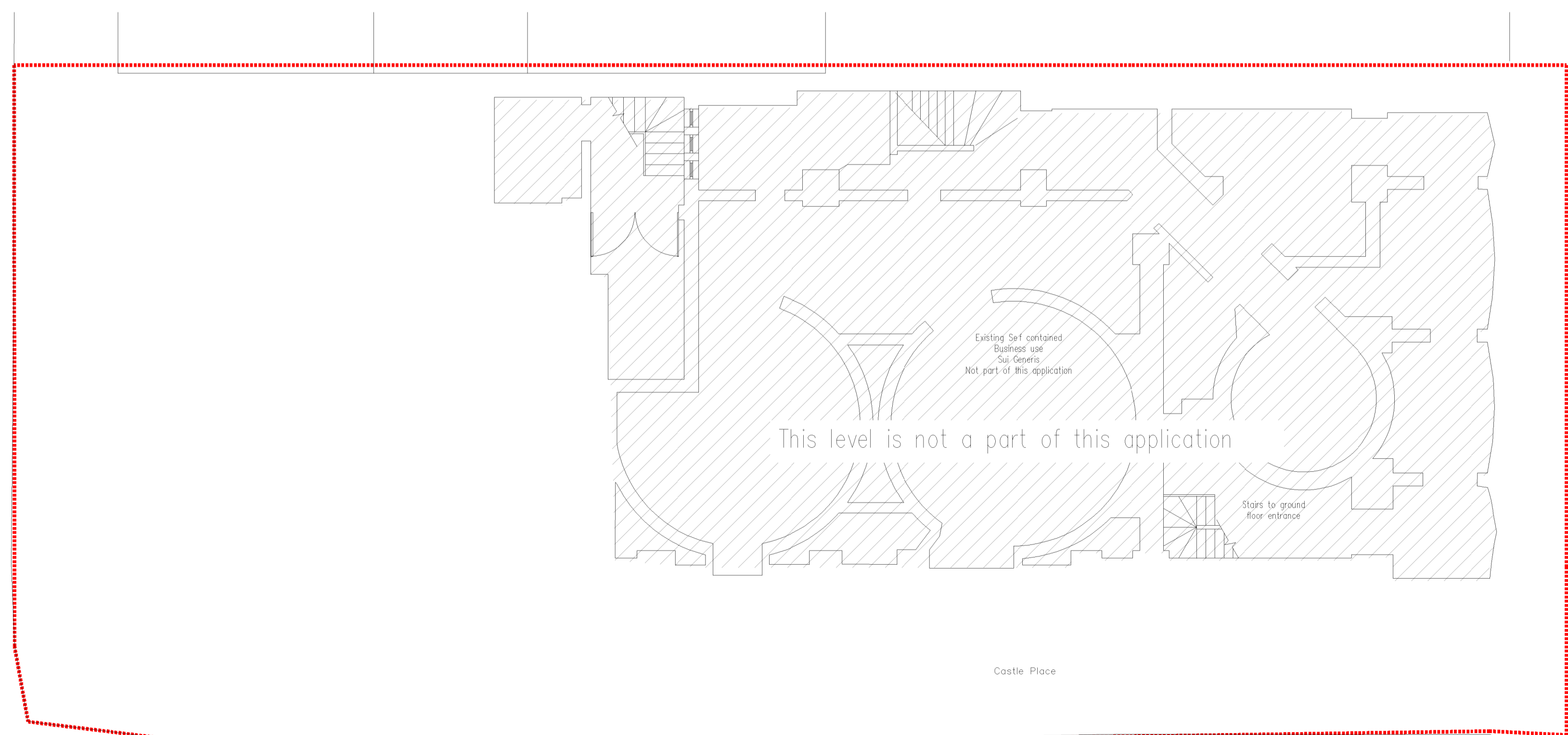

Basement Plan, 1:100