

1 Existing Roof Plan 1:100 @ A1

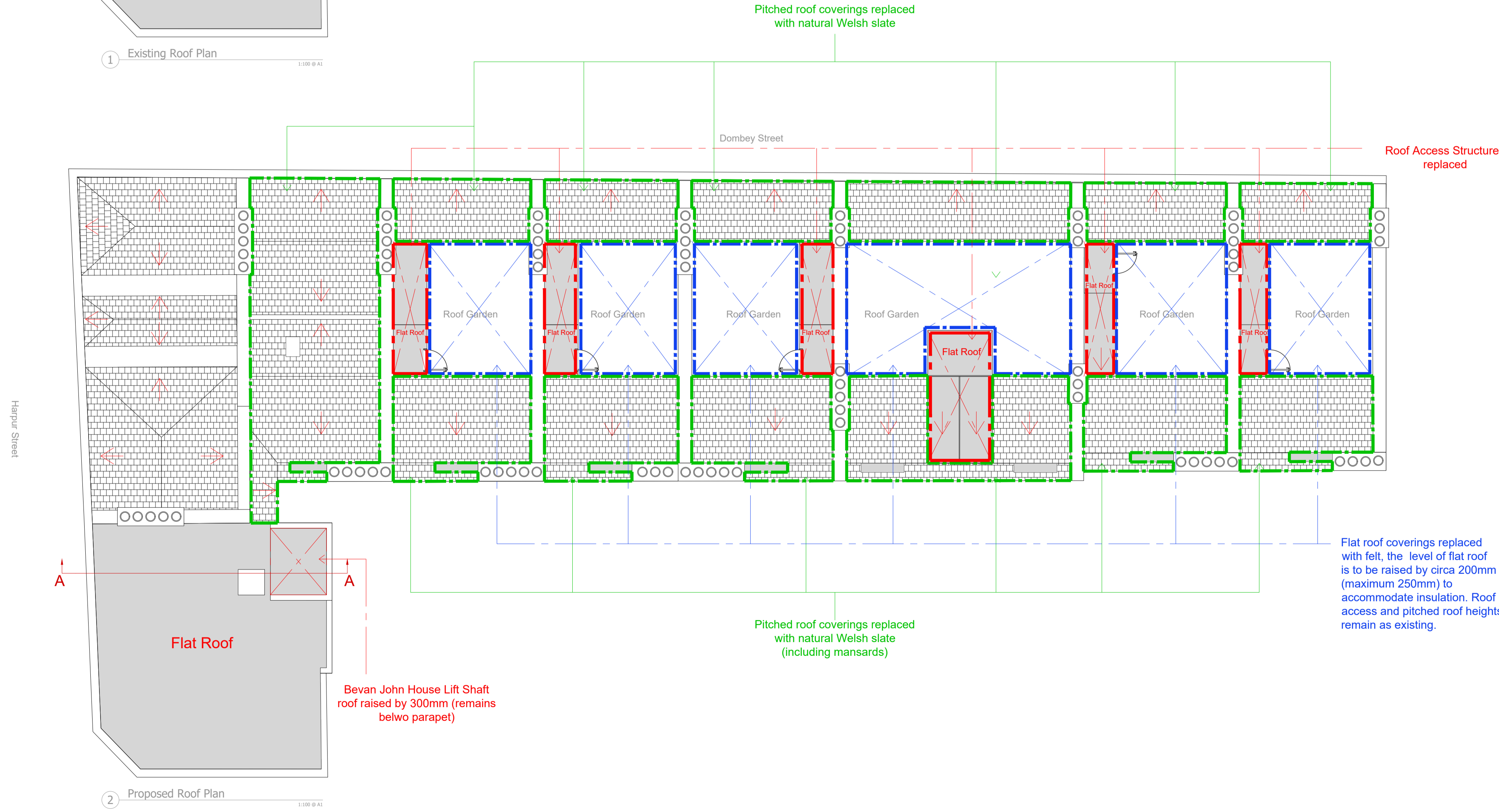

2 Proposed Roof Plan 1:100 @ A1

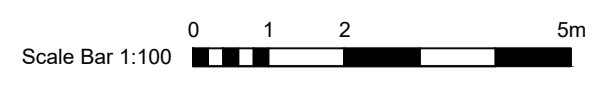

| | | | | | | |
|-----|-----------------------------|----|----|----|----|------|
| Rev | Description | By | DA | DD | MM | YY |
| P4 | Flat Roof Level Height note | JM | AJ | 14 | 08 | 2024 |
| P3 | Lift Section | JM | AJ | 12 | 06 | 2024 |
| P2 | Planning | JM | AJ | 05 | 05 | 2024 |
| P1 | Planning | JM | AJ | 21 | 03 | 2024 |

© This drawing and any design herein is the copyright of Potter Raper and must not be reproduced without their written consent. All drawings remain the property of Potter Raper. Figured dimension only to be taken from this drawing. All dimensions to be checked on site. Please inform Potter Raper immediately of any discrepancies before work proceeds.

| | |
|------------------|--|
| Client | Wates |
| Project Name | Wates Clarion |
| Project Location | Bevan John House Harpur St, Holborn, London WC1N 3PA |
| Sheet Name | Existing & Proposed Roof Plan |
| Project Status | Planning |
| Drawing No. | 10043-PR-BJH-XX-DR-B-PL109 |
| Scale | 1:100 @ A1 |

POTTER RAPER
 Duncan House
 1A Burnhill Road
 Beckenham
 Kent
 BR3 3LA
 Tel: 020 8656 3538