

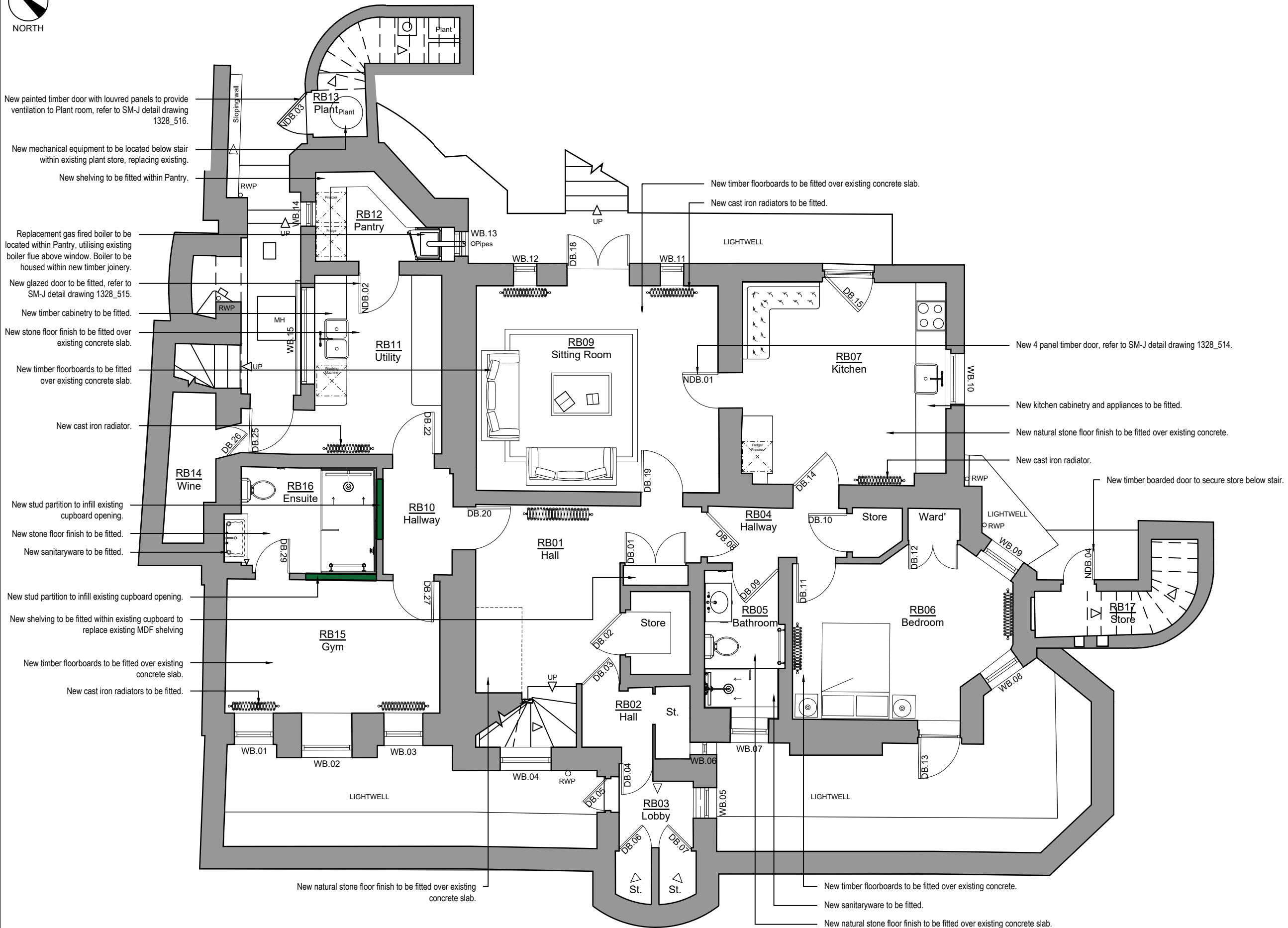

© SIMON MORRAY-JONES. ALL DIMENSIONS TO BE CHECKED ON SITE BEFORE WORK COMMENCES. ANY DISCREPANCIES TO BE REPORTED TO THE ARCHITECT. DO NOT SCALE



P3 - New boiler located within Pantry to replace existing.	13.08.2024
Issued to planning.	
P2 - Issued to Camden Council for Planning.	24.05.2024
E - Discussed with client on site.	26.03.2024
P1 - Issued to Camden Council for Pre-App.	06.09.2023
D - Issued to QS for costing.	25.07.2023
C - Discussed with Client & SE on site.	05.07.2023
B - Staff flat layout altered as per client comments.	29.06.2023
A - Discussed with client on site.	31.05.2023

Revision	Date
----------	------



**SIMON MORRAY-JONES**  
CHARTERED ARCHITECTS & DESIGNERS

21 MILSOM STREET, BATH BA1 1DE  
TEL: 01225 787900 • FAX: 01225 787901  
EMAIL: sm-j@sm-j.com

Client  
**Elisabeth Krohn**

Project  
**10 Park Village West,  
Camden, London  
NW1 4AE**

Drawing Title  
**Proposed Lower Ground Plan**

Scale @ A3 1:75	Drawn By SLK	Date May 2023
Job Number 1328	Drawing Number 105	Revision P3