

PROPOSED BLOCK & SITE PLAN

- EXISTING CYCLE STORES
No change proposed
- EXISTING REFUSE & RECYCLING STORE
No change proposed
- PROPOSED CYCLE STORE
8no. Long Term Secure lockable spaces.

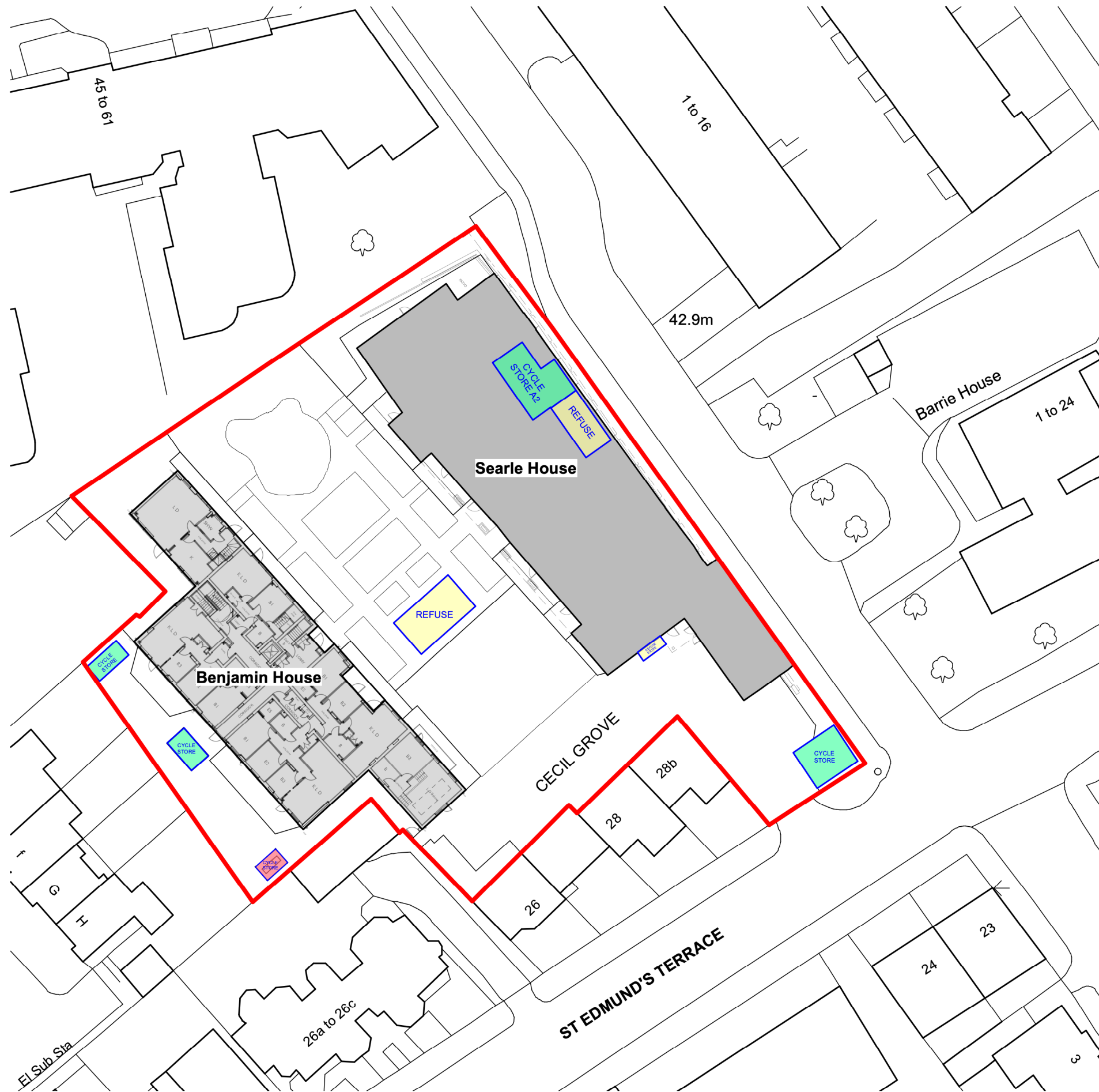

0 15 25 35 M



Unit 25, BASEPOINT
EVESHAM
WORCESTERSHIRE
WR11 1GP
t : 020 7328 2576
Email: info@hubarchitects.co.uk

All dimensions are to be checked on site before commencement of works.
All sizes and dimensions to any structural elements are indicative only. See structural engineer's drawings for actual sizes/dimensions.
Sizes of and dimensions to any service elements are indicative only.
See service engineer's drawings for actual sizes/dimensions.
This drawing to be read in conjunction with all relevant Architect's drawings, specifications and other consultants' information.

Rev.	Date.	Description.
A	Sept'22	General drawing update.
B	Sept'22	General drawing update.
C	Jan '24	General drawing update.

Initial.
JC
JC
JC

PLANNING

Project: Regent's Gate / Guinness Court NW8	Drawing: PROPOSED SITE & BLOCK PLAN
Scale: 1:500 @ A3	DWG: 1323 - PL - 145
Date: JULY 2022	Revision: c