

**NOTES**

- DO NOT SCALE FROM THIS DRAWING.
- THIS DRAWING IS TO BE READ IN CONJUNCTION WITH THE SPECIFICATION AND ALL RELEVANT ARCHITECTURAL, ELECTRICAL, MECHANICAL AND STRUCTURAL DRAWINGS.
- THIS DRAWING SHOWS INDICATIVE ROUTES OF THE PIPEWORK AND LOCATION OF PLANT, FITTINGS AND EQUIPMENT AND IT IS THE CONTRACTORS RESPONSIBILITY TO CO-ORDINATE THE INSTALLATION OF ALL SERVICES WITHIN ALL DISCIPLINES.
- THE CONTRACTOR SHALL FULLY CO-ORDINATE ALL SERVICES ACCESS POSITIONS WITH OTHER TRADES AS REQUIRED.
- THE CONTRACTOR SHALL FULLY CO-ORDINATE ALL SANITARY DRAINAGE SERVICES PIPEWORK AND EQUIPMENT WITH EXISTING SERVICES ALLOWING FOR ADEQUATE ACCESS FOR MAINTENANCE AND/OR REPLACEMENT.
- ACCESS SHALL BE PROVIDED AT THE END OF EACH HORIZONTAL RUN AND EVERY CHANGE OF DIRECTION.
- ACCESS DOOR SHALL BE PROVIDED TO ALL VERTICAL STACKS ON EACH FLOOR 1.2m ABOVE FINISHED FLOOR LEVEL. WHERE STUB STACKS ARE USED THEY SHALL BE PROVIDED WITH FULL BORE TOP ACCESS LOCATED ABOVE THE SPILL OVER LEVEL OF THE TOP MOST FITTING.
- FALLS ON SOIL AND WASTE PIPE AND VENT PIPES SHALL NOT FALL BELOW THE MINIMUM STATED IN BS EN 12056 - 2 GRAVITY DRAINAGE INSIDE BUILDINGS.

**NOTES**

- WHERE CONDENSATE WASTE PIPEWORK CONNECTS TO SOIL STACKS THE USE OF WATERLESS TRAPS SUCH AS HEPWORTHS "HEPVO" SHALL BE USED.
- SWEPT LONG OR MEDIUM RADIUS 90° OR 45° BENDS SHALL BE USED. WHENEVER POSSIBLE ALL JUNCTIONS SHALL BE 45°. THE USE OF KNUCKLE BENDS WILL NOT BE PERMITTED.
- THE PUBLIC HEALTH SERVICES SANITARY DRAINAGE DESIGN AND INSTALLATION SHALL BE IN STRICT ACCORDANCE WITH BS. EN. 12056-2 AND BUILDING REGULATIONS APPROVED DOCUMENT H.
- INTERNAL VERTICAL AND HORIZONTAL SOIL & WASTE STACKS AND STUB STACKS SHALL BE LIGHT WEIGHT CAST IRON WITH MECHANICAL JOINTS TO BS EN 877 AND BRANCH WASTE PIPEWORK SHALL BE UPVC AND MUPVC.
- ALL CONCEALED RAINWATER AND SOIL AND VENT PIPEWORK THAT ARE INSTALLED HORIZONTALLY AND VERTICALLY WITHIN DUCTS, CEILING AND FLOOR VOIDS SHALL BE ACOUSTICALLY INSULATED WITH 1 LAYER OF LAGGING AS MANUFACTURED BY MUTILAG TYPE SP29 & 5B/10 OR EQUAL AND APPROVED. THE PIPEWORK SHALL THEN BE PROVIDED WITH A INSULATION WRAP WITH VAPOUR SEAL.

**LEGEND**

- SVP - SOIL VENT PIPE.
- VP - VENT PIPE.
- G - GULLY.
- SHG - SHOWER FLOOR GULLY.
- RWP - RAINWATER PIPE.
- RWO - RAINWATER OUTLET.
- F/A - FROM ABOVE.
- T/B - TO BELOW.
- AAV - AIR ADMITTANCE VALVE.
- H/L - HIGH LEVEL.
- M/L - MEDIUM LEVEL.
- L/L - LOW LEVEL.
- SS - STUB STACK/STUB WASTE PIPE.
- CTD - CONNECT TO UNDERGROUND DRAIN.
- CI - CAST IRON.
- WC - WATER CLOSET.
- PIPEWORK AT L/L & M/L.
- - - PIPEWORK AT H/L.
- PIPEWORK IN FLOOR VOIDS.

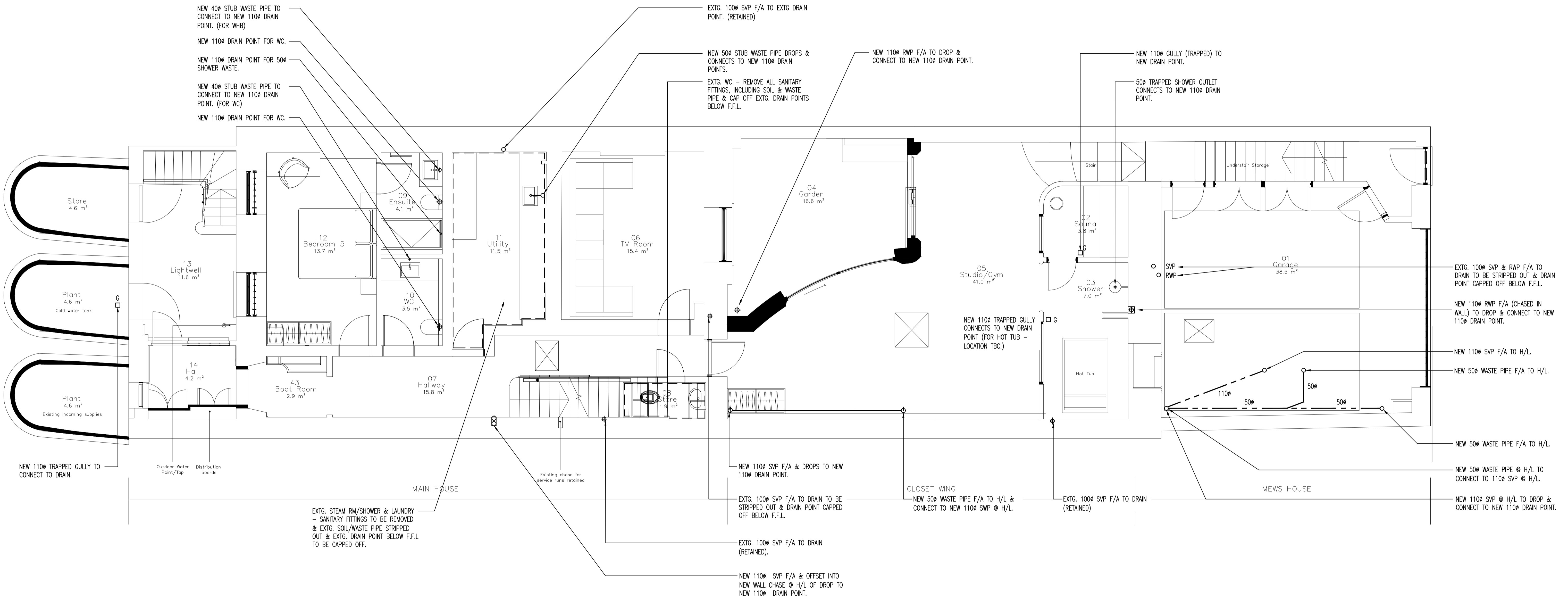

Revisions				
Rev.	Date	Description	CDM Chk'd	Chk'd
P1	AUG.24	PRELIMINARY ISSUE FOR COMMENT.	J.B	P.B

Revisions				
Rev.	Date	Description	CDM Chk'd	Chk'd

Revisions				
Rev.	Date	Description	CDM Chk'd	Chk'd

Project Consultants	
Architect	Quantity Surveyor
Structural Engineer	Project Manager

CAD Ref. 3271	Originator SLENDER WINTER PARTNERSHIP LIMITED
Checked Date J.B JUL.24	Client
Drawn Date G.H JUL.24	Project 8 GLOUCESTER GATE
Scale 1:50@A1	Drawing Title LOWER GROUND FLOOR ABOVE GROUND DRAINAGE SERVICES LAYOUT
Revision P1	Drawing Number 3271-PH100

**swp ltd**  
**consulting engineers**  
 ISO 14001 REGISTERED FIRM  
 ace  
 Head Office: 2 Kings Hill Avenue, Kings Hill, West Malling, Kent, ME19 4AQ  
 T: 01959 564777 E: swp@swpltd.co.uk

SWP Limited, Registered Office: 2 Kings Hill Avenue, West Malling, Kent, ME19 4AQ, Registered in England No 3735841

THIS DRAWING IS THE COPYRIGHT OF SLENDER WINTER PARTNERSHIP LIMITED AND IS NOT TO BE REPRODUCED OR TRANSMITTED IN ANY FORM OR BY ANY MEANS, ELECTRONIC OR MECHANICAL, WITHOUT PERMISSION IN WRITING FROM SLENDER WINTER PARTNERSHIP LIMITED. THE COPYRIGHT DESIGN & PATENTS ACT 1988. DO NOT SCALE. ALL DIMENSIONS TO BE CHECKED ON SITE.