

Note: Final design intent is subject to planning conditions approval.

**Alexandra Wing Entrance\_West Elevation, Gray's Inn Road**  
1 : 25

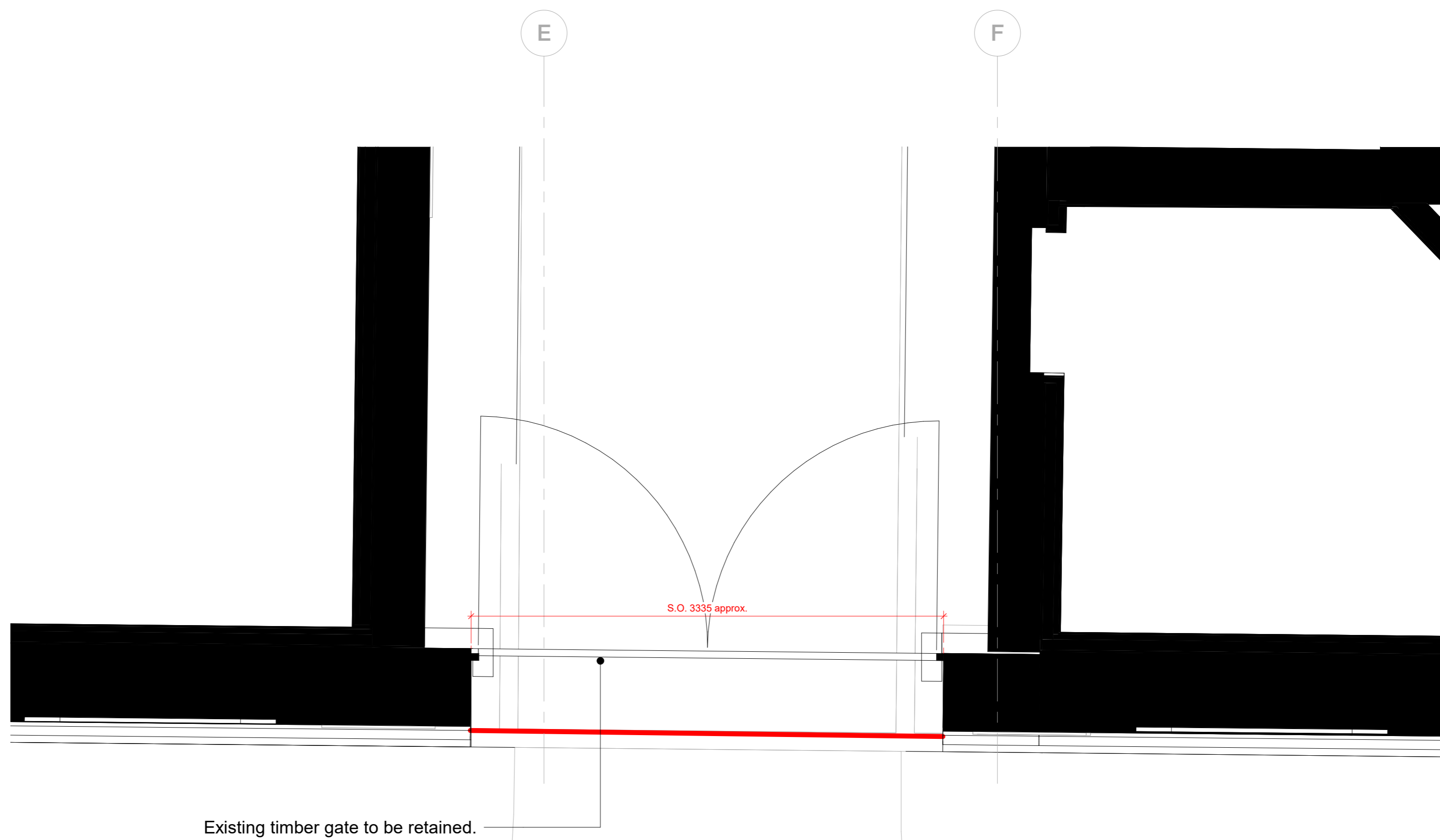

**Alexandra Wing Entrance Proposed Plan\_Level 00**  
1 : 25

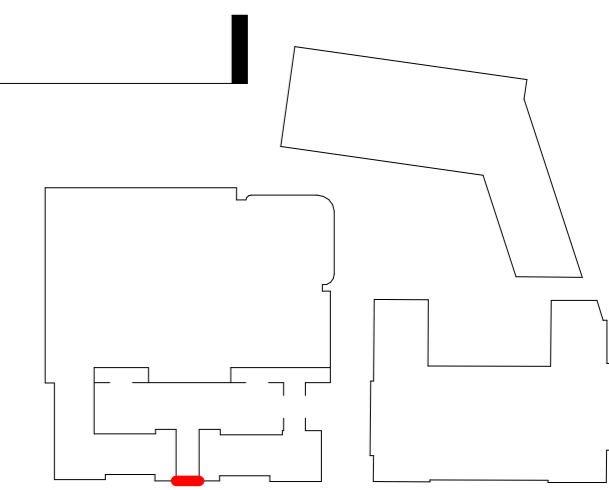

Rev	Description	Date	Scale @ A1	Date	Job Number	Project	159 St John Street London EC1V 4QJ	mail@hawkinsbrown.com hawkinsbrown.com
P01	Planning Issue (Condition 19)	21/06/24	As indicated	21/06/24	17056	IoN/DRI Redevelopment Project 256 Grays Inn Road London WC1X 8LD		
Copyright Hawkins\Brown Architects No implied licence exists. This drawing should not be used to calculate areas for the purposes of valuation. Do not scale this drawing. All dimensions to be checked on the site by the contractor and such dimensions to be their responsibility. All work must comply with relevant British Standards and Building Regulations requirements. Drawing errors and omissions to be reported to the architect. To be read in conjunction with Architect's specification and other consultant information.			Drawn By	Checked By	Status S2			
<b>PLANNING CONDITION DRAWING</b>			Drawing No. BEMP-HBA-AW-00-DR-A-34-0606	Rev P01	Purpose of Issue Planning	Drawing External Gate Details - Alexandra Wing Entrance Gate Design	<b>Hawkins\ Brown</b>	