

Proposed rear elevation

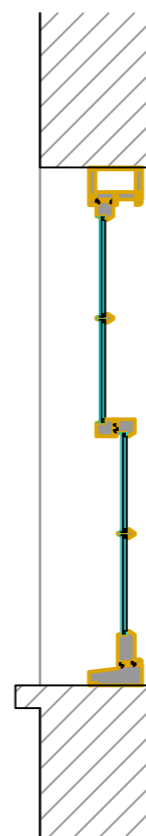

Sash window detail

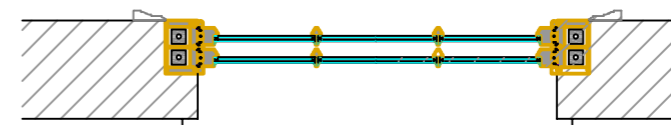

Horizontal Sash window detail cross section @ 1:20

Notes:

Sash window to be glazed in clear Timbalite 4/4/4 or 4/6/4 low E Krypton gas filled double glazed units with white spacer bars. Glazed units can putty faced or timber beaded.

All timber to be Accoya/Hardwood

Paint finish: White as standard - factory spray applied microporous Choice of colour, dual colour, colour match or stain

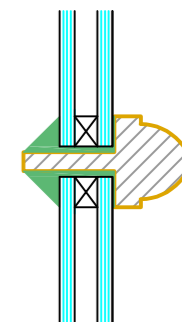

Glazing bar cross section @ 1:2

REV	DATE	DESCRIPTION
B	31.07.24	SASH WINDOW DETAIL AMENDMENTS AS TO LOCAL AUTHORITIES REQUEST
A	24.06.24	SASH WINDOW DETAIL ADDED
.	15.08.23	FIRST ISSUE

CLIENT	PROJECT
PLANNING SOLUTIONS LONDON LTD	FRENCH DOOR RENEWAL

LOCATION	ADDRESS
LONDON	11 HOLLY MOUNT LONDON NW3 6SG

DRAWING NO.	REVISION	DESCRIPTION
365-02	B	PROPOSED ELEVATION AND CROSS SECTION WINDOW DETAIL

DRAWN BY	DATE	CHECKED BY
AC	15.08.23	JW

SCALE	CAD REF.	ISSUE STATUS
1:50MM @ A3	.	CLIENT / LA APPROVAL

THIS DRAWING AND ITS DATA IS THE PROPERTY OF PLANNING SOLUTIONS LTD, & SHALL NOT BE REPRODUCED WITHOUT THE COMPANY'S CONSENT. DO NOT SCALE. WRITTEN DIMENSIONS TAKE PRECEDENCE. ANY DISCREPANCIES SHOULD BE REPORTED TO PLANNING SOLUTIONS LTD IMMEDIATELY - IF IN DOUBT ASK.

PLANNING SOLUTIONS (LONDON) LTD
T. 00 44 (0)20 7731 2896
wrightjonathan937@gmail.com