

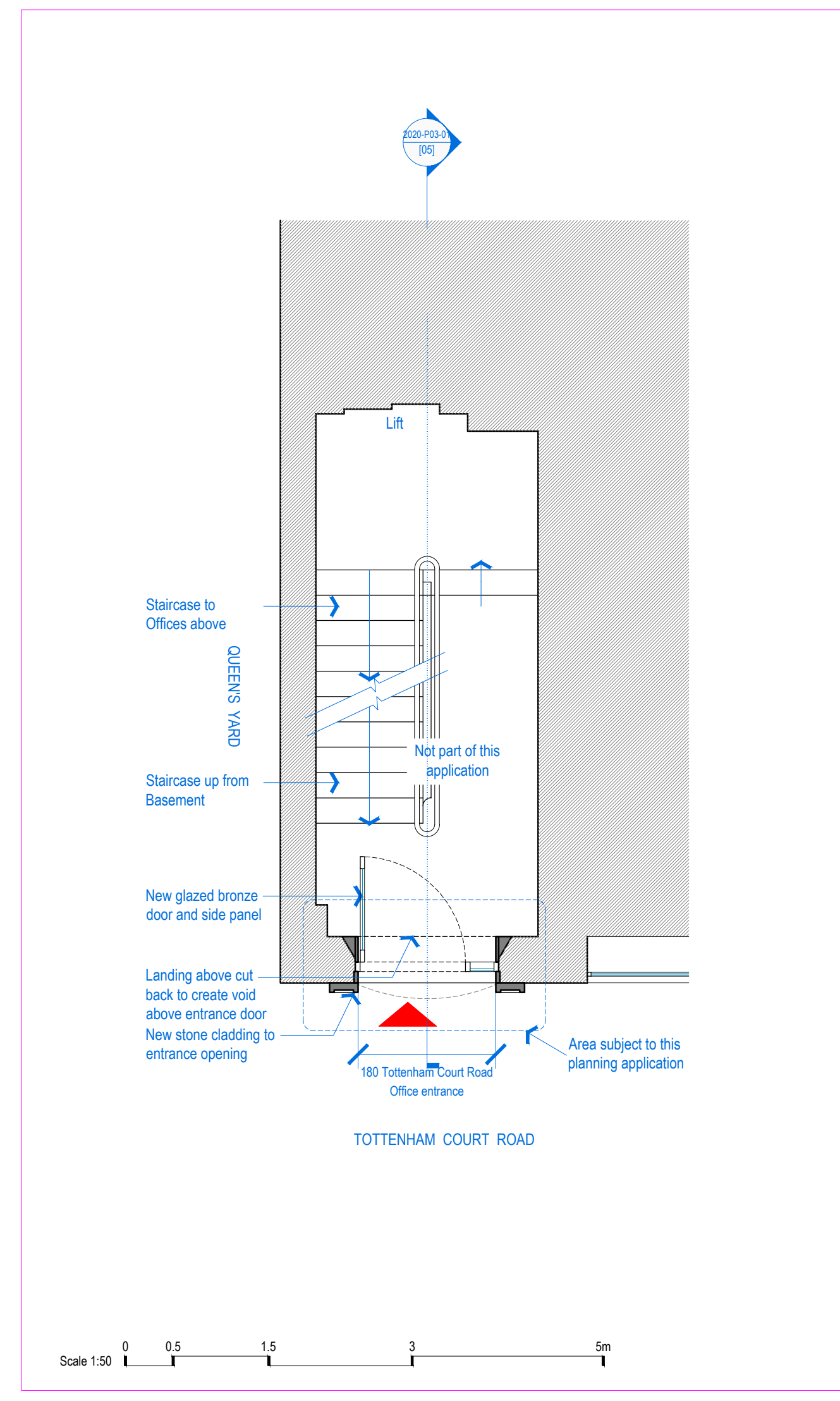

[01] PROPOSED FRONT STREET ELEVATION 1:100

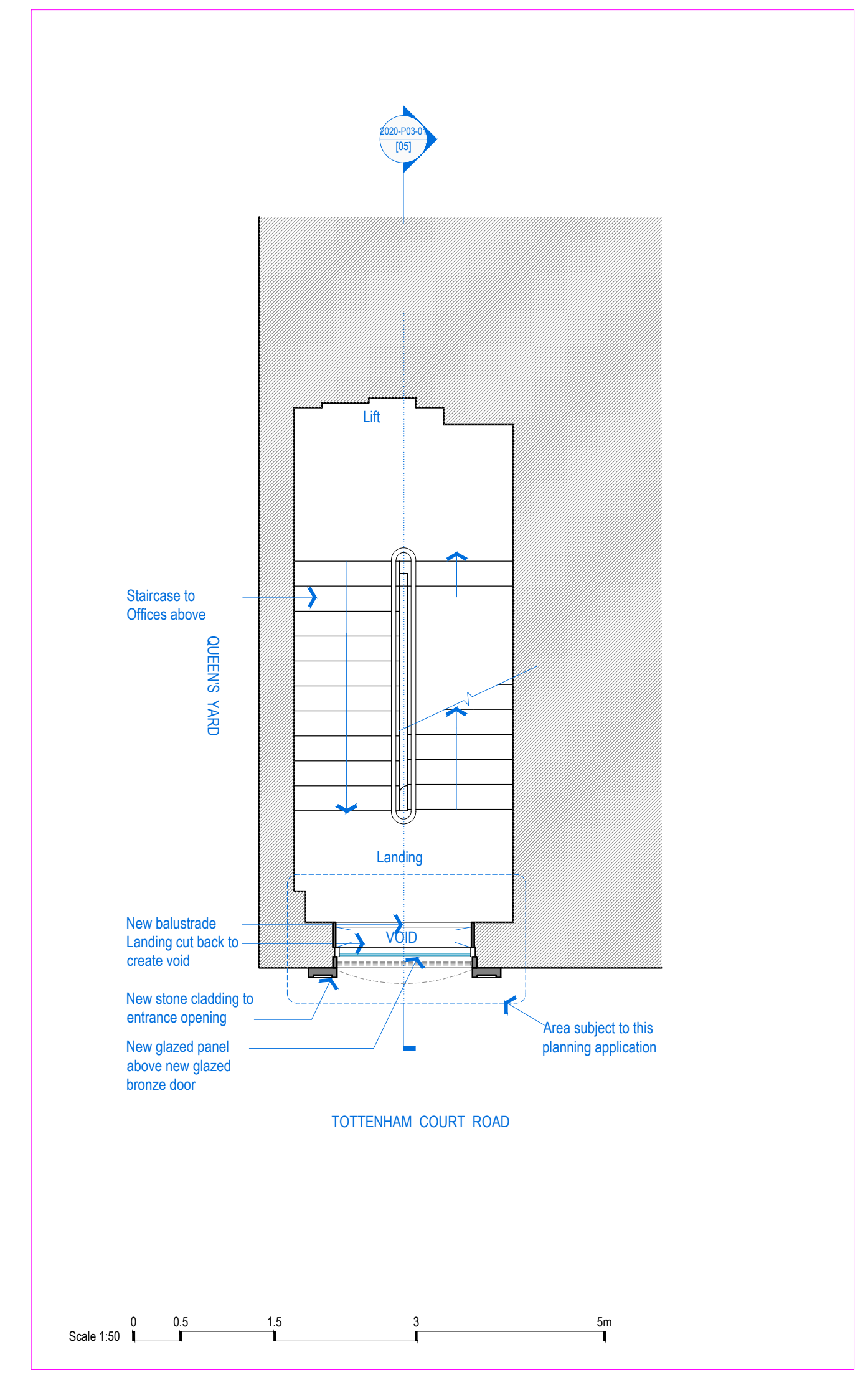

[02] PROPOSED GROUND FLOOR PLAN 1:50



[03] PROPOSED HALF LANDING PLAN 1:50



[04] PROPOSED FRONT ELEVATION 1:50

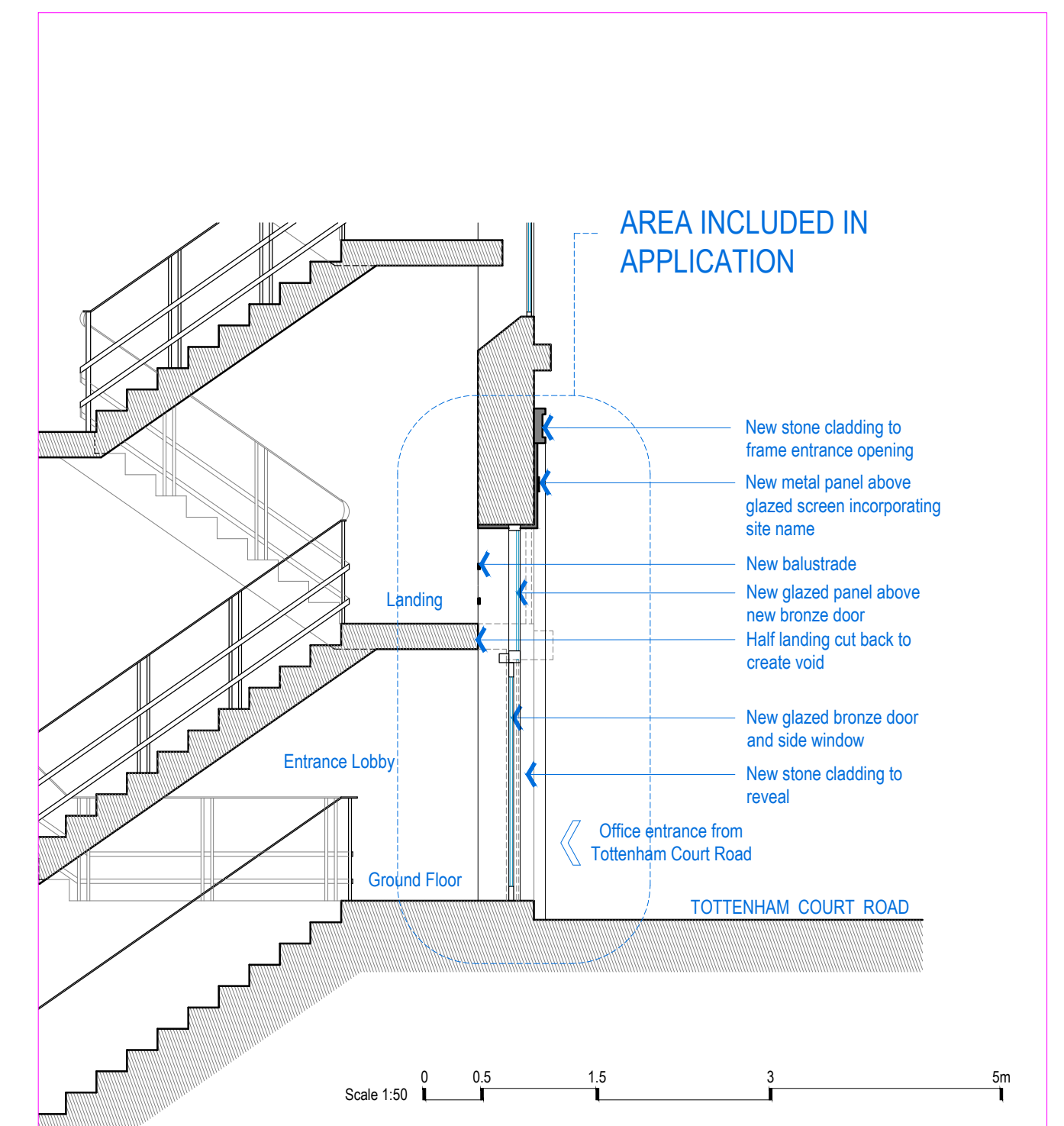

[05] PROPOSED SECTION 1:50

NOTE:  
DO NOT SCALE FROM DRAWINGS - EXCEPT FOR PLANNING PURPOSES.  
ALL DISCREPANCIES TO BE REPORTED TO ARCHITECT IMMEDIATELY.  
ALL DIMENSIONS TO BE VERIFIED BY CONTRACTOR ON SITE PRIOR TO THE COMMENCEMENT OF ANY WORKS.

P1 30/07/24 Issued for Planning

**VIVENDI ARCHITECTS LTD**  
Unit 3, 37 High Street, London, N14 6LD  
Tel/Fax +44 (0)20 3232 4000  
email: info@vivendichitects.com

CLIENT:  
**Lazari Properties 1 Ltd**

DRAWN:  
RG  
CHECKED:  
CK  
SCALE AT A1:  
1:100&50  
P1  
JOB AND DRAWING NO:  
2020-P03-01

PROJECT TITLE:  
**180 Tottenham Court Road, London W1T 7PD**  
DRAWING TITLE:  
**Proposed Ground Floor Plan, Front Elevation and Section**

STATUS:  
**PLA**