

KEY PLAN

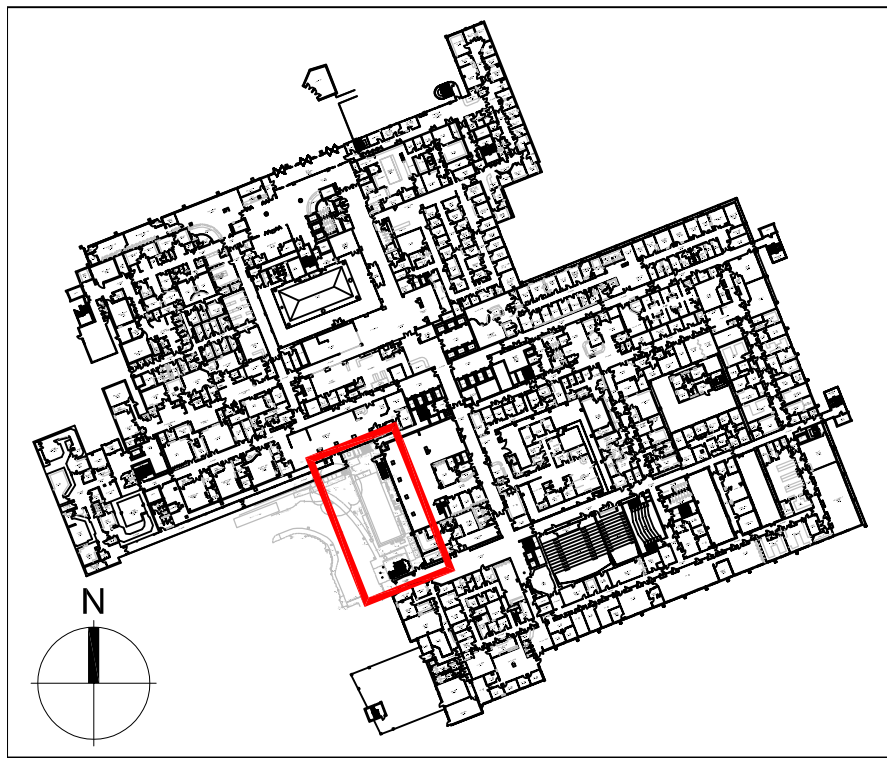

THIS DRAWING IS PROTECTED BY COPYRIGHT - FIGURED DIMENSIONS ONLY TO BE TAKEN FROM THIS DRAWING. DIMENSIONS TO BE CHECKED ON SITE AND ANY DISCREPANCIES REPORTED TO THE ARCHITECT IMMEDIATELY.

PURPOSE OF ISSUE: (I)Info/Comment (S)Sign Off (P)Planning (B)Building Control (T)Tender (C)Construction (F)Final Revision

| Rev | Rev Date | Revision Description | Drawn/Checked | Purpose of Issue |
|-----|------------|----------------------|---------------|------------------|
| / | 12/07/2024 | Planning issue | FY | P |

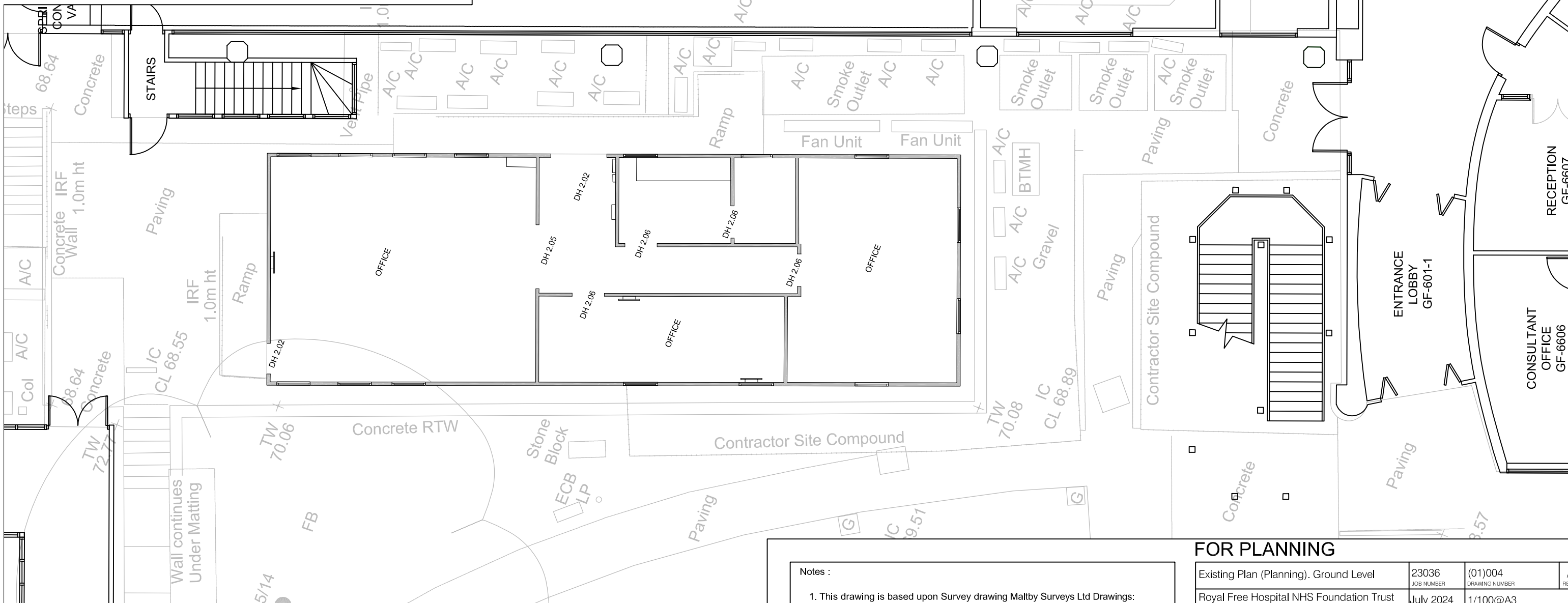
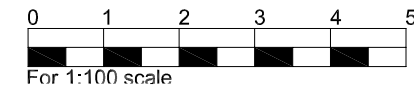

01 Existing Plan (Planning)
 (01)004 1:100 @ A3

Notes :

1. This drawing is based upon Survey drawing Maltby Surveys Ltd Drawings: 23253-100, 23253-200 & 23253-300 dated October 2023
2. All levels refer to FFL levels
3. This drawing is to be read in conjunction with the following - Str Eng drawings and M&E drawings

FOR PLANNING

| | | | |
|--|-----------|----------|-----|
| Existing Plan (Planning). Ground Level | 23036 | (01)004 | / |
| Royal Free Hospital NHS Foundation Trust CRF NIHR | JULY 2024 | 1/100@A3 | REV |
| | DATE | SCALE | |

Ansell & Bailey Ltd Chartered Architects 99-101 Farringdon Road London EC1R 3BN 020 7387 0141 architects@ansellandbailey.com

ANSELL + BAILEY