

All dimensions to be verified on site by Main Contractor before the start of any shop drawings or work whatsoever either on their own behalf or that of sub-contractors.
 Report any discrepancies to the Contract Administrator at once.
 This drawing is to be read with all relevant Architect's and Engineer's drawings and other relevant information.
 © Ingleton Wood LLP

LEGEND: DO NOT SCALE

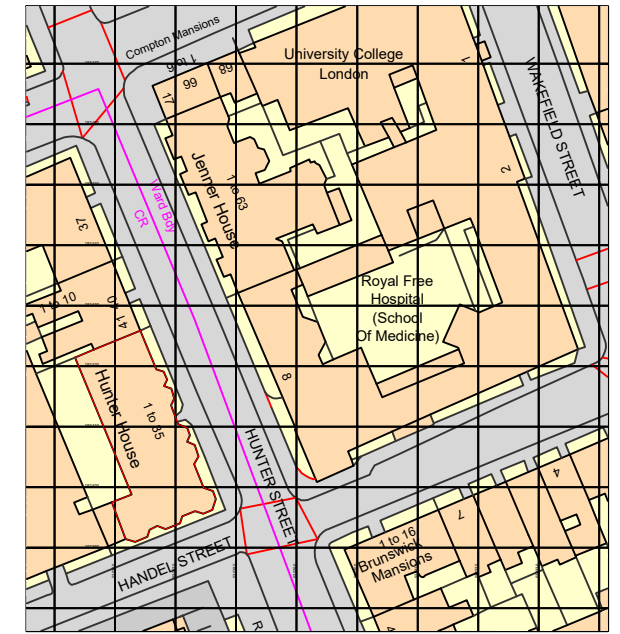

OS PLAN
SCALE 1:1250

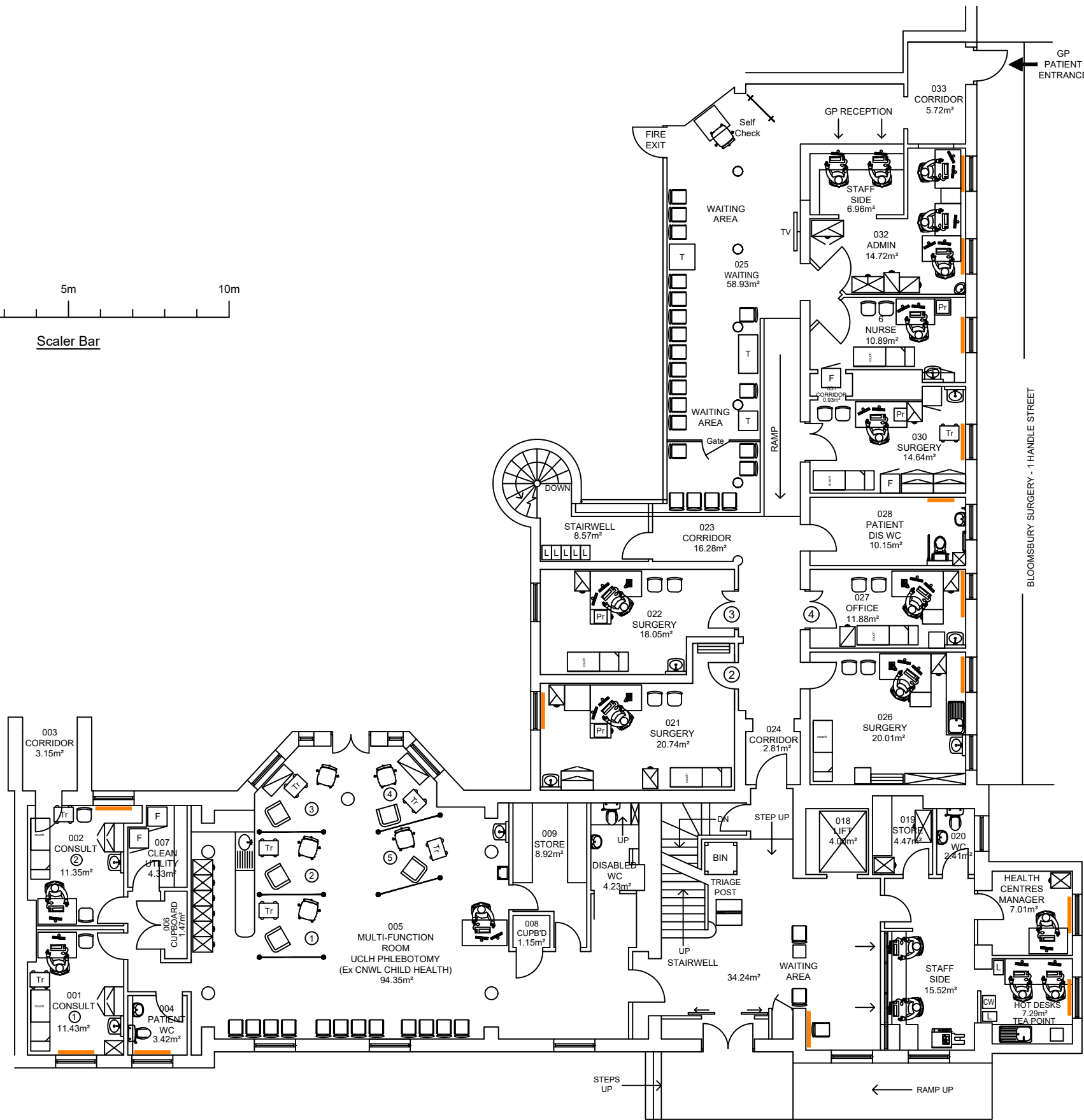
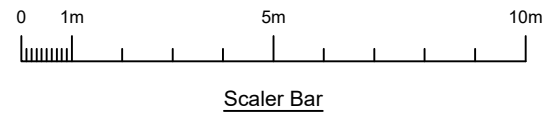

NHS
 North Central London
 Integrated Care Board
 Central and North West London
 NHS Foundation Trust

C	29.08.23	Waiting area updated	LAR	TP
B	19.06.23	Updated following site visit with MM on 09.06.23	LAR	TP
A	14.07.20	OS Plan added	LAR	TP

Revision: Date: Description: Dwg: Chk:

Ingleton Wood
 Vision, form and function
 London
 Billericay
 Cambridge
 Colchester
 Norwich
 Oxford
 London
 10-12 Alle Street
 London E1 8QE
 1:020 7480 4400
 www.ingletonwood.co.uk

Project:
 HUNTER STREET HEALTH CENTRE
 HUNTER STREET

Drawing Title:
 EXISTING GROUND FLOOR PLAN

Client:
 NHS PROPERTY SERVICES LTD / CAMDEN CCG

Drawn:	Checked:	Date:	Scale:	Paper Size:
LAR	TP	07.07.20	1:150	A3
Job No.:	Dwg No.:	Stage:	Revision:	
812679	02		C	