

All dimensions to be verified on site by Main Contractor before the start of any shop drawings or work whatsoever either on their own behalf or that of sub-contractors.

Report any discrepancies to the Contract Administrator at once.

This drawing is to be read with all relevant Architect's and Engineer's drawings and other relevant information.

© Ingleton Wood LLP

LEGEND: DO NOT SCALE

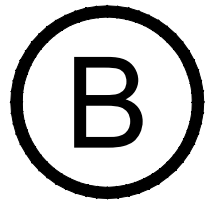
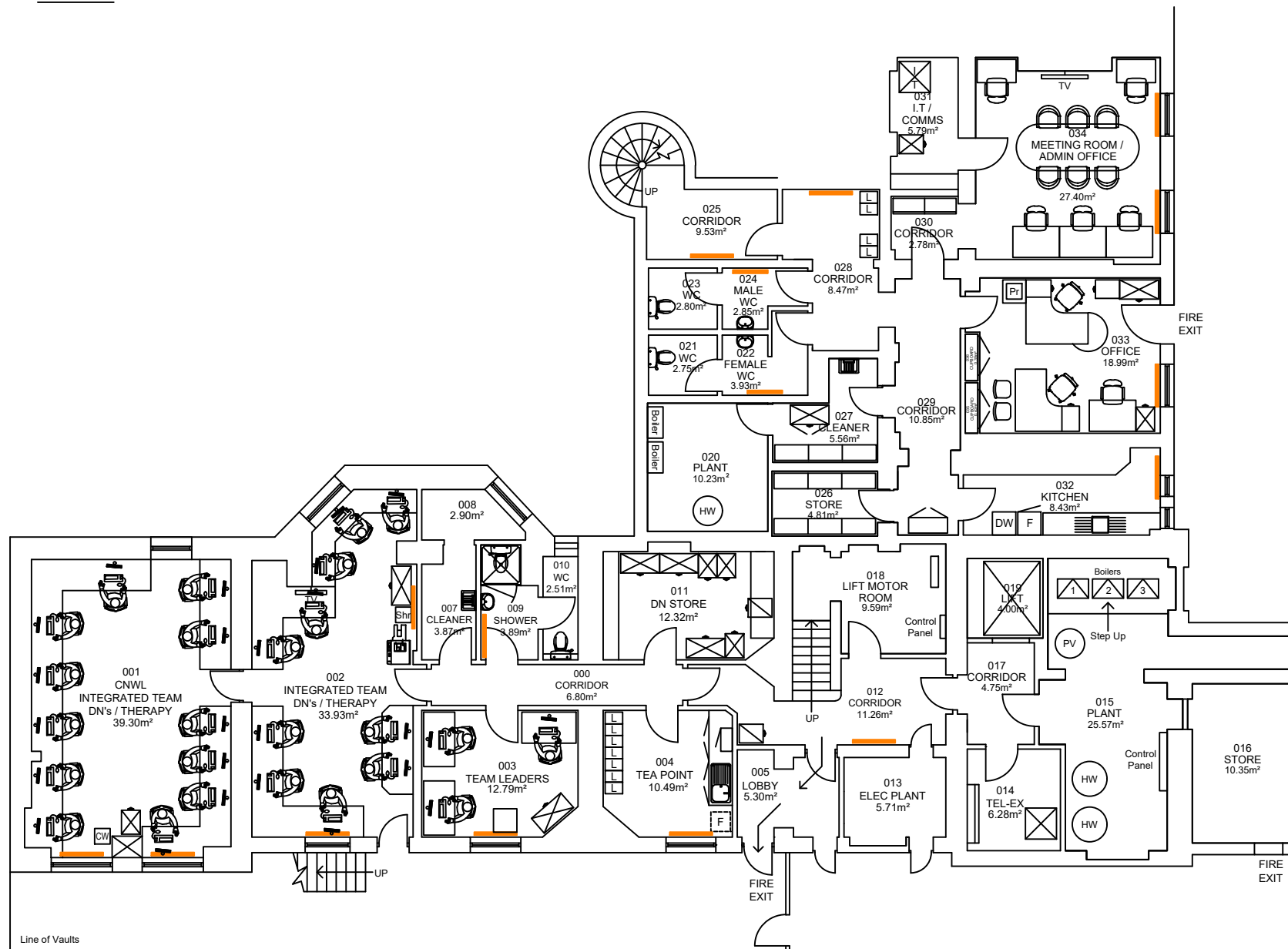
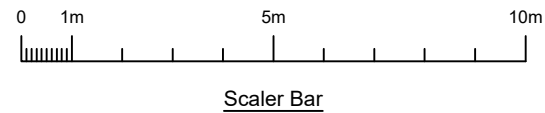

B	23.10.23	Detail added to Main Plant Room areas	LAR	TP
A	19.06.23	Updated following site visit with MM on 09.06.23	LAR	TP
Revision:	Date:	Description:	Dwg:	Chk:

**Ingleton Wood** Vision, form and function

London  
Billerica  
Cambridge  
Colchester  
Norwich  
Oxford

London  
10-12 Alle Street  
London E1 8QE  
1:020 7480 4400

www.ingletonwood.co.uk

Project:  
**HUNTER STREET HEALTH CENTRE  
HUNTER STREET**

Drawing Title:  
**EXISTING BASEMENT PLAN**

Client:  
**NHS PROPERTY SERVICES LTD / CAMDEN CCG**

Drawn:	Checked:	Date:	Scale:	Paper Size:
LAR	TP	07.07.20	1:150	A3
Job No.:	Dwg No.:	Stage:	Revision:	
812679	01		B	